



PROFAK

ARC GOUGING TORCH AEC4000-1/AEC4500-1

Standard features

- 15° Torch head
- Special high impact, heat resistant material
- Special copper alloy forged body
- Unique valve design for easy field repair
- 7' 360° swivel cable assembly
- Optional 12' swivel cable assembly available
- Made in the USA

STANDARD TORCH

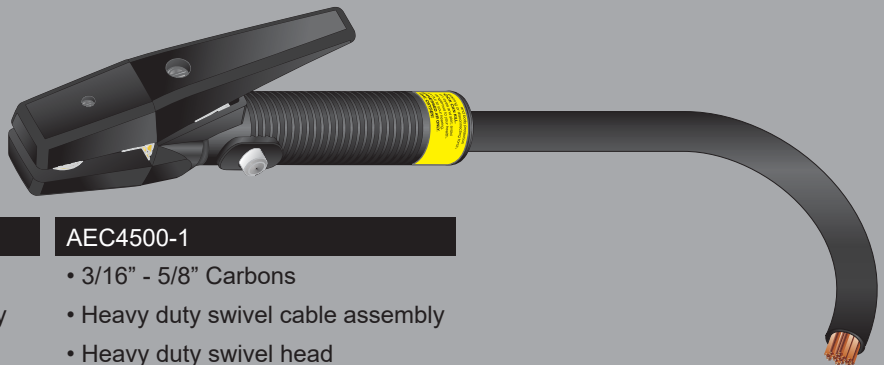

AEC4000-1

- 5/32" - 1/2" Carbons
- Standard swivel cable assembly
- Standard swivel head

AEC4500-1

- 3/16" - 5/8" Carbons
- Heavy duty swivel cable assembly
- Heavy duty swivel head

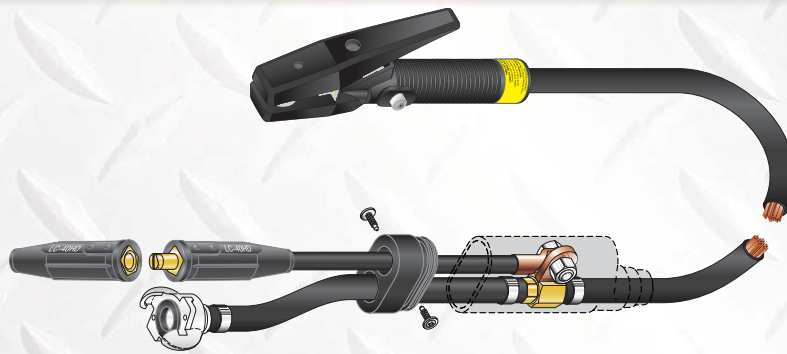
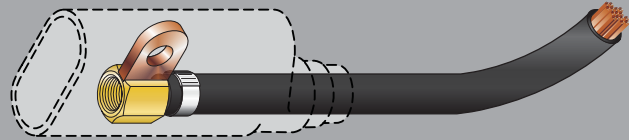

TORCH WITH AEC3-045CF INSULATION KIT INSTALLED

Part No.	Description	DC AMPS						
		5/32"	3/16"	1/4"	5/16"	3/8"	1/2"	5/8"
AEC4000-1	Complete gouging torch w/ 7' swivel cable assembly							
AEC4000-1-045CF	Complete gouging torch w/ 7' swivel cable assy w/ insulation kit installed	90 to 150	200 to 250	300 to 400	350 to 450	450 to 600	800 to 1000	
AEC4000-12-1	Complete gouging torch 12' swivel cable assembly							-
AEC4000-12-1-045CF	Complete gouging torch w/ 12' swivel cable assy w/ insulation kit installed							
AEC4001	Complete gouging torch less cable assembly							
AEC4500-1	Complete gouging torch w/ 7' swivel cable assembly							
AEC4500-1-045CF	Complete gouging torch w/ 7' swivel cable assy w/ insulation kit installed		200 to 250	300 to 400	350 to 450	450 to 600	800 to 1000	1000 to 1250
AEC4500-12-1	Complete gouging torch 12' swivel cable assembly	-						
AEC4500-12-1-045CF	Complete gouging torch w/ 12' swivel cable assy w/ insulation kit installed							
AEC4501	Complete gouging torch less cable assembly							



INDEPENDENT WHOLESALE WELDING SUPPLY

Ph: 02 8834 2400 Fax: 02 8834 2498 Email: iwws@iwws.net Website: www.iwws.net

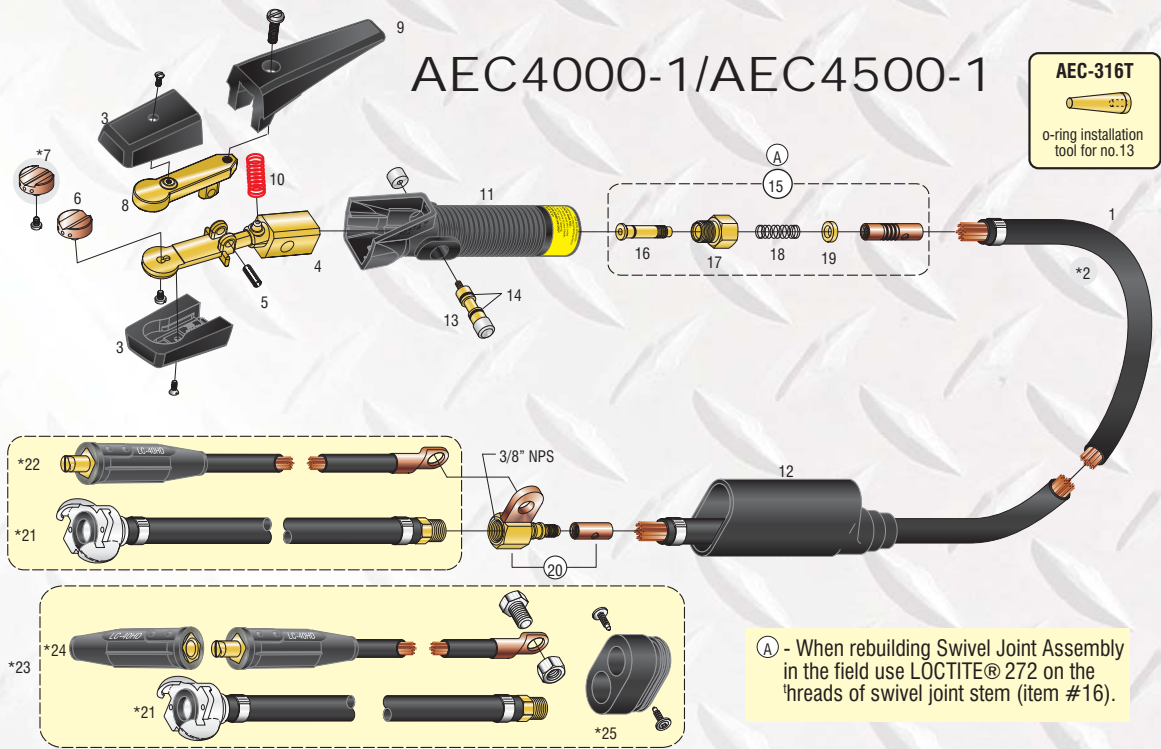

Air pressure psi (kPa)	Air consumption cfm (L/min.)	Continuous use hp (kW)
80 (550)	25 (708)	7.5 (5.6)

ITEM	DESCRIPTION	AEC4000-1	AEC4500-1
1	Swivel cable assembly 7'	AEC302-1	AEC502-1
*2	Swivel cable assembly 12'	AEC312-1	AEC512-1
3	Insulator assembly with screws	AEC403	AEC403
4	Lower tong and valve body	AEC404	AEC454
5	Pin	AEC410	AEC410
6	Swivel head with screw	AEC305	AEC505
*7	Flat swivel head with screw	AEC305F	AEC505F
8	Upper arm	AEC407	AEC407
9	Lever assembly with screw	AEC408	AEC408
10	Spring	AEC409	AEC409
11	Handle	AEC450	AEC450
12	Cable insulating boot	AEC311	AEC511
13	Spool assembly	AEC316R	AEC316R
14	O'ring (2 pk)	AEC316-1R	AEC316-1R
15	Swivel joint assembly	AEC321	AEC521
16	Swivel joint stem	AEC322	AEC522
17	Swivel joint male nut	AEC323	AEC523
18	Swivel joint spring	AEC326	AEC526
19	Swivel joint bushing	AEC327	AEC527
20	Female cable connector	AEC3-029	AEC5-029
*21	Air hose extension 18' long with crow foot connection	AEC3-040	AEC3-040
*22	Power cable extension 3/0 cable 18" long with LC-40HD male	AEC3-041TW	AEC3-041TW
*23	Power/Air insulation kit	AEC3-045CF	AEC3-045CF
*24	Power cable extension 3/0 18" long cable with LC-40HD male & LC-40HD female	AEC3-042	AEC3-042
*25	Insulating block	AEC312	AEC312

* Items are optional

