

# BINZEL STYLE 501

## MIG GUN BREAKDOWN

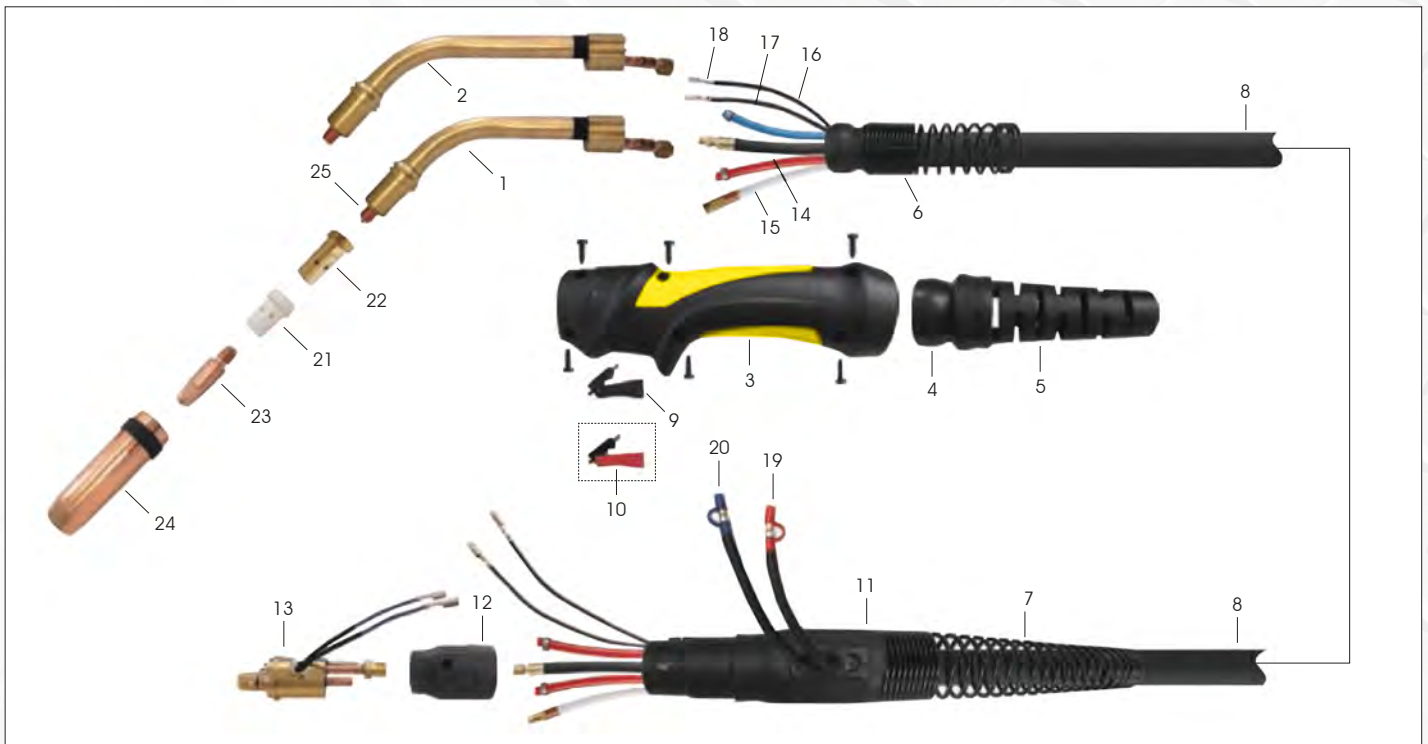

No.	TERMMEI Part No.	IWWS Part No.	Description
1	TM033.0001	-	Swan Neck TM401D, 50° Bent
2	TM034.0001	-	Swan Neck TM501D, 50° Bent
3	TMBZLTY-06-1SY(1BY)	-	Yellow Handle
4	TMBZLTY-06-2	-	Ball Joint
5	TMBZLTY-06-3B	-	Rubber Spring
6	TMBZLYN-02-42W	-	Rear Joint with Spring
7	TM855151ZG6-016	-	Spring
8	TM022.0034	-	Cable Assembly without Central Adaptor Block
	TM022-0038	-	
	TM022-0041	-	
9	TMBZLYN-02-21BK	-	Trigger
10	TMBZLYN-02-21RD	-	Trigger
11	TM855151ZG6-010	-	Rear Box for Water Cooled Torch
12	TMBZLYN-04-11BK	-	Rear Box Nut for Water Cooled Torch
13	TMB5098	-	Euro Central Adaptor
14	TM115.0065-3M	-	3M Power Cable
	TM115.0065-4M	-	4M Power Cable
	TM115.0065-5M	-	5M Power Cable
15	TM155.0008-3M	-	Blue Wire Conduit (wire Ø2.0 onwards)
	TM155.0008-4M	-	
	TM155.0008-5M	-	
16	TM100.0019	-	Control Cable 2 pol
17	TM109.0040	-	Hose 30 Black Ø4.9 x 1.5
18	TM175.022	-	Trigger Wire Connector
19	TMBZLYN-04-31RD	-	Plastic Support
20	TMBZLYN-04-31BU	-	Plastic Support
21	TM030.0145	-	White Gas Diffuser
	TM030.0190	Z030-0190	Ceramic Gas Diffuser
	TM030.0037	-	Long Life Gas Diffuser
	TM030.0029	-	Black Gas Diffuser
22	TM142.0008	-	Contact Tip Holder M6 25MM Short
	TM142.0022	Z142-0022	Contact Tip Holder M8 25MM Short

No.	TERMMEI Part No.	IWWS Part No.	Description	
<b>Contact Tip M6</b>				
23	TM140.0051	Z140-0051	E-Cu Ø0.8 (8 x 28)	
	TM140.0242	Z140-0242	E-Cu Ø1.0 (8 x 28)	
	TM140.0379	Z140-0379	E-Cu Ø1.2 (8 x 28)	
	TM140.0555	Z140-0555	E-Cu Ø1.6 (8 x 28)	
	TM140.0054	-	CuCrZr Ø0.8 (8 x 28)	
	TM140.0245	-	CuCrZr Ø1.0 (8 x 28)	
	TM140.0382	-	CuCrZr Ø1.2 (8 x 28)	
	TM140.0558	-	CuCrZr Ø1.6 (8 x 28)	
	TM141.0001	Z141-0001	E-Cu Ø0.8 For Alu Wire (8x28)	
	TM141.0006	Z141-0006	E-Cu Ø1.0 For Alu Wire (8x28)	
	TM141.0010	Z141-0010	E-Cu Ø1.2 For Alu Wire (8x28)	
	TM141.0020	-	E-Cu Ø1.6 For Alu Wire (8x28)	
<b>Contact Tip M8</b>				
23	TM140.0114	Z140-0114	E-Cu Ø0.8 (10 x 30)	
	TM140.0313	Z140-0313	E-Cu Ø1.0 (10 x 30)	
	TM140.0442	Z140-0442	E-Cu Ø1.2 (10 x 30)	
	TM140.0587	Z140-0587	E-Cu Ø1.6 (10 x 30)	
	TM140.0117	-	CuCrZr Ø0.8 (10 x 30)	
	TM140.0316	Z140-0316	CuCrZr Ø1.0 (10 x 30)	
	TM140.0445	Z140-0445	CuCrZr Ø1.2 (10 x 30)	
	TM140.0590	Z140-0590	CuCrZr Ø1.6 (10 x 30)	
	TM141.0003	-	E-Cu Ø0.8 For Alu Wire (10x30)	
	TM141.0008	Z141-0008	E-Cu Ø1.0 For Alu Wire (10x30)	
	TM141.0015	Z141-0015	E-Cu Ø1.2 For Alu Wire (10x30)	
	TM141.0022	Z141-0022	E-Cu Ø1.6 For Alu Wire (10x30)	
	24	TM145.0051	-	Gas Nozzle Cylindrical ND Ø19.0
		TM145.0085	Z145-0085	Gas Nozzle Conical ND Ø16.0
TM145.0132		-	Gas Nozzle Tapered ND Ø14.0	
25	TM030.0019	Z030-0019	Insulator	



**INDEPENDENT WHOLESALE WELDING SUPPLY**

Ph: 02 8834 2400 Fax: 02 8834 2498 Email: iwws@iwws.net Website: www.iwws.net

# BINZEL

## MIG GUN BREAKDOWN



TERMMEI Part No.	IWWS Part No.	Description
<b>Guide Spiral Liner Blank</b>		
TM122.0005	-	3M; 1.5/4.0; Wire Ø0.8
TM122.0007	-	4M; 1.5/4.0; Wire Ø0.8
TM122.0009	-	5M; 1.5/4.0; Wire Ø0.8
TM122.0031	-	3M; 2.0/4.5; Wire Ø1.0-1.2
TM122.0036	Z122-0036	4M; 2.0/4.5; Wire Ø1.0-1.2
TM122.0039	-	5M; 2.0/4.5; Wire Ø1.0-1.2
TM122.0056	-	3M; 2.5/4.5; Wire Ø1.6
TM122.0060	Z122-0060	4M; 2.5/4.5; Wire Ø1.6
TM122.0063	-	5M; 2.5/4.5; Wire Ø1.6



Jump Liner

TERMMEI Part No.	IWWS Part No.	Description
<b>PTFE Red Core Liner 2.0/4.0; Wire Electrode Ø1.0-1.2</b>		
TM126.0021	Z126-0021	3M
TM126.0026	Z126-0026	4M
-	Z126-0026J	5M Jump Liner + Nylon Liner with BZ / TW Collet
TM126.0028	Z126-0028	5M

TERMMEI Part No.	IWWS Part No.	Description
<b>PTFE Yellow Core Liner 2.7/4.7; Wire Electrode Ø1.6</b>		
TM126.0039	-	3M
TM126.0042	Z126-0042	4M
TM126.0045	-	5M



INDEPENDENT WHOLESALE WELDING SUPPLY

Ph: 02 8834 2400 Fax: 02 8834 2498 Email: iwws@iwws.net Website: www.iwws.net