

GOUGING

Profax AEC3000/AEC3000-1 Gouging Torches

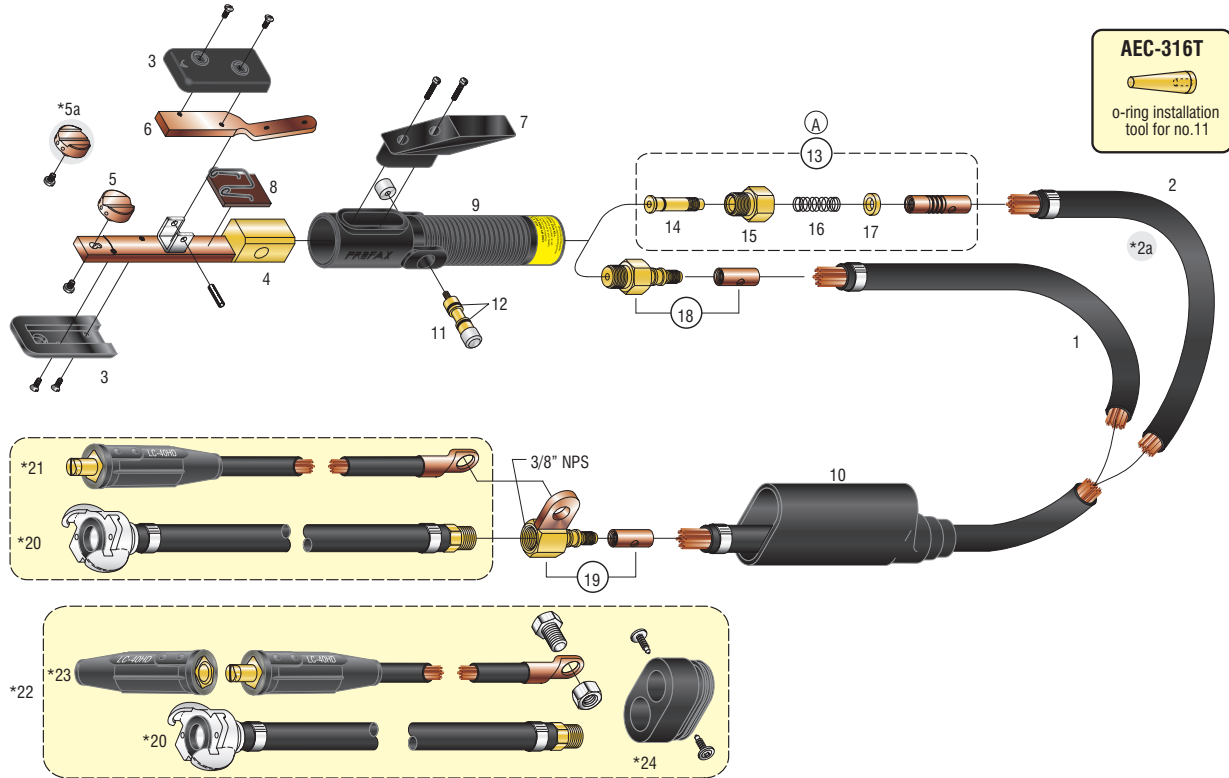

AEC3000

Part No.	Description	Pur.	Pk
AEC3000	Complete torch w/ 7 ft (2.1 m) cable assembly	1	1
AEC3001	Torch only 600 amp	1	1
1 AEC302	Cable assembly 7 ft (2.1 m)	1	1
3 AEC303	Insulator assembly with screws	1	1
4 AEC304	Lower tong and valve body	1	1
5 AEC305	Swivel head with screw	1	1
5a AEC305F	Flat swivel with screw (optional)	1	1
6 AEC307	Upper arm	1	1
7 AEC308	Lever assembly with screws	1	1
8 AEC309	Spring, insulator assembly	1	1
9 AEC350	Handle	1	1
10 AEC311	Cable insulating tool	1	1
11 AEC316R	Spool assembly	1	1
12 AEC316-1R	O-Ring (pk of 2)	1 PK	2
18 AEC3-028	Male cable connector assembly	1	1
19 AEC3-029	Female cable connector assembly	1	1
20 AEC3-040	Air hose extension 18 inch long with crow foot connection (optional)	1	1
21 AEC3-041TW	Power cable extension 3/0 cable 18 inch long with LC-40HD male (optional)	1	1
22 AEC3-045CF	Power/air insulation kit (optional)	1	1
23 AEC3-042	Power cable extension 3/0 18 inch long cable with LC-40HD and LC-40HD female (optional)	1	1
24 AEC312	Insulating block (optional)	1	1

AEC3000-1

Part No.	Description	Pur.	Pk
AEC3000-1	Complete torch w/ 7 ft (2.1 m) swivel cable assembly	1	1
AEC3000-1-045CF	Complete torch w/ 7 ft (2.1 m) swivel cable assembly and installation kit	1	1
2 AEC302-1	Cable assembly swivel 7 ft (2.1 m)	1	1
2a AEC312-1	Cable assembly swivel 12 ft (3.65 m) (optional)	1	1
3 AEC303	Insulator assembly with screws	1	1
4 AEC304	Lower tong and valve body	1	1
5 AEC305	Swivel head with screw	1	1
5a AEC305F	Flat swivel with screw (optional)	1	1
6 AEC307	Upper arm	1	1
7 AEC308	Lever assembly with screws	1	1
8 AEC309	Spring, insulator assembly	1	1
9 AEC350	Handle	1	1
10 AEC311	Cable insulating tool	1	1
11 AEC316R	Spool assembly	1	1
12 AEC316-1R	O-Ring (pk of 2)	1 PK	2
13 AEC321	Swivel joint assembly	1	1
14 AEC322	Swivel joint stem	1	1
15 AEC323	Swivel joint male nut	1	1
16 AEC326	Swivel joint spring	1	1
17 AEC327	Swivel joint bushing	1	1
19 AEC3-029	Female cable connector assembly	1	1
20 AEC3-040	Air hose extension 18 inch long with crow foot connection (optional)	1	1
21 AEC3-041TW	Power cable extension 3/0 cable 18 inch long with LC-40HD male (optional)	1	1
22 AEC3-045CF	Power/air insulation kit (optional)	1	1
23 AEC3-042	Power cable extension 3/0 18 inch long cable with LC-40HD and LC-40HD female (optional)	1	1
24 AEC312	Insulating block (optional)	1	1

GOUGING

Profax AEC3500/AEC3500-1 Gouging Torches

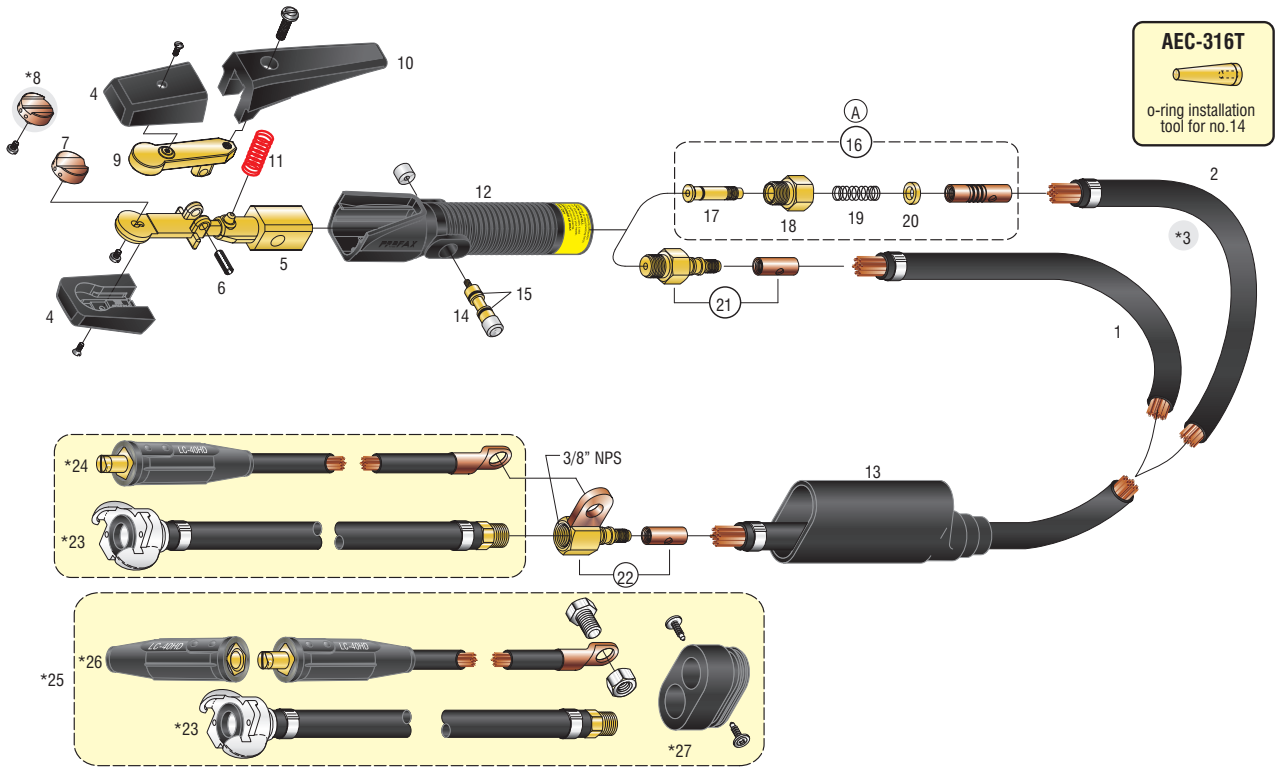

AEC3500

Part No.	Description	Pur.	Pk
AEC3500	Complete torch w/ 7 ft (2.1 m) cable assembly	1	1
1 AEC302	Cable assembly 7 ft (2.1 m)	1	1
4 AEC303	Insulator assembly with screws	1	1
5 AEC354	Lower tong and valve body	1	1
6 AEC410	Pin	1	1
7 AEC305	Swivel head with screw	1	1
8 AEC305F	Flat swivel with screw (optional)	1	1
9 AEC407	Upper arm	1	1
10 AEC408	Lever assembly with screw	1	1
11 AEC409	Spring	1	1
12 AEC375	Handle	1	1
13 AEC311	Cable insulating tool	1	1
14 AEC316R	Spool assembly	1	1
15 AEC316-1R	O-Ring (pk of 2)	1 PK	2
21 AEC3-028	Male cable connector	1	1
22 AEC3-029	Female cable connector assembly	1	1
23 AEC3-040	Air hose extension 18 inch long with crow foot connection (optional)	1	1
24 AEC3-041TW	Power cable extension 3/0 cable 18 inch long with LC-40HD male (optional)	1	1
25 AEC3-045CF	Power/air insulation kit (optional)	1	1
26 AEC3-042	Power cable extension 3/0 18 inch long cable with LC-40HD and LC-40HD female (optional)	1	1
27 AEC312	Insulating block (optional)	1	1

AEC3500-1

Part No.	Description	Pur.	Pk
AEC3500-1	Complete torch w/ 7 ft (2.1 m) swivel cable assembly	1	1
2 AEC302-1	Cable assembly swivel 7 ft (2.1 m)	1	1
3 AEC312-1	Cable assembly swivel 12 ft (3.65 m) (optional)	1	1
4 AEC303	Insulator assembly with screws	1	1
5 AEC354	Lower tong and valve body	1	1
6 AEC410	Pin	1	1
7 AEC305	Swivel head with screw	1	1
8 AEC305F	Flat swivel with screw (optional)	1	1
9 AEC407	Upper arm	1	1
10 AEC408	Lever assembly with screw	1	1
11 AEC409	Spring	1	1
12 AEC375	Handle	1	1
13 AEC311	Cable insulating tool	1	1
14 AEC316R	Spool assembly	1	1
15 AEC316-1R	O-Ring (pk of 2)	1 PK	2
16 AEC321	Swivel joint assembly	1	1
17 AEC322	Swivel joint stem	1	1
18 AEC323	Swivel joint male nut	1	1
19 AEC326	Swivel joint spring	1	1
20 AEC327	Swivel joint bushing	1	1
22 AEC3-029	Female cable connector	1	1
23 AEC3-040	Air hose extension 18 inch long with crow foot connection (optional)	1	1
24 AEC3-041TW	Power cable extension 3/0 cable 18 inch long with LC-40HD male (optional)	1	1
25 AEC3-045CF	Power/air insulation kit (optional)	1	1
26 AEC3-042	Power cable extension 3/0 18 inch long cable with LC-40HD and LC-40HD female (optional)	1	1
27 AEC312	Insulating block (optional)	1	1

GOUGING

Profax AEC4000-1/AEC4500-1 Gouging Torches

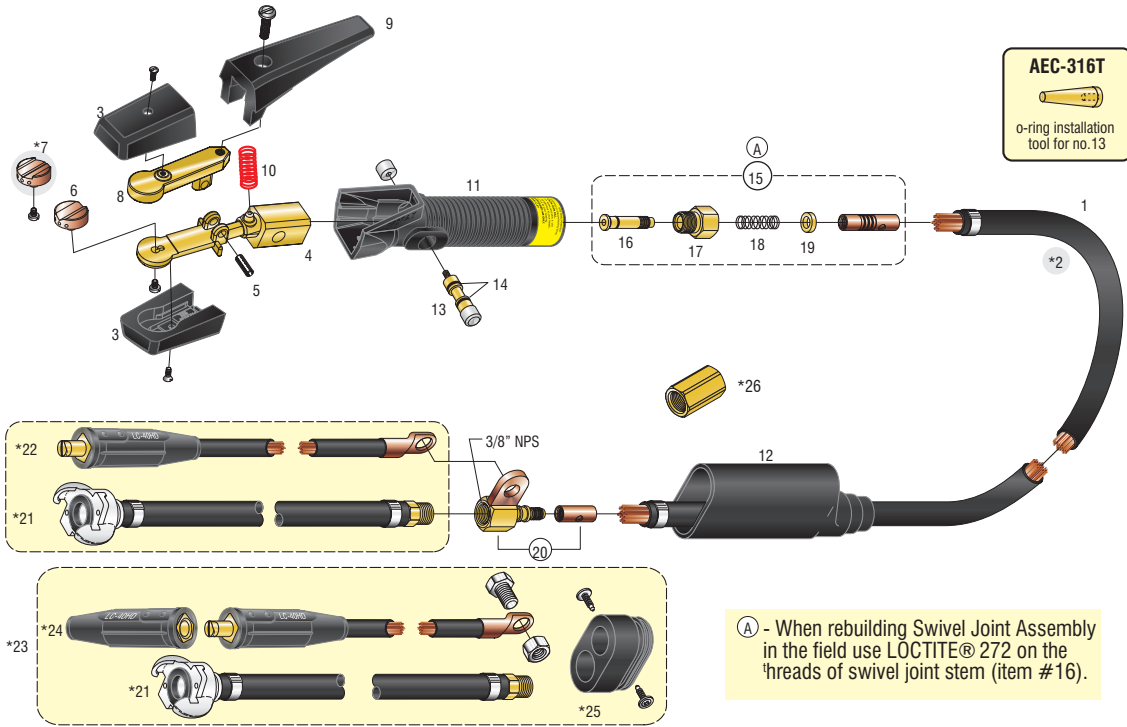

AEC-316T



O-ring installation tool for no. 13

A - When rebuilding Swivel Joint Assembly in the field use LOCTITE® 272 on the threads of swivel joint stem (item #16).

AEC4000-1

Part No.	Description	Pur.	Pk
AEC4000-1	Complete torch w/ 7 ft (2.1 m) swivel cable assembly	1	1
AEC4001	Torch only	1	1
AEC4000-12-1	Complete torch w/ 7 ft (2.1 m) swivel cable assembly and insulation kit	1	1
AEC4000-1045CFD	Complete torch w/ 7 ft (2.1 m) swivel cable assembly, dinse and insulation kit	1	1
1 AEC302-1	Cable assembly 7 ft (2.1 m)	1	1
2 AEC312-1	Cable assembly swivel 12 ft (3.65 m)	1	1
3 AEC403	Insulator assembly with screws	1	1
4 AEC404	Lower tong and valve body	1	1
5 AEC410	Pin	1	1
6 AEC305	Swivel head with screw	1	1
7 AEC305F	Flat swivel with screw (optional)	1	1
8 AEC407	Upper arm	1	1
9 AEC408	Lever assembly with screw	1	1
10 AEC409	Spring	1	1
11 AEC450	Handle	1	1
12 AEC311	Cable insulating tool	1	1
13 AEC316R	Spool assembly	1	1
14 AEC316-1R	O-Ring (pk of 2)	1 PK	2
15 AEC321	Swivel joint assembly	1	1
16 AEC322	Swivel joint stem	1	1
17 AEC323	Swivel joint male nut	1	1
18 AEC326	Swivel joint spring	1	1
19 AEC327	Swivel joint bushing	1	1
20 AEC3-029	Female cable connector	1	1
21 AEC3-040	Air hose extension 18 inch long with crow foot connection (optional)	1	1
22 AEC3-041TW	Power cable extension 3/0 cable 18 inch long with LC-40HD male (optional)	1	1
23 AEC3-045CF	Power/air insulation kit (optional)	1	1
24 AEC3-042	Power cable extension 3/0 18 inch long cable with LC-40HD and LC-40HD female (optional)	1	1
25 AEC312	Insulating block (optional)	1	1
26 AEC40	Cable adaptor AEC4000 - K4000	1	1

AEC4500-1

Part No.	Description	Pur.	Pk
AEC4500-1	Complete torch w/ 7 ft (2.1 m) swivel cable assembly	1	1
1 AEC502-1	Cable assembly swivel 7 ft (2.1 m)	1	1
2 AEC512-1	Cable assembly swivel 12 ft (3.65 m) (optional)	1	1
3 AEC403	Insulator assembly with screws	1	1
4 AEC454	Lower tong and valve body	1	1
5 AEC410	Pin	1	1
6 AEC505	Swivel head with screw	1	1
7 AEC505F	Flat swivel with screw (optional)	1	1
8 AEC407	Upper arm	1	1
9 AEC408	Lever assembly with screw	1	1
10 AEC409	Spring	1	1
11 AEC450	Handle	1	1
12 AEC511	Cable insulating tool	1	1
13 AEC316R	Spool assembly	1	1
14 AEC316-1R	O-Ring (pk of 2)	1 PK	2
15 AEC521	Swivel joint assembly	1	1
16 AEC522	Swivel joint stem	1	1
17 AEC523	Swivel joint male nut	1	1
18 AEC526	Swivel joint spring	1	1
19 AEC527	Swivel joint bushing	1	1
20 AEC5-029	Female cable connector	1	1
21 AEC3-040	Air hose extension 18 inch long with crow foot connection (optional)	1	1
22 AEC3-041TW	Power cable extension 3/0 cable 18 inch long with LC-40HD male (optional)	1	1
23 AEC3-045CF	Power/air insulation kit (optional)	1	1
24 AEC3-042	Power cable extension 3/0 18 inch long cable with LC-40HD and LC-40HD female (optional)	1	1
25 AEC312	Insulating block (optional)	1	1

GOUGING

Profax AEC5000/AEC5000-1 Gouging Torches

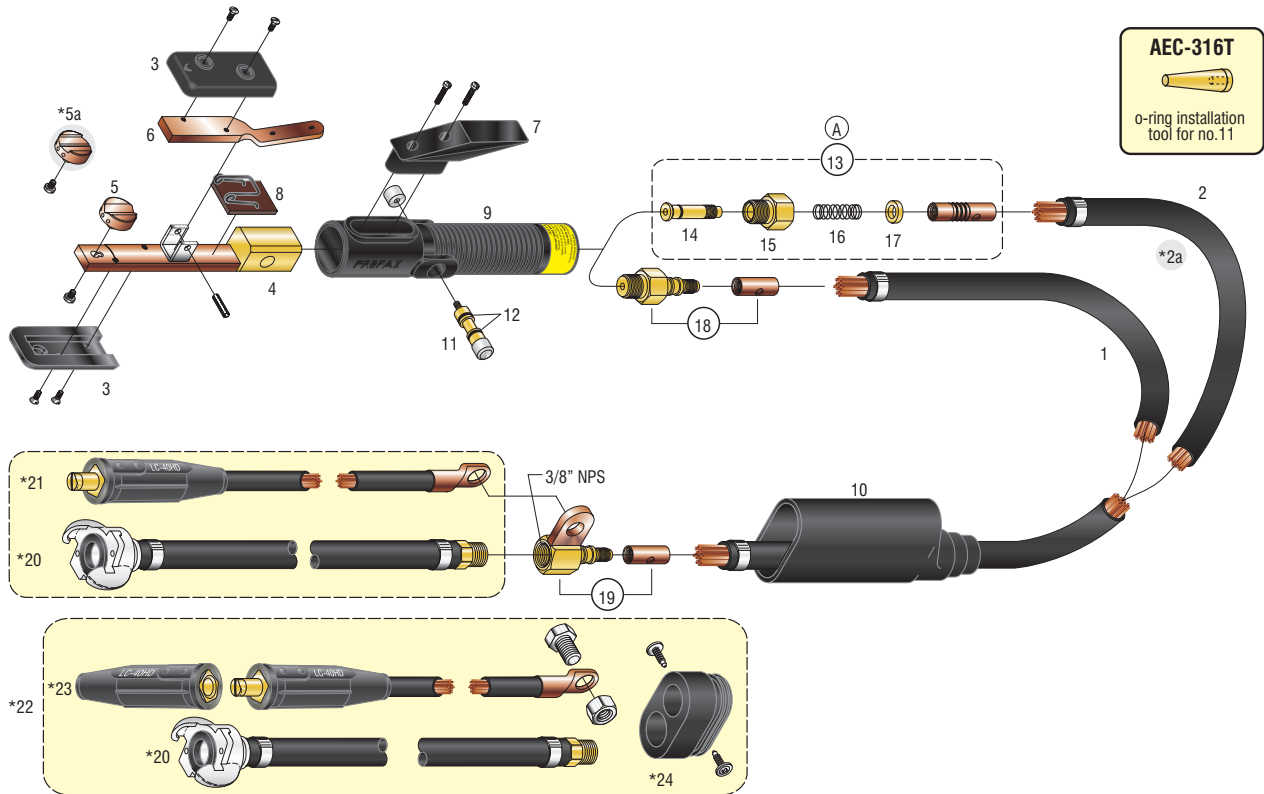

AEC5000

Part No.	Description	Pur.	Pk
AEC5000	Complete torch w/ 7 ft (2.1 m) cable assembly	1	1
AEC5001	Torch only 1200 amp	1	1
1 AEC502	Cable assembly 7 ft (2.1 m)	1	1
3 AEC303	Insulator assembly with screws	1	1
4 AEC304	Lower tong and valve body	1	1
5 AEC305	Swivel head with screw	1	1
5a AEC305F	Flat swivel with screw (optional)	1	1
6 AEC307	Upper arm	1	1
7 AEC308	Lever assembly with screws	1	1
8 AEC309	Spring, insulator assembly	1	1
9 AEC350	Handle	1	1
10 AEC511	Cable insulating tool	1	1
11 AEC316R	Spool assembly	1	1
12 AEC316-1R	O-Ring (pk of 2)	1 PK	2
18 AEC5-028	Male cable connector assembly	1	1
19 AEC5-029	Female cable connector assembly	1	1
20 AEC3-040	Air hose extension 18 inch long with crow foot connection (optional)	1	1
21 AEC3-041TW	Power cable extension 3/0 cable 18 inch long with LC-40HD male (optional)	1	1
22 AEC3-045CF	Power/air insulation kit (optional)	1	1
23 AEC3-042	Power cable extension 3/0 18 inch long cable with LC-40HD and LC-40HD female (optional)	1	1
24 AEC312	Insulating block (optional)	1	1

AEC5000-1

Part No.	Description	Pur.	Pk
AEC5000-1	Complete torch w/ 7 ft (2.1 m) swivel cable assembly	1	1
2 AEC502-1	Cable assembly swivel 7 ft (2.1 m)	1	1
2a AEC512-1	Cable assembly swivel 12 ft (3.65 m) (optional)	1	1
3 AEC303	Insulator assembly with screws	1	1
4 AEC304	Lower tong and valve body	1	1
5 AEC305	Swivel head with screw	1	1
5a AEC305F	Flat swivel with screw (optional)	1	1
6 AEC307	Upper arm	1	1
7 AEC308	Lever assembly with screws	1	1
8 AEC309	Spring, insulator assembly	1	1
9 AEC350	Handle	1	1
10 AEC511	Cable insulating tool	1	1
11 AEC316R	Spool assembly	1	1
12 AEC316-1R	O-Ring (pk of 2)	1 PK	2
13 AEC521	Swivel joint assembly	1	1
14 AEC522	Swivel joint stem	1	1
15 AEC523	Swivel joint male nut	1	1
16 AEC526	Swivel joint spring	1	1
17 AEC527	Swivel joint bushing	1	1
19 AEC5-029	Female cable connector assembly	1	1
20 AEC3-040	Air hose extension 18 inch long with crow foot connection (optional)	1	1
21 AEC3-041TW	Power cable extension 3/0 cable 18 inch long with LC-40HD male (optional)	1	1
22 AEC3-045CF	Power/air insulation kit (optional)	1	1
23 AEC3-042	Power cable extension 3/0 18 inch long cable with LC-40HD and LC-40HD female (optional)	1	1
24 AEC312	Insulating block (optional)	1	1

GOUGING

Profax AEC5500/AEC5500-1 Gouging Torches

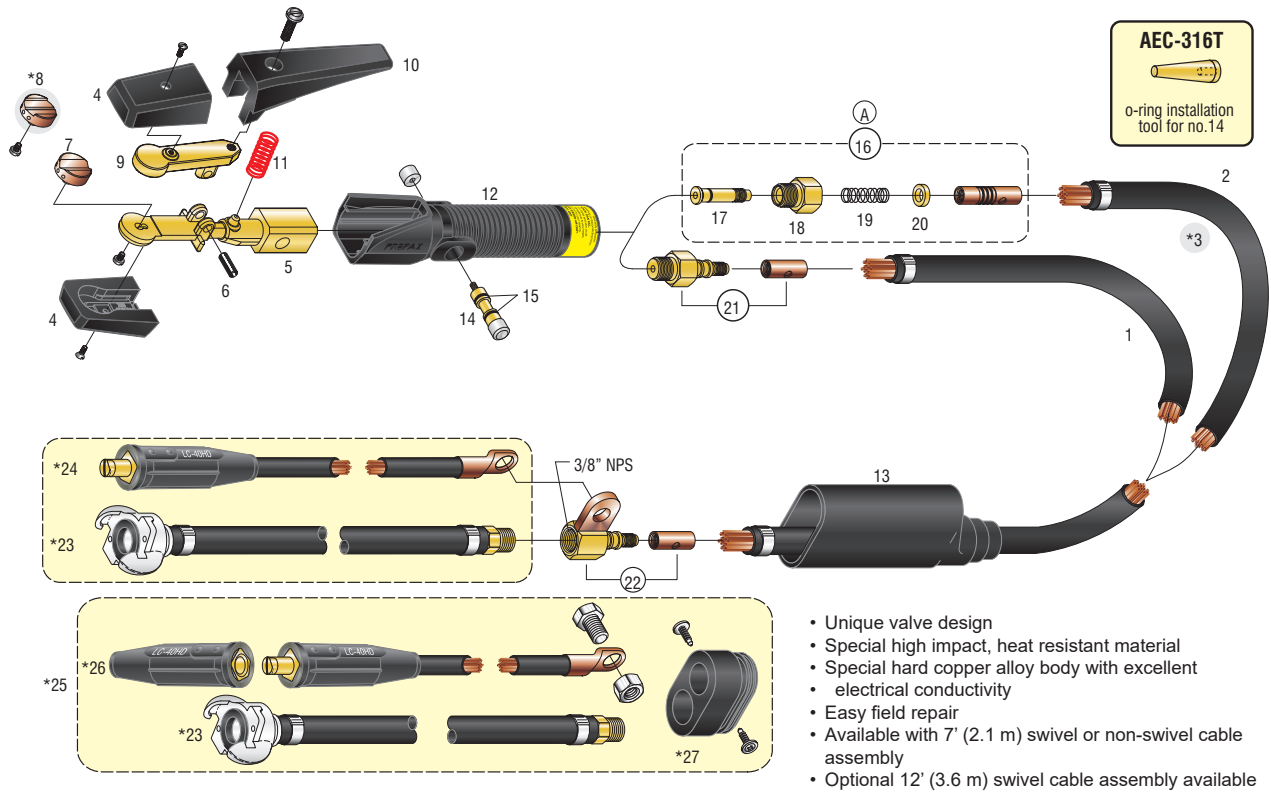

AEC5500

Part No.	Description	Pur.	Pk
AEC5500	Complete torch w/ 7 ft (2.1 m) cable assembly	1	1
1 AEC502	Cable assembly 7 ft (2.1 m)	1	1
4 AEC403	Insulator assembly with screws	1	1
5 AEC544	Lower tong and valve body	1	1
6 AEC410	Pin	1	1
7 AEC505	Swivel head with screw	1	1
8 AEC505F	Flat swivel with screw (optional)	1	1
9 AEC407	Upper arm	1	1
10 AEC408	Lever assembly with screws	1	1
11 AEC409	Spring	1	1
12 AEC375	Handle	1	1
13 AEC511	Cable insulating tool	1	1
14 AEC316R	Spool assembly	1	1
15 AEC316-1R	O-Ring (pk of 2)	1 PK	2
21 AEC5-028	Male cable connector assembly	1	1
22 AEC5-029	Female cable connector assembly	1	1
23 AEC3-040	Air hose extension 18 inch long with crow foot connection (optional)	1	1
24 AEC3-041TW	Power cable extension 3/0 cable 18 inch long with LC-40HD male (optional)	1	1
25 AEC3-045CF	Power/air insulation kit (optional)	1	1
26 AEC3-042	Power cable extension 3/0 18 inch long cable with LC-40HD and LC-40HD female (optional)	1	1
27 AEC312	Insulating block (optional)	1	1

AEC5500-1

Part No.	Description	Pur.	Pk
AEC5500-1	Complete torch w/ 7 ft (2.1 m) swivel cable assembly	1	1
2 AEC502-1	Cable assembly swivel 7 ft (2.1 m)	1	1
3 AEC512-1	Cable assembly swivel 12 ft (3.65 m) (optional)	1	1
4 AEC403	Insulator assembly with screws	1	1
5 AEC544	Lower tong and valve body	1	1
6 AEC410	Pin	1	1
7 AEC505	Swivel head with screw	1	1
8 AEC505F	Flat swivel with screw (optional)	1	1
9 AEC407	Upper arm	1	1
10 AEC408	Lever assembly with screws	1	1
11 AEC409	Spring, insulator assembly	1	1
12 AEC375	Handle	1	1
13 AEC511	Cable insulating tool	1	1
14 AEC316R	Spool assembly	1	1
15 AEC316-1R	O-Ring (pk of 2)	1 PK	2
16 AEC521	Swivel joint assembly	1	1
17 AEC522	Swivel joint stem	1	1
18 AEC523	Swivel joint male nut	1	1
19 AEC526	Swivel joint spring	1	1
20 AEC527	Swivel joint bushing	1	1
22 AEC5-029	Female cable connector assembly	1	1
23 AEC3-040	Air hose extension 18 inch long with crow foot connection (optional)	1	1
24 AEC3-041TW	Power cable extension 3/0 cable 18 inch long with LC-40HD male (optional)	1	1
25 AEC3-045CF	Power/air insulation kit (optional)	1	1
26 AEC3-042	Power cable extension 3/0 18 inch long cable with LC-40HD and LC-40HD female (optional)	1	1
27 AEC312	Insulating block (optional)	1	1

GOUGING

Flair 600 Gouging Torch



The efficient air cooling system ensures comfortable handling. The round tip on the lever and the rotating injection nozzle ensure excellent clamping and maximum adjustment of the gouging electrode. Minimal air resistance through the body ensures optimal air pressure at the injection nozzle.



Part No.	Description	Pur.	Pk
V060180600	Flair 600 torch 600 amp	1	1
1 V060680628	Screw (732)	1	1
2 V060680626	Caps (762) pack of 2	1 PK	2
3 V060680600	Lever (724)	1	1
4 V060308251	Injector nozzle (720)	1	1
5 V060680606	Lever insulator (764)	1	1
6 V011109001	Spring (730)	1	1
7 V060680620	Flair pin (727)	1	1
8 V060680612	Body (726)	1	1
9 V060680637	Valve (767)	1	1
10 V060308323	Push button (768)	1	1
11 V060308341	Safety ring (769)	1	1
12 V060680630	Handle (731)	1	1
13 V060680622	Push button link (728)	1	1
14 V060308334	Valve seat (766)	1	1
15 V060408620	Boot (523)	1	1
16 V060280601	7" Swivel cable 600 amp	1	1

Flair 1600 Gouging Torch



The efficient air cooling system ensures comfortable handling. The round tip on the lever and the rotating injection nozzle ensure excellent clamping and maximum adjustment of the gouging electrode. Minimal air resistance through the body ensures optimal air pressure at the injection nozzle.



Part No.	Description	Pur.	Pk
V060181600	Flair 1600 torch 400 amp	1	1
1 V060680628	Screw (732)	1	1
2 V060680626	Caps (762) pack of 2	1 PK	2
3 V060681600	Lever	1	1
4 V060308550	Injector nozzle (750)	1	1
5 V060680606	Lever insulator (764)	1	1
6 V060681624	Spring (760)	1	1
7 V060680620	Flair pin (727)	1	1
8 V060681612	Body (756)	1	1
9 V060680637	Valve (767)	1	1
10 V060308323	Push button (768)	1	1
11 V060308341	Safety ring (769)	1	1
12 V060681630	Handle (761)	1	1
13 V060680622	Push button link (728)	1	1
14 V063908533	Nylon screw (471)	1	1
15 V060308334	Valve seat (766)	1	1
16 V060281601	7" Swivel cable 1600 amp	1	1

GOUGING

Exothermic Cutting Rods



The OxyLance Sure Cut System will cut virtually any metal, both ferrous and nonferrous, and is faster than conventional oxy-acetylene cutting or carbon arc gouging. Our system does not require preheating or cleaning the material before cutting. It is easy to use and is cost effective for most applications.

Part No.	Description	Pur.	Pk
JRSC2024S-REG	Surecut tool box kit with reg.	1	1
25B24	6 mm x 60 cm (1/4" x 24")	1 PK	25
25B36	6 mm x 91 cm (1/4" x 36")	1 PK	25
25B48	6 mm x 121 cm (1/4" x 48")	1 PK	25
37B24	9 mm x 60 cm (3/8" x 24")	1 PK	25
37B36	9 mm x 91 cm (3/8" x 36")	1 PK	25
37B48	9 mm x 121 cm (3/8" x 48")	1 PK	25
37B24QC	QC 9 mm x 60 cm (3/8" x 24")	1 PK	25
37B36QC	QC 9 mm x 91 cm (3/8" x 36")	1 PK	25
37B48QC	QC 9 mm x 121 cm (3/8" x 48")	1 PK	25

Wet Stinger

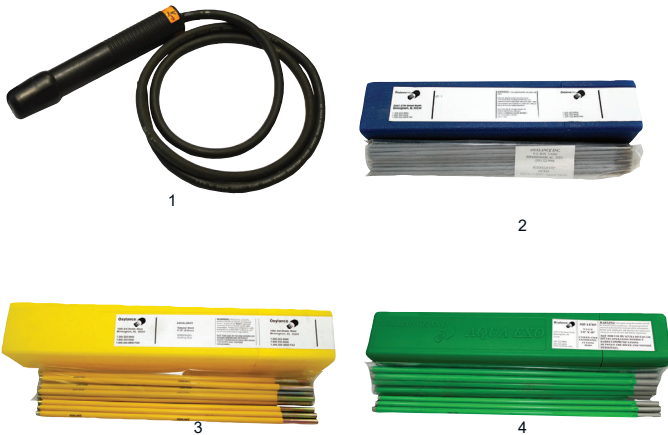

Part No.	Description	Pur.	Pk
1	Wet stinger 250 amp w/ 1.5 m (5 ft) lead	1	1
2	SUR1ELECTR Electrode 1/8" mild steel (4.5 kg)	1 PK	1
	SUR2ELECTR Electrode 5/32" mild steel (4.5 kg)	1 PK	1
	SURWELD/NI Electrode 3/32" nickel (4.5 kg)	1 PK	1
3	31EAQUALANCE Rod wet cut 5/16" x 16" steel	1 PK	50
4	37BAQUAEXO Rod wet exo cut 3/8 x 18"	1 PK	50

Surecut Consumables



Part No.	Description	Pur.	Pk
1	JRSC250-3 Sure cut collet 6 mm (1/4")	1	10
2	JRSC375-3 Sure cut collet 9 mm (3/8")	1	10
3	JRSC2000-2 Sure cut collet nut	1	10
4	JRSC2000-4 Sure cut collet grommet	1	1
5	JRSC2000-5 Sure cut collet bolt	1	5
6	JRSC2000-6 Sure cut hand shield curved	1	1
7	JRSC2000-7 Sure cut shield grommet	1	5
8	JRSC2000-10 Sure cut power block	1	1
9	JRSC200-RL31 Sure cut handle assembly	1	1
10	JRSC2000-ONUT Sure cut handle screw nut	1	1
11	JRSC2000-ONUT Sure cut handle screw	1	1
12	OXY0250 Sure cut thermal shutoff	1	2
13	JRSC2000-216 Hose barb	1	1
14	JRSC2000-ON7 O2 Nut b r/h	1	1
15	JRSC2000-32 Outlet bushing male b 1/4npt	1	1

GOUGING

AC Carbons



Suitable for removal of metal from common ferrous and non-ferrous metal components such as those used in agriculture, automotive, construction, heavy fabrication, mining, quarrying and military.

Part No.	Description	Pur.	Pk
1	CAC5.0	5.0 x 355 mm	1 PK 50
2	CAC6.5	6.5 x 355 mm	1 PK 50
3	CAC8.0	8.0 x 355 mm	1 PK 50

DC Carbons



Suitable for removal of metal from common ferrous and non-ferrous metal components such as those used in agriculture, automotive, construction, heavy fabrication, mining, quarrying and military.

Part No.	Description	Pur.	Pk
1	C5.0	5.0 x 305 mm	1 PK 50
2	C6.5	6.5 x 305 mm	1 PK 50
3	C8.0	8.0 x 305 mm	1 PK 50
4	C10.0	10.0 x 305 mm	1 PK 50
5	C12.7	12.7 x 305 mm	1 PK 50

Flat Carbon



Flat carbons are used when finer detailing is required.

Part No.	Description	Pur.	Pk
CF515	5 x 15 x 355 mm	1 PK	50

Jointed Carbons



Jointed carbons have a female and male socket design, allowing either semi or automated gouging.

Part No.	Description	Pur.	Pk
1	C10.0J	10 x 430 mm	1 PK 25
	C10.0JPX	10 x 430 mm	1 PK 10
2	C13.0J	13 x 430 mm	1 PK 25
3	C16.0J	16 x 430 mm	1 PK 25
4	C19.0J	19 x 430 mm	1 PK 25
	C19.0JPX	19 x 430 mm	1 PK 10