

# PLASMA

## Cebora® 25/30/35



Part No.	Description	Pur.	Pk
PX1510	Swirl ring vespel	1	1

## Cebora® 50

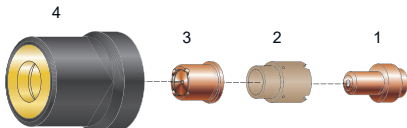

Part No.	Description	Pur.	Pk
1	PR0017 Electrode- no thread	10	10
2	PE0007 Swirl ring - vespel	2	2
3	PD0015-10 Tip 50 amp	10	10
	PD0015-12 Tip 60 amp	10	10
4	PC0003 Nozzle	4	4

## Cebora® 90/120/150

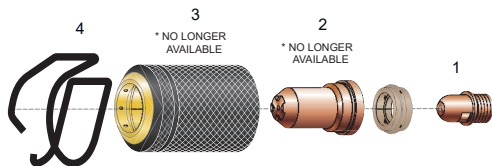

Part No.	Description	Pur.	Pk
1	PX1376 Electrode hafnium	10	10
2	PX1369 Nozzle extended*	5	5
3	PX1389 Nozzle retaining cap*	1	1
4	PX1386 Spacer spring	1	1

## Esab® (L-TEC® & LINDE®) PT17A & PT17AM

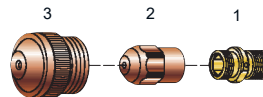

Part No.	Description	Pur.	Pk
1	PX20053 Electrode adaptor	1	1
2	PX19918 Electrode	5	5
3	PX19915 Tip 1.2 mm (.046") 50 amp	5	5
	PX20056 Tip 1.7 mm (.067") 100 amp	5	5

## Esab® (L-TEC® & LINDE®) PT20AM

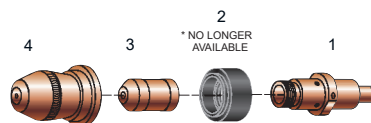

Part No.	Description	Pur.	Pk
1	PX21332 Electrode adaptor	1	1
2	PX21373 Insulator*	1	1
3	PX21150 Electrode	1	5
4	PX21328 Nozzle 100 amp	5	5

## Esab® (L-TEC® & LINDE®) PT25

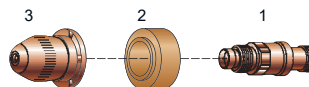

Part No.	Description	Pur.	Pk
1	PX21657 Electrode holder	1	1
2	PX21667 Swirl baffle	1	1
3	PX21597 Nozzle 100 amp	5	5
	PX21598 Nozzle 150 amp	5	5

# PLASMA

## Esab® (L-TEC® & LINDE®) PT23/27

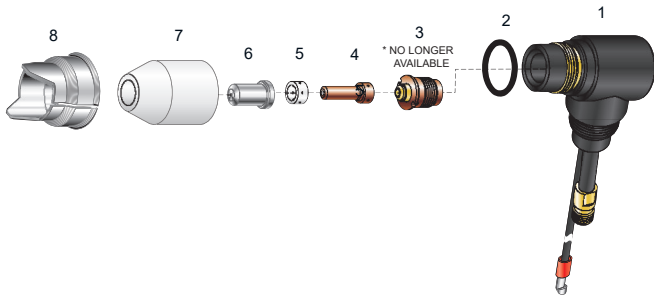

Part No.	Description	Pur.	Pk
1	PX21610 Torch body (PT-27)	1	1
2	PX85W51 O'ring	1	1
3	PX0558003032 Seat assembly*	1	1
4	PX33366 Electrode	5	5
5	PX33367 Swirl baffle	5	5
6	PX33368 Cutting nozzle 30 amp	5	5
	PX33369 Cutting nozzle 50-70 amp	5	5
	PX33418 Cutting nozzle 80 amp	5	5
7	PX21616 Heat shield (PT-27)	1	1
8	PX21420 Heat shield	1	1

## Hypertherm® MAX20

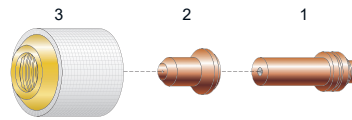

Part No.	Description	Pur.	Pk
1	PX020382 Electrode extended	5	5
2	PX020381 Nozzle extended 0.73 mm (.029")	5	5
3	PX220016 Retaining cap	1	1

## Hypertherm® MAX40CS/42/43 (PAC120/121)

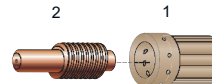

Part No.	Description	Pur.	Pk
1	PX020361 Swirl ring	1	1
2	PX120573 Electrode	5	5

## Esab® (L-TEC® & LINDE®) PT31 & PT31XL

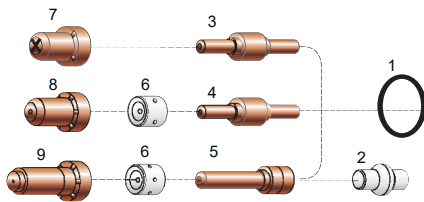

Part No.	Description	Pur.	Pk
1	PX950790 O'ring	10	10
2	PX20324 Plunger hd (new style) xt	5	5
3	PX18205 Electrode	5	5
4	PX19683 Electrode hd	5	5
5	PX20862 Electrode xt	5	5
6	PX20463 Swirl baffle 30-50 amp 6 holes, xl & xt	5	5
7	PX18866 Tip 30 amp 4 stakes	5	5
	PX18820 Tip 50 amp 4 stakes	5	5
8	PX19682 Tip hd 30 amp 6 stakes	5	5
9	PX20860 Tip 30 amp xt	10	10
	PX21008 Tip 40 amp xt	10	10
	PX20861 Tip 50 amp xt	10	10

## Hypertherm® MAX70/80/100 (PAC130)

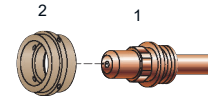

Part No.	Description	Pur.	Pk
1	PX120433* Electrode, air	5	5
2	PX020194 Swirl ring	1	1

\* - Original Hypertherm parts.

## Hypertherm® MAX200 (PAC200)

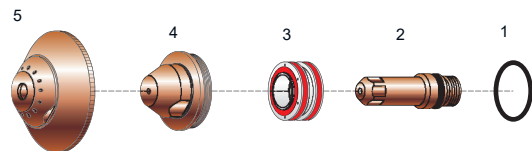

Part No.	Description	Pur.	Pk
1	PX044027 O'ring	1	1
2	PX220021* Electrode, hylife oxygen	1	1
3	PX020607 Swirl ring, air, nitrogen, argon/hydrogen, 100, 200 amp	1	1
4	PX020605 Nozzle, oxygen, 200 amp .082	1	1
	PX020608 Nozzle, air, nitrogen, argon/hydrogen, 200 amps, .086	1	1
5	PX020446* Shield, drag, all plasma gases, 200 amp	1	1

\* - Original Hypertherm parts.

# PLASMA

## Hypertherm® Powermax 350

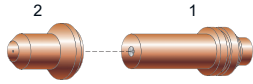

Part No.	Description	Pur.	Pk
1	PX020382	Electrode extended	5 5
2	PX120504	Nozzle extended 25 amp	5 5

## Hypertherm® Powermax 380

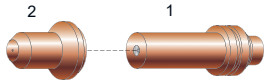

Part No.	Description	Pur.	Pk
1	PX020382	Electrode extended	5 5
2	PX120504	Nozzle extended 25 amp	5 5

## Hypertherm® Powermax 600 PAC123T/M)

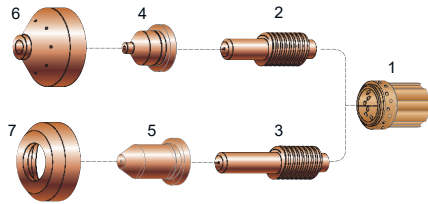

Part No.	Description	Pur.	Pk
1	PX120576	Swirl ring	2 2
2	PX120573*	Electrode air	5 5
3	PX120574*	Electrode extended	5 5
4	PX120826	Nozzle	10 10
5	PX120606	Nozzle pipe saddle 35 amp, extended	5 5
6	PX120828*	Shield, hand	2 2
7	PX120303	Deflector	2 2

\* - Original Hypertherm parts.

## Hypertherm® Powermax 800/900

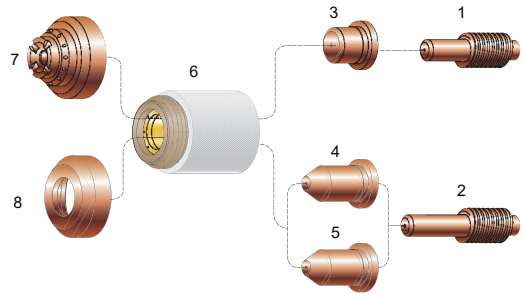

Part No.	Description	Pur.	Pk
1	PX120573	Electrode air	5 5
2	PX120574	Electrode extended	5 5
3	PX120577	Nozzle 55 amp (900)	5 5
	PX120282	Nozzle 55 amp (800)	5 5
4	PX120578*	Nozzle pipe saddle 55 amp (900) extended	5 5
	PX120305	Nozzle pipe saddle 55 amp (800)	5 5
5	PX120606	Nozzle pipe saddle 35 amp (900) extended	5 5
6	PX120600	Shield cap	1 1
7	PX120601*	Shield, hand	1 1
8	PX120303	Deflector	2 2

\* - Original Hypertherm parts.

# PLASMA

## Miller Electric Mfg.Co.® APT5000/APT7000

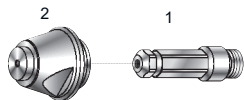

Part No.	Description	Pur.	Pk
1	PX123899	Electrode	5 5
2	PX123898	Tip 'S'	5 5

## Miller Electric Mfg.Co.® ICE-25C

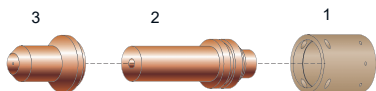

Part No.	Description	Pur.	Pk
1	PX202809	Swirl ring, 25 amp	1 1
2	PX176655	Electrode, 25 amp	5 5
3	PX176656	Tip, 25 amp	5 5

## Miller Electric Mfg.Co.® ICE-50

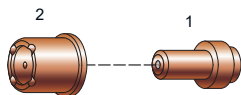

Part No.	Description	Pur.	Pk
1	PX169212	Electrode standard	5 5
2	PX174034	Tip standard	5 5

## Miller Electric Mfg.Co.® ICE-50C/50CM

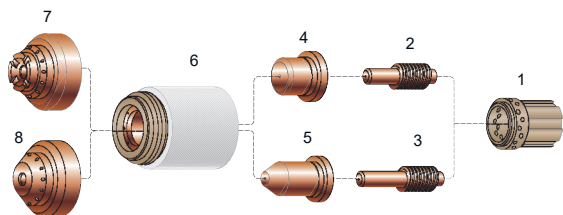

Part No.	Description	Pur.	Pk
1	PX177886	Swirl ring	1 1
2	PX192047	Electrode air	5 5
3	PX192048	Electrode extended	5 5
4	PX177890	Nozzle standard	10 10
5	PX177876	Nozzle pipe saddle extended, 55 amp	5 5
6	PX192050	Retaining cup	1 1
7	PX192053	Shield, drag	1 1
8	PX177888	Deflector	1 1

## Miller Electric Mfg.Co.® ICE55C/55CM

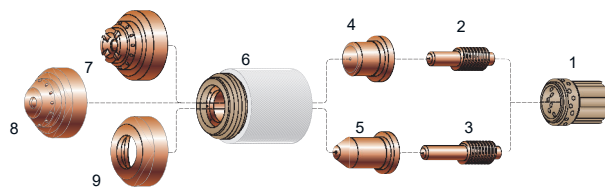

Part No.	Description	Pur.	Pk
1	PX192049	Swirl ring	1 1
2	PX192047	Electrode air	5 5
3	PX192048	Electrode extended	5 5
4	PX192051	Nozzle standard	10 10
5	PX192056	Nozzle pipe saddle, extended, 55 amp	5 5
6	PX192050	Retaining cup	1 1
7	PX192053	Shield drag	1 1
8	PX192058	Shield machine	1 1
9	PX177888	Deflector	1 1

## Miller Electric Mfg.Co.® ICE-70/100 & ICE-70M/100M

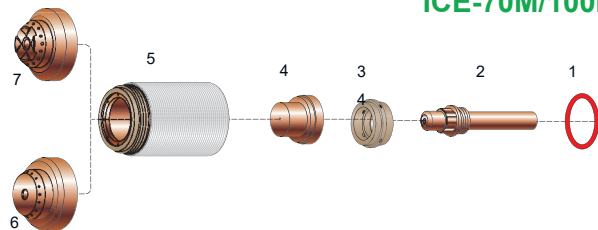

Part No.	Description	Pur.	Pk
1	PX169233	O'ring	10 10
2	PX169217	Electrode standard	5 5
3	PX169222	Swirl ring	1 1
4	PX169219	Tip shielded 70 amp	5 5
	PX169226	Tip shielded 100 amp	5 5
5	PX169223	Cup 70/100 amp	1 1
6	PX169230	Machine shield	1 1
7	PX169224	Drag shield	1 1



# PLASMA

## Thermal Dynamics Corp.® PCH-10

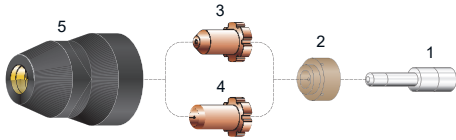

Part No.	Description	Pur.	Pk
1	PX9-6006 Electrode	5	5
2	PX9-6007 Gas distributor	2	2
3	PX9-6099 Tip, air, drag-gun™	5	5
4	PX9-4476 Tip, air, cougar™ 125	10	10
5	PX9-6003 Shield cup	2	2

## Thermal Dynamics Corp.® PCH-25

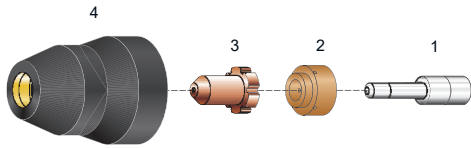

Part No.	Description	Pur.	Pk
1	PX9-6006 Electrode	5	5
2	PX9-6007 Gas distributor	1	1
3	PX9-4476 Tip, air, cougar™ 125	1	5
4	PX9-6003 Shield cup	1	1

## Thermal Dynamics Corp.® PCH/M-28

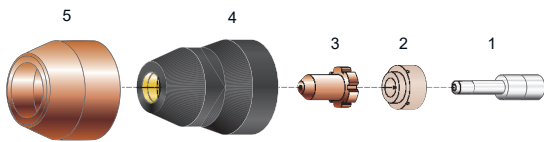

Part No.	Description	Pur.	Pk
1	PX9-6506 Electrode, long life	5	5
2	PX9-6507 Gas distributor, long life	1	1
3	PX9-6500 Tip, stand off	5	5
	PX9-6501 Tip, drag	5	5
4	PX9-6003 Shield cup	1	1
5	PX9-6503 Shield cup, long life w/ PX9-6003	1	1

## Thermal Dynamics Corp.® PCH/M-40

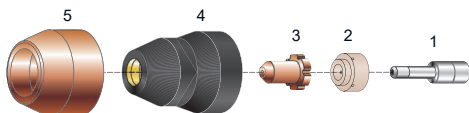

Part No.	Description	Pur.	Pk
1	PX9-6506 Electrode, long life	5	5
2	PX9-6507 Gas distributor, long life	1	1
3	PX9-6500 Tip, stand off	5	5
	PX9-6501 Tip, drag	5	5
4	PX9-6003 Shield cup	1	1
5	PX9-6503 Shield cup, long life w/ PX9-6003	1	1

## Thermal Dynamics Corp.® PCH/M-35

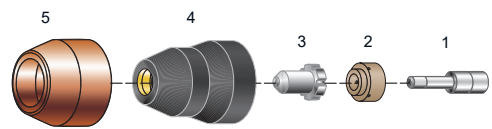

Part No.	Description	Pur.	Pk
1	PX9-6006 Electrode	5	5
	PX9-6506 Electrode, long life	5	5
2	PX9-6007 Gas distributor	1	1
	PX9-6507 Gas distributor, long life	1	1
3	PX9-6001 Tip, drag	5	5
	PX9-6500 Tip, stand off	5	5
	PX9-6501 Tip, drag	5	5
4	PX9-6003 Shield cup	1	1
5	PX9-6503 Shield cup, long life w/ PX9-6003	1	1

## Thermal Dynamics Corp.® PCH/M-51

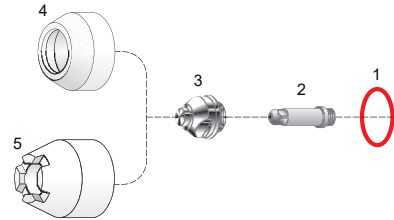

Part No.	Description	Pur.	Pk
1	PX8-5525 O'ring	1	20
2	PX9-5633 Electrode	5	5
	PX9-5720 Electrode (4x1)	5	5
3	PX9-5631 Tip 1.1 mm (.043")	5	5
4	PX9-5630 Shield cup ceramic	10	10
5	PX8-5526 Crown cup	10	10

## Thermal Dynamics Corp.® PCH/M-52

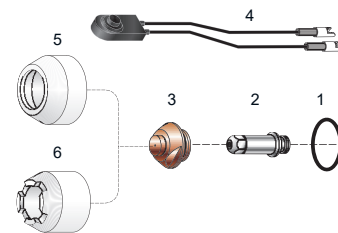

Part No.	Description	Pur.	Pk
1	PX8-5525 O'ring	10	10
2	PX9-5619 Electrode - hafnium	5	5
3	PX9-5618 Tip 1.1 mm (.043")	10	10
	PX9-5702 Tip 0.8 mm (.031") 35 amp, cut	5	5
	PX9-5708 Tip 1.5 mm (.059") 105 amp	5	5
4	PX9-5522 Switch	1	1
5	PX9-5617 Shield cup ceramic	10	10
	PX9-5781 Shield cup phenolic	5	5
6	PX9-5694 Crown shield cup	10	10

# PLASMA

## Thermal Dynamics Corp.® PCH/M-53

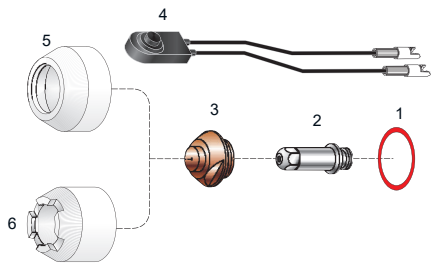

Part No.	Description	Pur.	Pk
1	PX8-5525	O'ring	10 10
2	PX9-5898	Electrode, air	5 5
3	PX9-5897	Tip, air, 70 amp	5 5
4	PX9-5522	Switch	1 1
5	PX9-5617	Shield cup ceramic	10 10
	PX9-5781	Shield cup phenolic	5 5
6	PX9-5694	Crown shield cup	10 10

## Thermal Dynamics Corp.® PCH/M-80

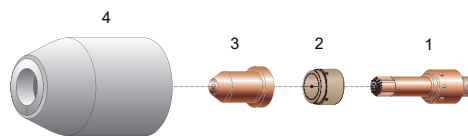

Part No.	Description	Pur.	Pk
1	PX8-7502	Electrode, air/n <sup>2</sup>	5 5
2	PX8-7501	Gas distributor, cutting	2 2
3	PX8-7503	Tip, cutting 35 amp, drag	10 10
	PX8-7504	Tip, cutting 55 amp, air/n <sup>2</sup>	10 10
4	PX8-7500	Shield cup	1 1

## Thermal Dynamics Corp.® PCH/M-60

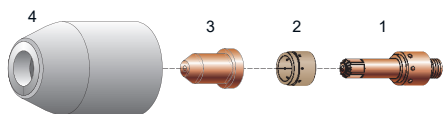

Part No.	Description	Pur.	Pk
1	PX8-7502	Electrode - hafnium	5 5
2	PX8-7501	Gas distributor, cutting	2 2
3	PX8-7503	Tip, cutting, 35 amp 1 mm (.039")	10 10
4	PX8-7500	Shield cup	1 1

## Thermal Dynamics Corp.® PCH/M-150

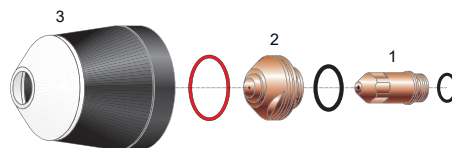

Part No.	Description	Pur.	Pk
1	PX9-5749	Electrode, air	5 5
2	PX9-5746	Tip, 150 amp, air 1.8 mm (.070")	5 5
	PX9-5751	Tip, 150 amp, o <sub>2</sub> 1.8 mm (.070")	5 5
3	PX9-5750	Shield cup ceramic	1 1

## Thermal Dynamics Corp.® PCH/M-62

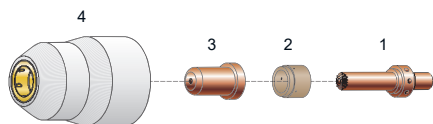

Part No.	Description	Pur.	Pk
1	PX9-8402	Electrode	1 5
2	PX9-8401	Gas distributor	1 1
3	PX9-8411	Tip, drag	5 5
	PX9-8412	Tip, stand off	5 5
4	PX9-8400	Shield cup	1 1

## Thermal Dynamics Corp.® PCH/M-75 & PCH-100XL

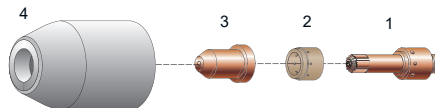

Part No.	Description	Pur.	Pk
1	PX8-7502	Electrode hafnium	5 5
2	PX8-7501	Gas distributor, cutting	2 2
3	PX8-7503	Tip, cutting 35 amp 1 mm (.039")	10 10
	PX8-7504	Tip, cutting 55 amp 1.2 mm (.046")	10 10
	PX8-7505	Tip, cutting 70 amp 1.3 mm (.052")	10 10
4	PX8-7500	Shield cup	1 1

# PLASMA

## Thermal Dynamics Corp.® PWM-300

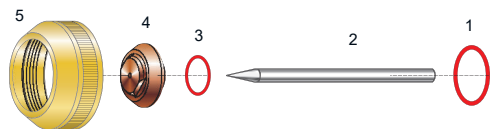

Part No.	Description	Pur.	Pk
1	PX9-2956 O-ring	10	10
2	PX9-1827 Electrode	5	5
3	PX9-2863 O-ring	10	10
4	PX8-6575 Tip 200 amp 2.4 mm (.093")	1	1
	PX8-6582 Tip 250 amp 2.9 mm (.113")	1	1
	PX8-6572 Tip 300 amp 3.2 mm (.125")	1	1
Included with each tip PX9-2863 & PX9-2956 O'rings			
5	PX8-6515 End cap	1	1

## Thermal Dynamics Corp.® PCH/M-102

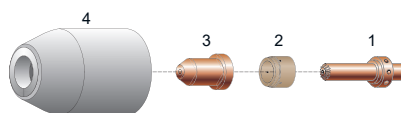

Part No.	Description	Pur.	Pk
1	PX9-8402 Electrode	1	5
2	PX8-7501 Gas distributor, cutting	2	2
3	PX8-7503 Tip, cutting 35 amp 1 mm (.039")	10	10
	PX9-8406 Tip, 100 amp	5	5
4	PX8-7500 Shield cup, cutting	1	1

## Thermal Dynamics Corp.® 6B

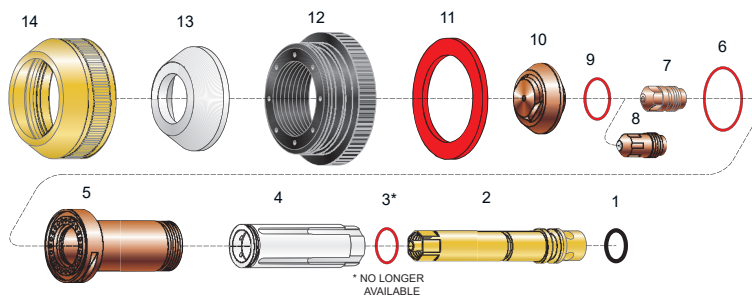

Part No.	Description	Pur.	Pk
1	PX8-0527 O-ring	10	10
2	PX8-6615 Electrode holder w/ PX9-2960, PX8-0527	1	1
3	PX9-2960 O-ring*	N/A	N/A
4	PX8-6569 Gas distributor w/ PX8-3146	1	1
5	PX8-6571 Liner w/ PX8-0531 & PX9-2956	1	1
6	PX9-2956 O-ring	10	10
7	PX8-6578 Electrode	5	5
8	PX8-6586 Electrode lo amp	5	5
9	PX9-2863 O-ring	10	10

Part No.	Description	Pur.	Pk
10	PX8-6580 Tip 100 amp 1.7 mm (.067")	1	1
	PX8-6575 Tip 200 amp 2.4 mm (.093")	1	1
	PX8-6582 Tip 300 amp 2.9 mm (.113")	1	1
	PX8-6572 Tip 400 amp 3.2 mm (.125")	1	1
Included with each tip PX9-2863 & PX9-2956 O'rings			
11	PX8-6512 Gasket	5	5
12	PX8-6581 Outer insulator	1	1
13	PX8-6514 End piece	10	10
14	PX8-6515 End cap	1	1

# PLASMA

## Saf® CP40R



Part No.	Description	Pur.	Pk
1	W000302546 Gouging zip kit 4 (CP40R / CP100R)	1	1
2	W000302609 Guide shoe/spring	5	5
3	W000302571 Nozzle 1.0 mm (.040") (new style)	5	5
4	W000302550 Nozzle 1.0 mm (.040")	5	5
5	W000302573 Nozzle 1.6 mm (1/16")	5	5
6	S04089008 Nozzle md 0.8 mm (1/32")	5	5
7	W000302552 Skirt ti cushion suits CP40R	1	1
8	S04082106 Trigger box	1	1
9	W000142826 Sec trigger control	1	1
	S04082127 Gas el-con 15 m (50 ft)	1	1

## Saf® Boards

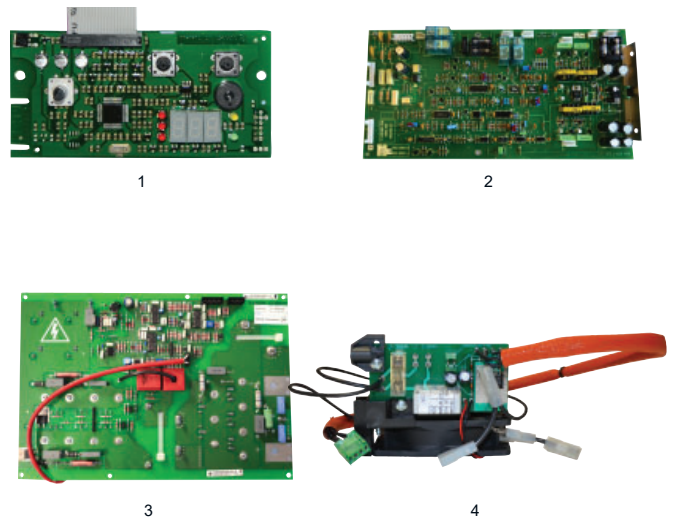

Part No.	Description	Pur.	Pk
1	W000050047 Circuit board pcb ce22666 (saxojet, prestojet 1)	1	1
2	S04086139 Reg pc board (prestozip 630)	1	1
3	W000050057 Circuit board (presto 140g, presto160g, saxo 1500)	1	1
4	W000050161 Circuit board ce 22665 (saxojet)	1	1

## Saf® CP100R /CPM100R



Part No.	Description	Pur.	Pk
1	W000302556 Torch 15 m (50 ft) (CPM100R)	1	1
2	W000302546 Gouging zip kit 4 CP40R / CP100R	1	1
3	W000142858 Gas ele.li 6 m (20 ft) air electrical (CP100R)	1	1
4	S04081232 Handle & screw (CP100R)	1	1
5	W000142815 Trigger button switch (CP100R)	1	1
6	W000142872 Trigger 15 m (50 ft) (CP100R)	1	1

## Saf® Electrode

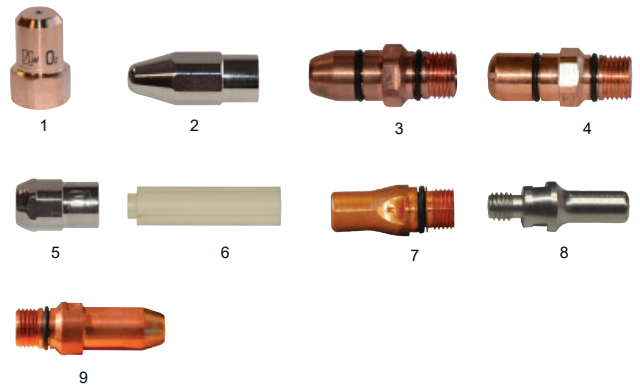

Part No.	Description	Pur.	Pk
1	W000120713 Electrode 02 200-360 amp cpm360	20	20
2	W000302574 Electrode I cp4.0	5	5
3	W000325031 Electrode flat	5	5
4	W000325118 Electrode flat h25	5	5
5	S04089155 Electrode hafnium	1	1
6	W000315797 Electrode sp7	1	1
7	S04091205 Electrode n <sub>2</sub> opm15/z5	5	5
8	W000274224 Electrode cpt 800	5	5
9	W000379083 Electrode flat h15/88	5	5

# PLASMA

## Saf® Nozzles



Part No.	Description	Pur.	Pk
1	S04092096	Nozzle 120 amp d1 6/16*1	10 10
2	S04081052	Nozzle straight	10 10
3	W000120711	Nozzle 140 amp cpm360	10 10
4	W000120712	Nozzle 260 amp cpm360	10 10
5	S04089213	Nozzle 1.0 mm (1/16")	5 5
6	W000302623	Nozzle z1 0.5 cp4.0	5 5
7	W000302515	Nozzle gouging z5.0	1 1
8	W000302567	Nozzle long 1.0 mm (1/16") cp4.0	5 5
9	S04089163	Nozzle long 0.8 mm (9/32")	5 5
10	W000302568	Nozzle long 1.2 mm (1/16") cp4.0	5 5
11	S04089218	Nozzle long 1.2 mm (1/16")	5 5
12	W000302614	Nozzle long 1.2 mm (1/16")	5 5
13	W000274265	Nozzle cpt 0.8 mm (9/32") cpt800	5 5
14	W000274969	Nozzle cpt 0.65 cpt800	5 5
15	S04092166	Nozzle cap	5 5
16	W000302569	Nozzle fl 0.8 mm (9/32") cp4.0	5 5
17	S04089008	Nozzle md 0.8 mm (9/32")	10 10
18	W000325570	Nozzle cone x 90 amp / 90 oxy	90 90
19	W000325573	Nozzle cone x 120 amp / 90 oxy	90 90
20	W000325601	Nozzle cone 250 amp	5 5
21	W000302571	Nozzle c1.0 blister	5 5
22	S04089219	Nozzle c1.0	10 10
23	W000302573	Nozzle c1.6	5 5
24	S04091211	Nozzle cone 20 amp cpm15 / z5	5 5
25	W000325067	Nozzle cone 40 amp cpm15	5 5
26	W000325069	Nozzle cone 60 amp cpm15	5 5
27	W000325072	Nozzle cone 100 amp cpm15	5 5

## Saf® Nozzles



Part No.	Description	Pur.	Pk
1	S04092072	Nozzle cone 60 amp 1, 1/31	5 5
2	W000325106	Nozzle cone 90 amp /1, 3/33	5 5
3	W000325108	Nozzle cone 120 amp / 1,6/33	5 5
4	S04092183	Nozzle cone x 90 amp /1 3/27	5 5
5	S04092474	Nozzle cone x 40 amp / 90 oxy	90 90
6	W000325569	Nozzle cone x 60 amp / 90 oxy	90 90

## Saf® O'ring

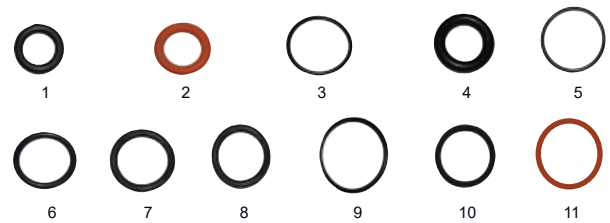

Part No.	Description	Pur.	Pk
1	S04081238	Seals pa5 5.28 x 1.78 n	5 5
2	W000325122	Seal 10 x 3 silicone	5 5
3	S04081284	Seal 24 x 2 nitrile	5 5
4	S04092215	Seal 3.8 x 1.25 nitrile	5 5
5	S04081282	Seal 36.2 x 2.6 nitrile	5 5
6	S04081283	Seal 8 x 1.25 nitrile	5 5
7	S04081285	Seal 10.8 x 1.8 epdm	5 5
8	S04092167	Seal 15 x 1.78 epdm	5 5
9	S04080916	Seal .5 18.5 x 1.2	5 5
10	W000142956	O'ring plasma heads	5 5
11	W000274861	O'ring cpt 800	5 5

## Saf® Switch

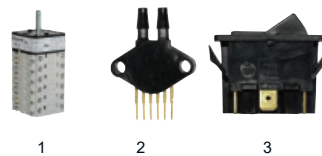

Part No.	Description	Pur.	Pk
1	S04086399	Switch zip 3 position	1 1
2	W000050054	Pressure switch elec. presto/saxo	1 1
3	S00162050	Switch	1 1



# PLASMA

## Saf® Skirt



Part No.	Description	Pur.	Pk
1	W000302517 Skirt c conical z5.0	1	1
2	W000302668 Skirt drag cp4	1	1
3	W000302516 Skirt p flat z5.0	1	1
4	W000050052 Skirt z1/z2	1	1
5	W000302552 Skirt ti40	1	1
6	W000302535 Skirt gouging 120a	1	1
7	W000302672 Skirt gouging cp2.5	5	5
8	W000274225 Skirt tn cpt	1	1
9	W000274226 Skirt tn cpt	1	1
10	S04091209 Skirt cpm15	1	1

## Saf® Torch



Part No.	Description	Pur.	Pk
1	S04081201 Torch cp200 6 m (20 ft)	1	1
2	S04091207 Torch cpm15 7 m (23 ft)	1	1
3	S04091215 Torch cpm15	1	1
4	S04091229 Torch cpm15 nu	1	1
5	S04089312 Torch head/handle z0.5 torch	1	1
6	W000271675 Torch mount insulator zip 2	1	1
7	W000302580 Torch z5.0 6 m (20 ft)	1	1
8	S04089286 Torch head kit z1	1	1
9	W000275097 Torch plasma 30 amp cpt800	1	1
10	W000266529 Torch body jet cp2.5	1	1
11	W000302556 Torch 15 m (50 ft) (cpm100r)	1	1

## Saf® Parts Kit



Part No.	Description	Pur.	Pk
S04089161	Rep parts (zip)	1	1

## Saf® Wrench



Part No.	Description	Pur.	Pk
1	S04091203 Electrode wrench (cpm15)	1	1
2	W000274862 Wrench cpt 800	1	1

## Saf® Spare Parts



Part No.	Description	Pur.	Pk
1	S04081235 Alumina bush (CP200)	1	1
2	92580179 Court bush (SP45)	2	2
3	W000274266 Diffuser cpt	2	2
4	W000050165 Filter air regulator (saxo zip)	1	1
5	W000010168 Freezcool 20 kg	1	1
6	W000325077 Gas vortex 30a 180 amp	1	1
7	S04082169 Guide pads for stand off	5	5
8	S04089225 Guide z5.0	5	5
9	92580391 Lamp system video 24 volts 20 watts	1	1
10	S04082086 Screw pa.5 cm 3 x 3 + washer	5	5
11	S04084015 Transformer h/f nertazip 20/40	1	1
12	S04092154 Tube plunge flat electrode	1	1
13	S04091202 Tube plunger cpm15	1	1
14	S04089287 Handle kit /trigger z1	1	1
15	91490424 Trigger promig 441	1	1

# PLASMA

## Trafimet® A51 Torch



Part No.	Description	Pur.	Pk
BX0020	Trigger	1	1

## Trafimet® A80/A81 Torch

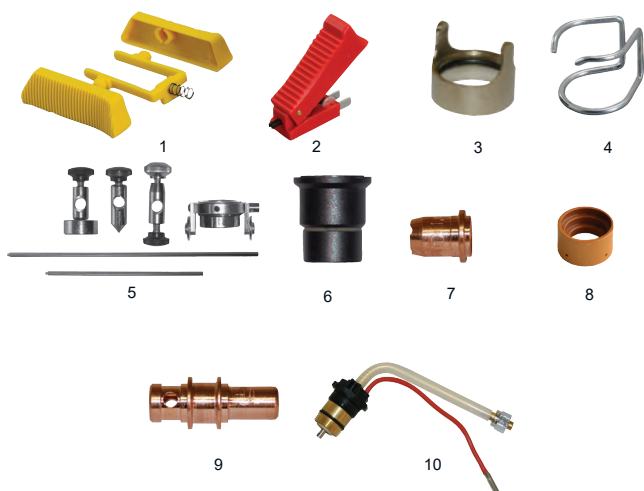

Part No.	Description	Pur.	Pk
1	BW0340	Trigger lock	1 1
2	BX0020	Trigger	1 1
3	CV26	Guide	2 2
4	CV28	Guide spring	2 10
5	CV52	Circle cutting guide	1 2
6	PC115	Nozzle	2 2
7	PD105-12	Tip 1.2 mm (.047")	10 10
8	PE107	Air diffuser	2 2
9	PR109	Electrode	10 10
10	PF140	Torch head	1 1

## Trafimet® A101 Torch

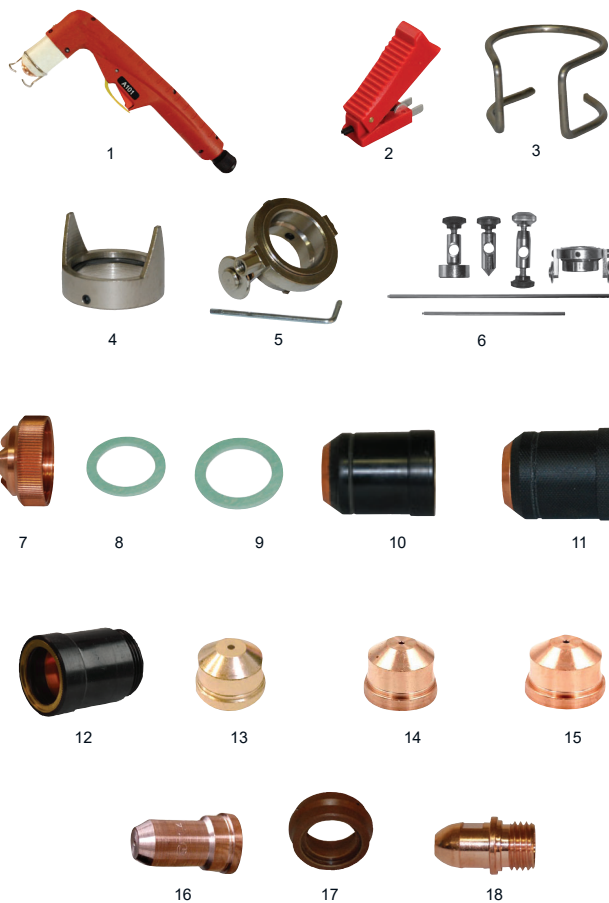

Part No.	Description	Pur.	Pk
1	PF0145	Torch body	1 1
2	BX0020	Trigger	1 1
3	CV11	Stand off guide	1 10
4	CV12	Stand off guide	1 10
5	CV21	Cutting guide	1 1
6	CV22	Circle cutting guide	1 1
7	CV23	Cutting guide - contact	1 10
8	FB1278	Nozzle insulator	1 1
9	FH297	Nozzle insulator	1 1
10	PC109	Nozzle	2 2
11	PC111	Nozzle heavy duty	2 2
12	PC113	Nozzle heavy duty	2 2
13	PD101-11	Tip 1.1 mm (.043")	10 10
14	PD101-14	Tip 1.4 mm (.055")	10 10
15	PD101-17	Tip 1.7 mm (.066")	10 10
16	PD117-14	Tip 1.4 mm (.055")	10 10
17	PE101	Air diffuser	2 2
18	PR101	Electrode	10 10

# PLASMA

## Trafimet® A141 Torch



Part No.	Description	Pur.	Pk
1	PA1500 Torch 6 m (20 ft) m14 x 1	1	1
2	PA1502 Torch 6 m (20 ft) 1/4 gas	1	1
3	PA1504 Torch 6 m (20 ft) cen. adaptor	1	1
4	BX0020 Trigger	1	1
5	CV11 Stand off guide	1	10
6	CV12 Stand off guide	1	10
7	CV21 Cutting guide	1	1
8	CV22 Circle cutting guide	1	1
9	CV23 Cutting guide - contact	1	10
10	FH297 Nozzle insulator	1	1
11	PC101 Nozzle	1	2
12	PC102 Nozzle heavy duty	1	1
13	PD101-11 Tip 1.1 mm (.043")	10	10
14	PD101-14 Tip 1.4 mm (.055")	10	10
15	PD101-17 Tip 1.7 mm (.066")	10	10
16	PD101-19 Tip 1.9 mm (.074")	10	10
17	PD101-30 Tip gouging 3.0 mm (.118")	10	10
18	PD117-14 Tip 1.4 mm (.055")	10	10
19	PE101 Air diffuser	2	2
20	PF155 Torch head	1	1
21	PR101 Electrode	10	10
22	PT220 Torch body kit	1	1

## Trafimet® A151 Torch



Part No.	Description	Pur.	Pk
1	BX0020 Trigger	1	1
2	PD109-14 Tip 1.4 mm (.055") (A151)	1	10

## Trafimet® S45 Torch



Part No.	Description	Pur.	Pk
1	BX0020 Trigger	1	1
2	CV10 Guide spring (S45)	1	10
3	CV24 Cutting guide (S45)	1	1
4	PC116 Nozzle (S45)	4	4
5	PD102-10 Tip 1.0 mm (.039") (S45 / S54)	10	10
6	PD116-08 Tip 20 - 30 amp	1	10
7	PE106 Air diffuser (S45 / S54)	2	2
8	PR105 Electrode (S45 / S54)	10	10
9	PR106 Electrode long (S45 / S54)	10	10
10	PR110 Electrode (S45)	10	10
11	PD103 Tip long (S45)	10	10



## Trafimet® S54 Torch

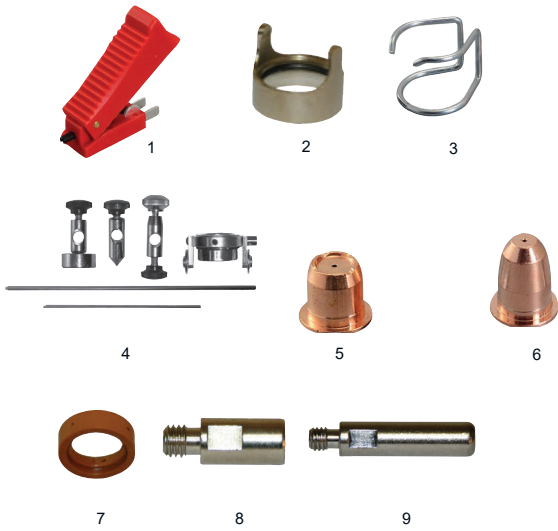

Part No.	Description	Pur.	Pk
1	BX0020	Trigger	1 1
2	CV26	Guide (S54 / S75)	2 2
3	CV28	Guide spring (S54 / S75)	1 10
4	CV52	Circle cutting guide (S54 / S75)	1 1
5	PD102-10	Tip 1.0 mm (.039") (S45 / S54)	10 10
6	PD116-08	Tip 0.8 mm 20 - 30 amp	10 10
7	PE106	Air diffuser (S45 / S54)	2 2
8	PR105	Electrode (S45 / S54)	10 10
9	PR106	Electrode long (S45 / S54)	10 10

## Trafimet® S74/S75 Torch



Part No.	Description	Pur.	Pk
1	BX0020	Trigger	1 1
2	CV26	Guide (S75)	2 2
3	CV28	Guide spring (S75)	1 10
4	CV52	Circle cutting guide (S74/S75)	1 1
5	CV76	Nozzle cap (S75)	10 10
6	FH647	Dip tube (S75)	1 1
7	PC114	Nozzle (S75)	2 2
8	PD114-10	Tip 1.0 mm (.039") (S75)	10 10
9	PD114-12	Tip 1.2 mm (.047") (S75)	10 10
10	PE112	Swirl ring (S75)	1 2
11	PR117	Electrode (S75)	10 10
12	PF135	Torch body (S75)	1 1

# PLASMA

## Trafimet® S105 Torch



Part No.	Description	Pur.	Pk
1	BX0020	Trigger	1 1
2	CV11	Stand off guide	1 10
3	CV12	Stand off guide	2 2
4	CV21	Cutting guide	2 2
5	PE112	Swirl ring	1 2
6	PF136	Torch body	1 1
7	PR117	Electrode	10 10

## Plasma Related Products



Part No.	Description	Pur.	Pk
1	PXM260	Air filter	1 1
2	PXM7230	Element for PXM260 filter	4 4
3	PXOR260	O'ring for PXM260 filter	1 1
4	PX5520A	Inline filter	1 1
5	PX5524	Air line regulator	1 1