

SAFETY SPARE PARTS

Digital Welding Helmet

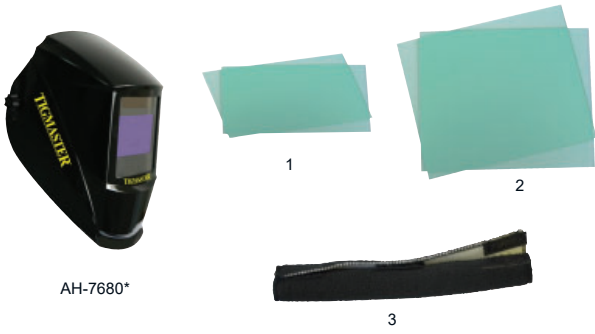

| Part No. | Description | Pur. | Pk |
|----------|---|------|----|
| 1 | TMISCP Inside cover plate 100 x 64 mm (3 15/16" x 2 1/2") (pk of 5) | 1 PK | 5 |
| 2 | TMOSCP Outside cover plate 138 x 120 mm (5 7/16" x 4 3/4") (pk of 5) | 1 PK | 5 |
| 3 | HSD01 Sweatband | 1 | 1 |

* Picture is for reference only

Zephyr Helmet 4000 Spare Parts



| Part No. | Description | Pur. | Pk |
|------------|--------------------|------|----|
| W000260974 | Cell advanced 4000 | 1 | 1 |

Digital Welding Helmet Spare Parts



WH8912*

| Part No. | Description | Pur. | Pk |
|----------|---|------|----|
| PCWH8000 | Outside lens 120 x 99 x 1 mm (pk of 5) | 1 PK | 5 |
| PCWH912 | Inside lens 103.7 x 69.5 x 1 mm (pk of 5) | 1 PK | 5 |

* Picture is for reference only

Welding Helmet Spare Parts



AS-2000F SERIES*



AS-2-F SERIES*



1



2



3

| Part No. | Description | Pur. | Pk |
|----------|---|------|----|
| 1 | PL-2002-O Outer protection lens 90 x 110 | 1 | 1 |
| 2 | PL-2003-I Inner protection lens 103.5 x 47 mm (4 1/16" x 1 7/8") | 1 | 1 |
| 3 | HG-2001 Head gear | 1 | 1 |
| 4 | SWEATBAND Sweatband | 1 | 1 |

MACHINE SPARE PARTS

Chamfer Mill



| Part No. | Description | Pur. | Pk |
|----------|---|------|----|
| 1 | AHAISS Insert set screw | 1 | 1 |
| 2 | AHAPP9130 Insert tip mild steel & stainless steel | 1 | 1 |

Comparc Wire Feeder 309-067



| Part No. | Description | Pur. | Pk |
|----------|---|------|----|
| 1 | MRR0035 Drive roll hard 1.2 - 1.6 mm (.045" - .062") | 1 | 1 |
| | MRR0036 Drive roll aluminium 0.8 - 1.0 mm (.030" - .040") | 1 | 1 |
| | MRR0038 Drive roll aluminium 1.2 - 1.6 mm (.045" - .062") | 1 | 1 |
| | MRR0041 Drive roll knurled 1.6 - 2.4 mm (.062" - 0.1") | 1 | 1 |
| | MRR0042 Drive roll knurled 2.4 - 2.8 mm (0.1" - 1/8") | 1 | 1 |
| 2 | PT1199 PC Board current control | 1 | 1 |

Flux Recovery System LTHJ-SUPER-B2



| Part No. | Description | Pur. | Pk |
|----------|----------------------------|------|----|
| 1 | LTDB80 Filter bag | 1 | 1 |
| 2 | LTFN38 Flux pick-up nozzle | 1 | 1 |
| 3 | LTRH Recovery hose | 1 | 1 |

Carriage Butt/Fillet



- Butt/fillet, multi welder driving on the rigid aluminium rail.
- Magnet on-off switch type rail offers easy in-line adjustment.
- Minimised gear backlash offers various constant speed/adjustable controls.
- Crater fill at the beginning and end of welding.

| Part No. | Description | Pur. | Pk |
|----------|-----------------|------|----|
| RAIL201 | Rail for CS-201 | 1 | 1 |

MACHINE SPARE PARTS

Band Rolls



| Part No. | Description | Pur. | Pk |
|-------------------|---------------------------------------|------|----|
| 1 AFBR40V0.9-1.2 | V Groove 0.9 - 1.2 mm (40 x 32 x 10) | 1 | 1 |
| AFBR40V1.2-1.6 | V Groove 1.2 - 1.6 mm (40 x 32 x 10) | 1 | 1 |
| 2 AFBR40VK0.9-1.2 | VK Groove 0.9 - 1.2 mm (40 x 32 x 10) | 1 | 1 |
| 3 AFBR40U1-1.2 | U Groove 1 - 1.2 mm (40 x 32 x 10) | 1 | 1 |

European Drive Rolls



| Part No. | Description | Pur. | Pk |
|------------------|----------------------------|------|----|
| 1 AFEUV0.9 | V Groove 0.9 mm 6 Hole | 1 | 1 |
| AFEUV1.2 | V Groove 1.2 mm 6 Hole | 1 | 1 |
| 2 AF6HDRV0.9-1.2 | V Groove 0.9-1.2 mm 6 Hole | 1 | 1 |
| 3 AF6HDRVK1.2 | VK Groove 1.2 mm 6 Hole | 1 | 1 |

Cigweld & WIA Feed Rollers



| Part No. | Description | Pur. | Pk |
|----------------|---|------|----|
| 1 62016 | A U Groove 0.8 - 0.9 mm (.030" - .035") | 1 | 1 |
| 62026 | V Groove 0.6 - 1.2 mm (.023" - .045") | 1 | 1 |
| 62189 | V Groove 0.9 - 1.2 mm (.035" - .045") | 1 | 1 |
| 62020 | V Groove 0.6 - 0.8 mm (.025" - .030") | 1 | 1 |
| 62021 | V Groove 0.8 - 1.0 mm (.030" - .040") | 1 | 1 |
| 62022 | V Groove 1.0 - 1.2 mm (.040" - .045") | 1 | 1 |
| 62023 | V Knurl 1.2 - 1.6 mm (.045" - .062") | 1 | 1 |
| 2 62024 | A U Groove 1.0 - 1.2 mm (.040" - .045") | 1 | 1 |
| 62179 | A U Groove 0.8 - 1.0 mm (.030" - .040") | 1 | 1 |
| 62025 | A U Groove 1.2 - 1.6 mm (.045" - .062") | 1 | 1 |
| 62028 | V Knurl 0.8 - 0.9 mm (.030" - .035") | 1 | 1 |
| 3 PX376246-005 | Drive roll kit 1.4 mm (.055") | 1 | 1 |

(L-TEC) (AIRCO) ESAB Drive Roll Cross Over

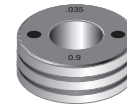

| Part No. | Description | Pur. | Pk |
|--------------------------------|--|------|----|
| <i>V Hard Wire</i> | | | |
| PX9054 | Groove 1 - 0.6 mm (.024") Groove 2 - 0.8 mm (.030") | 1 | 1 |
| PX9055 | Groove 1 - 0.9 mm (.035") Groove 2 - 0.9 mm (.035") | 1 | 1 |
| PX9056 | Groove 1 - 1.2 mm (.045") Groove 2 - 1.2 mm (.045") | 1 | 1 |
| <i>VK Cored Wire</i> | | | |
| PX9057 | Groove 1 - 0.8 - 0.9 mm (.030" - .035") Groove 2 - 0.8 - 0.9 mm (.030" - .035") | 1 | 1 |
| PX9058 | Groove 1 - 1.2 mm (.045") Groove 2 - 1.2 mm (.045") | 1 | 1 |
| PX9059 | Groove 1 & 2 - 1.3 mm - 1.6 mm (.052"-1/16") | 1 | 1 |
| <i>U Groove Aluminium Wire</i> | | | |
| PX9060 | Groove 1 - 0.8 mm (.030") Groove 2 - 0.9 mm (.035") | 1 | 1 |
| PX9061 | Groove 1 - 0.9 mm (.035") Groove 2 - 1.2 mm (3/64") | 1 | 1 |
| PX9062 | Groove 1 - 1.0 (.040") Groove 2 - 1.2 mm (.045") | 1 | 1 |
| PX9063 | Groove 1 - 1.2 (.045") Groove 2 - 1.6 mm (1/16") | 1 | 1 |

KEMPPI Drive Rolls

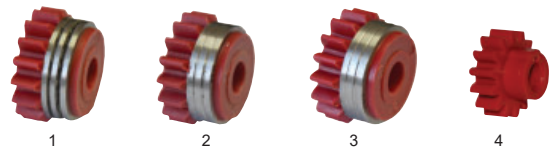

| Part No. | Description | Pur. | Pk |
|------------------|--|------|----|
| 1 AFKEMVK0.9-1.2 | Knurled 0.9 - 1.2 mm | 1 | 1 |
| AFKEMVK1.2-1.6 | Knurled 1.2 - 1.6 mm | 1 | 1 |
| 2 AFKEMV0.6-0.8 | V Groove 0.6 - 0.8 mm | 1 | 1 |
| AFKEMV0.9-1.0 | V Groove 0.9 - 1.0 mm | 1 | 1 |
| AFKEMV0.9-1.2 | V Groove 0.9 - 1.2 mm | 1 | 1 |
| AFKEMV1.2-1.6 | V Groove 1.2 - 1.6 mm | 1 | 1 |
| 3 AFKEMU0.9-1.2 | U Groove 0.9 - 1.2 mm | 1 | 1 |
| AFKEMU1.0-1.2 | U Groove 1.0 - 1.2 mm | 1 | 1 |
| 4 AFKEMDRG | Drive roll gear | 1 | 1 |
| AFKSV.9 | Drive roll single V 0.9 mm set white | 1 | 1 |
| AFKSV1 | Drive roll single V 1.0 mm set red | 1 | 1 |
| AFKSV1.2 | Drive roll single V 1.2 mm set orange | 1 | 1 |
| AFKSVK1.2 | Drive roll single V knurled 1.2 set orange | 1 | 1 |
| AFKSVK1.6 | Drive roll single V knurled 1.6 set yellow | 1 | 1 |
| AFKSU1 | Drive roll single U 1.0 mm set red | 1 | 1 |
| AFKSU1.2 | Drive roll single U 1.2 mm set orange | 1 | 1 |

MACHINE SPARE PARTS

ARC 140 Machine Spare Parts

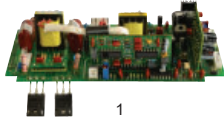

1

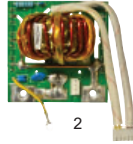

2



3



4



5



6

| Part No. | Description | Pur. | Pk |
|----------|-----------------------------|------|----|
| 1 | B01400 PC board top | 1 | 1 |
| 2 | B02086 PC board centre | 1 | 1 |
| 3 | B03095 PC board capacitor | 1 | 1 |
| 4 | 10037797 Fan small 220 volt | 1 | 1 |
| 5 | J10154 Front panel 140 | 1 | 1 |
| 6 | J06133 Rear panel | 1 | 1 |

ARC 170 Machine Spare Parts

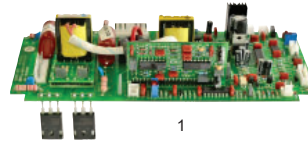

1



2



3



4



5

| Part No. | Description | Pur. | Pk |
|----------|------------------------|------|----|
| 1 | 10000260 PC board top | 1 | 1 |
| 2 | B02091 PC board centre | 1 | 1 |
| 3 | B03102 PC board bottom | 1 | 1 |
| 4 | 10013258 Rear panel | 1 | 1 |
| 5 | 10014744 Front panel | 1 | 1 |

MIG 250 Machine Spare Parts



1



2



3



4



5



| Part No. | Description | Pur. | Pk |
|----------|---|------|----|
| 1 | S081400 Spool adaptor 200 - 300 mm (8" - 12") | 1 | 1 |
| 2 | B03071 PC board filter | 1 | 1 |
| 3 | B04083 PC board control inverter | 1 | 1 |
| 4 | 10003832 Central euro connector | 1 | 1 |
| 5 | 10007283 Gas solenoid | 1 | 1 |

MACHINE SPARE PARTS

MIG 250SWF Machine Spare Parts

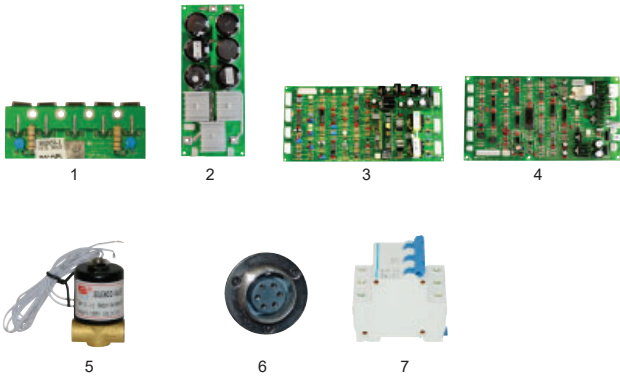

| Part No. | Description | Pur. | Pk |
|----------|-------------|---------------------------|-----|
| 1 | B02056-1 | PC board 2nd inverter | 1 1 |
| 2 | B03115 | PC board filter | 1 1 |
| 3 | B04026 | PC board control | 1 1 |
| 4 | B06034 | PC board wire feed | 1 1 |
| 5 | 10001346 | Gas solenoid | 1 1 |
| 6 | 10004686 | 6 Pin female panel socket | 1 1 |
| 7 | 10004926 | Main switch | 1 1 |

MIG 350SWF Machine Spare Parts

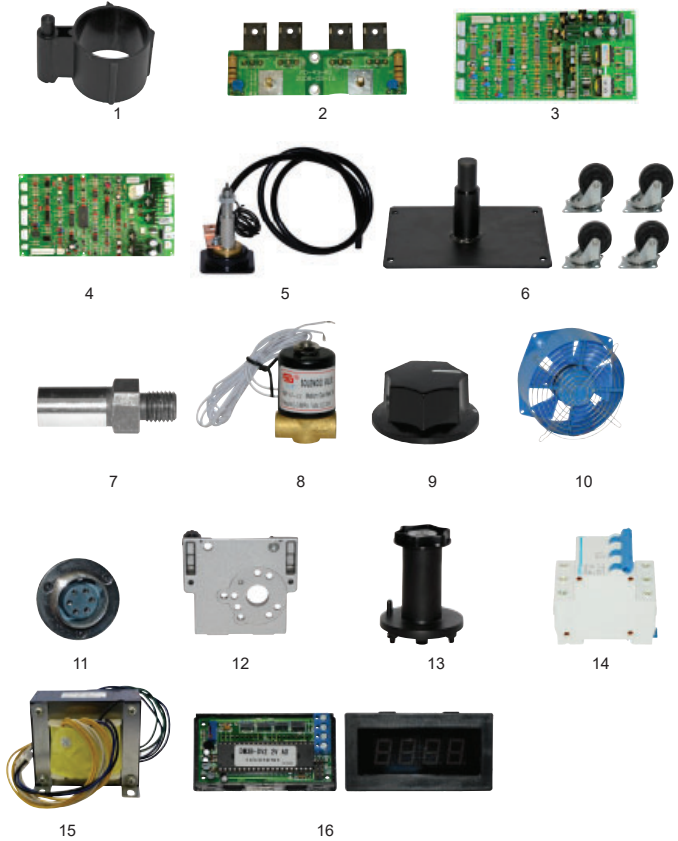

| Part No. | Description | Pur. | Pk |
|----------|-------------|---------------------------------------|-----|
| 1 | S081400 | Spool adaptor 200 - 300 mm (8" - 12") | 1 1 |
| 2 | B02079 | PC board 2nd inverter | 1 1 |
| 3 | B04089 | PC board power control | 1 1 |
| 4 | B06105 | PC board control | 1 1 |
| 5 | 10004709 | Euro block | 1 1 |
| 6 | SWFCK | Caster kit | 1 1 |
| 7 | JZ4WDAXLE | Drive axle 4WD feeder | 1 1 |
| 8 | 10001346 | Gas solenoid | 1 1 |
| 9 | VK350 | Knob voltage 350 | 1 1 |
| 10 | 10007306 | Fan motor | 1 1 |
| 11 | 10004686 | 6 Pin female panel socket | 1 1 |
| 12 | J4WDPAK | Jasic feeder pressure arm & dial | 1 1 |
| 13 | 10033788 | Spool holder L/H | 1 1 |
| 14 | 10004925 | Main switch 350 & 500SWF | 1 1 |
| 15 | 10020673 | Control transformer | 1 1 |
| 16 | D20048 | Voltmeter digital | 1 1 |
| n/s | 10060951 | Pressure arm - top | 1 1 |
| n/s | 10060952 | Adaptor, central | 1 1 |
| n/s | 10052078 | Wire feeder motor | 1 1 |
| n/s | 10006045 | Aux transformer | 1 1 |

MACHINE SPARE PARTS

MIG 500SWF Machine Spare Parts

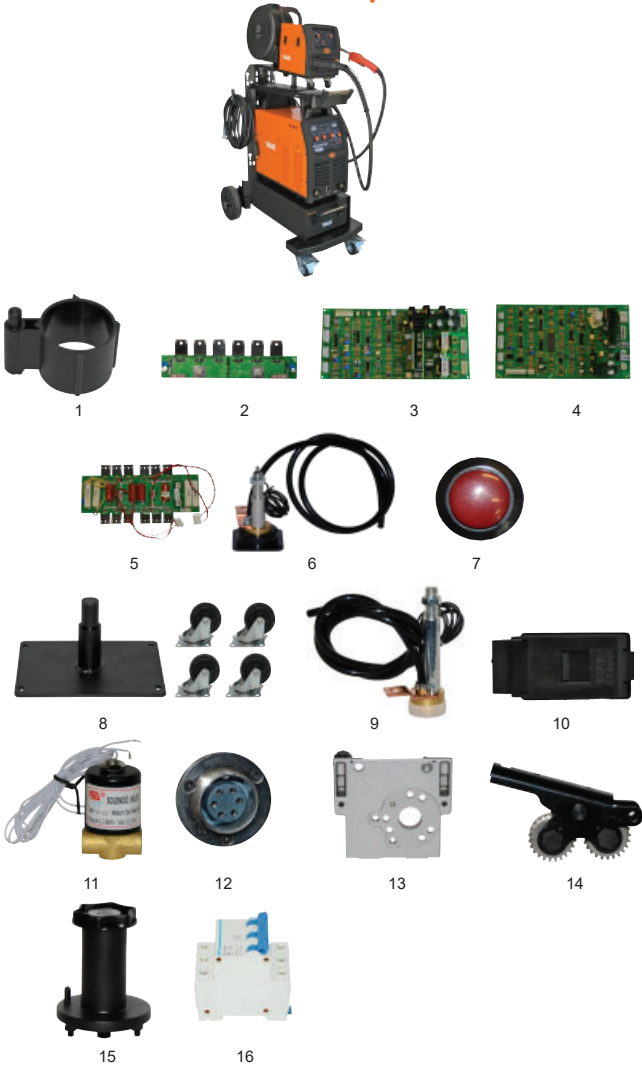

| Part No. | Description | Pur. | Pk |
|----------|---|------|----|
| 1 | S081400 Spool adaptor 200 - 300 mm (8" - 12") | 1 | 1 |
| 2 | B02096 PC board 2nd inverter | 1 | 1 |
| 3 | 10052281 PC board control | 1 | 1 |
| 4 | 10058536 PC board B04110 PC board wire feeder | 1 | 1 |
| 5 | B16039 PC board inverter | 1 | 1 |
| 6 | 10004709 Euro block | 1 | 1 |
| 7 | 10052042 Inch button | 1 | 1 |
| 8 | SWFCK Caster kit | 1 | 1 |
| 9 | 10054664 Central euro connect | 1 | 1 |
| 10 | DOOR LATCH 500SWF Door latch | 1 | 1 |
| 11 | 10001346 Gas solenoid | 1 | 1 |
| 12 | 10004686 6 Pin female panel socket | 1 | 1 |
| 13 | J4WDPK Feeder pressure arm & dial | 1 | 1 |
| 14 | 10060951 Pressure arm - top | 1 | 1 |
| 15 | 10033788 Spool holder L/H | 1 | 1 |
| 16 | 10004925 Main switch 350 & 500SWF | 1 | 1 |
| n/s | 10000849 Board | 1 | 1 |
| n/s | 10006032 Transformer | 1 | 1 |
| n/s | 10020669 Transformer | 1 | 1 |
| n/s | 10060952 Adaptor, central | 1 | 1 |
| n/s | 10006045 Aux transformer | 1 | 1 |

Parts suits All Jasic Separate Wire Feeders

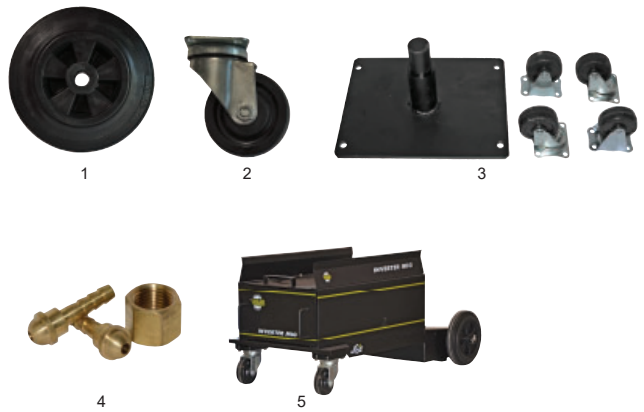

| Part No. | Description | Pur. | Pk |
|----------|--|-------|----|
| 1 | 350BACKWHEELS Back wheels (1 pair of 2 wheels) | 1 PR | 2 |
| 2 | 350WHEELS Wheels (1 set of 4 wheels) | 1 SET | 4 |
| 3 | SWF WHEEL KIT Jasic SWF wheel kit | 1 | 1 |
| 4 | SWFJAGASNUT Gas connect SWFNUTNIPPLE Gas fitting | 1 | 1 |
| 5 | IWSSWFT Trolley with drawer suits all Jasic separate wire feeder | 1 | 1 |
| n/s | 10026150 Wire feed motor | 1 | 1 |

Feed Rolls suits MIG 190, MIG 250, MIG 250SWF, MIG 350SWF & MIG 500SWF

| Part No. | Description | Pur. | Pk |
|---------------------|----------------------------|------|----|
| JSC0.8-0.9 | 0.8 - 0.9 mm (.030"-.035") | 1 | 1 |
| JSC0.9-1.2 | 0.9 - 1.2 mm (.035"-.045") | 1 | 1 |
| JSC1.0-1.2 | 1.0 - 1.2 mm (.040"-.045") | 1 | 1 |
| JSC1.2-1.6 | 1.2 - 1.6 mm (.045"-.062") | 1 | 1 |
| Knurled Flux Cored | | | |
| JSU0.8-1.0 | 0.8 - 1.0 mm (.030"-.040") | 1 | 1 |
| JSU0.9-1.0 | 0.9 - 1.0 mm (.035"-.040") | 1 | 1 |
| JSU0.9-1.2 | 0.9 - 1.2 mm (.035"-.045") | 1 | 1 |
| JSU1.0-1.2 | 1.0 - 1.2 mm (.040"-.045") | 1 | 1 |
| U Groove Soft Wire | | | |
| JSV0.6-0.8 | 0.6 - 0.8 mm (.025"-.030") | 1 | 1 |
| JSV0.8-1.0 | 0.8 - 1.0 mm (.030"-.040") | 1 | 1 |
| JSV0.9-1.0 | 0.9 - 1.0 mm (.035"-.040") | 1 | 1 |
| JSV0.9-1.2 | 0.9 - 1.2 mm (.035"-.045") | 1 | 1 |
| JSV1.0-1.2 | 1.0 - 1.2 mm (.040"-.045") | 1 | 1 |
| JSV1.2-1.6 | 1.2 - 1.6 mm (.045"-.062") | 1 | 1 |
| V Groove Solid Wire | | | |

MACHINE SPARE PARTS

TIG 180 Machine Spare Parts



1



2



3



4



5



6



7

| Part No. | Description | Pur. | Pk |
|----------|-------------|--------------------------------------|-----|
| 1 | 10000413 | PC board bottom TIG IWS180 | 1 1 |
| 2 | B04023 | PC board Torch switch IWS180 (2T/4T) | 1 1 |
| 3 | 10000291 | PC board centre | 1 1 |
| 4 | 10000243 | PC board top | 1 1 |
| 5 | RPC180 | Rear plastic case IWS180 | 1 1 |
| 6 | J06004-1 | Rear cover IWS180 | 1 1 |
| 7 | SH180 | Strap holder | 1 1 |
| n/s | 10001317 | Gas solenoid | 1 1 |
| n/s | 10004684 | 2 Pin panel receptacle | 1 1 |
| n/s | 10004685 | 5 Pin panel receptacle | 1 1 |

TIG 200AC/DC Machine Spare Parts



1



2



3



4

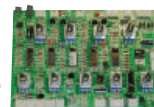

5



6



7



8

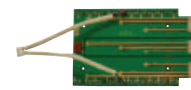

9



10



11



12



13

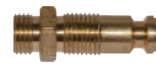

14



15

| Part No. | Description | Pur. | Pk |
|----------|-------------|---------------------------------------|-----|
| 1 | 10000628 | PC board front control | 1 1 |
| 2 | 10001955 | PC board 2nd stage inverter (B16008) | 1 1 |
| 3 | B01160 | PC board top | 1 1 |
| 4 | 10000497 | PC board | 1 1 |
| 5 | B04046 | PC board panel control | 1 1 |
| 6 | B04045 | PC board | 1 1 |
| 7 | B04290 | PC board front control | 1 1 |
| 8 | B05003 | PC board small | 1 1 |
| 9 | B16061 | Secondary inverter plate | 1 1 |
| 10 | 10042994 | Control front panel | 1 1 |
| 11 | D28078 | Fan 220 - 240 volt | 1 1 |
| 12 | IWSFC | Foot control | 1 1 |
| 13 | 10007279 | Solenoid 240 volt AC | 1 1 |
| 14 | 10027490 | Male QR fitting solenoid (M10 thread) | 1 1 |
| 15 | C16001 | Main switch | 1 1 |
| n/s | B06106 | PC board switch | 1 1 |
| n/s | 10004684 | 2 Pin panel receptacle | 1 1 |
| n/s | 10004685 | 5 Pin panel receptacle | 1 1 |

MACHINE SPARE PARTS

TIG 315ACDC Machine Spare Parts

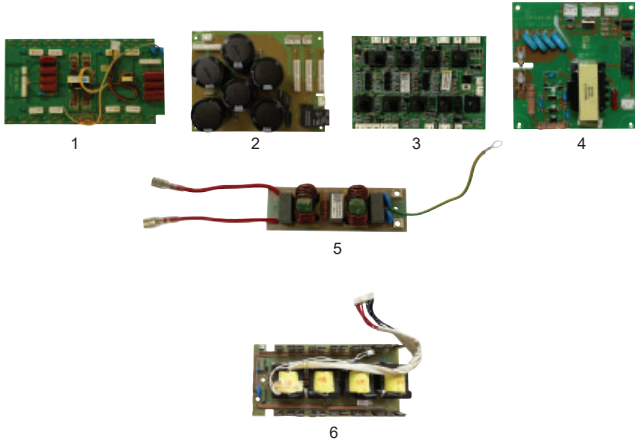

| Part No. | Description | Pur. | Pk | |
|----------|-------------|------------------------|----|---|
| 1 | 10000213 | PC board top B01155 | 1 | 1 |
| 2 | 10000409 | PC board bottom | 1 | 1 |
| 3 | 10000628 | PC board front control | 1 | 1 |
| 4 | 10000934 | PC board | 1 | 1 |
| 5 | 10000928 | PCB switch filter | 1 | 1 |
| 6 | 10000358 | Transformer middle PCB | 1 | 1 |
| n/s | 10004684 | 2 Pin panel receptacle | 1 | 1 |
| n/s | 10004685 | 5 Pin panel receptacle | 1 | 1 |
| n/s | 10004935 | Main power switch | 1 | 1 |

Tractor Sub Arc Spare Parts



| Part No. | Description | Pur. | Pk | |
|----------|-------------|------------------------------|----|---|
| n/s | 10035669 | Sub arc control cable 10 pin | 1 | 1 |

MACHINE SPARE PARTS

Gears



| Part No. | Description | Pur. | Pk |
|-----------------|----------------------------|------|----|
| 30MM 30/22 | Gear to suit 30/22 roller | 1 | 1 |
| 30MM GEAR 4WD | Gear 30 mm suits Jasic 4WD | 1 | 1 |
| 30MM GEAR WHEEL | Gear 30 mm suits Jasic 2WD | 1 | 1 |

Key



| Part No. | Description | Pur. | Pk |
|----------|-----------------------|------|----|
| WOODRUFF | 1/2 Moon woodruff key | 1 | 1 |

Plug



| Part No. | Description | Pur. | Pk |
|----------|-------------|------|----|
| C030023 | Plug 2 pin | 1 | 1 |
| JSRC3 | Plug 3 pin | 1 | 1 |
| JS5PP | Plug 5 pin | 1 | 1 |
| 10004664 | Plug 4 pin | 1 | 1 |

Potentiometer



| Part No. | Description | Pur. | Pk |
|--------------|---------------------------------|------|----|
| 1 C14001 | Knob for C14004 pot | 1 | 1 |
| 2 C14004 | 1K Pot suits Jasic 160 | 1 | 1 |
| 3 D15102 | Potentiometer suits Mig 175-250 | 1 | 1 |
| n/s 10020750 | Potentiometer wire speed | 1 | 1 |

Quick Connect/Nipples

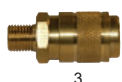
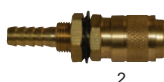

| Part No. | Description | Pur. | Pk |
|------------|---|------|----|
| 1 B0088AT | Jasic QR male | 1 | 1 |
| 2 10016391 | Quick connector gas inlet | 1 | 1 |
| 3 10016407 | Quick connector male thread (M10 thread) | 1 | 1 |
| 4 10042646 | Quick connect gas outlet 8 mm (5/16 inch) | 1 | 1 |

Solenoid



| Part No. | Description | Pur. | Pk |
|----------|---------------------|------|----|
| 10007277 | Solenoid 24 volt DC | 1 | 1 |

Spool Holder



| Part No. | Description | Pur. | Pk |
|------------|---------------------|------|----|
| 1 10016512 | WF spool holder | 1 | 1 |
| 2 10033788 | Spool holder 3 bolt | 1 | 1 |

Switch



| Part No. | Description | Pur. | Pk |
|----------|-----------------------|------|----|
| JSTOG | Toggle switch 160/180 | 1 | 1 |

Transformer



| Part No. | Description | Pur. | Pk |
|----------|--------------------------------|------|----|
| JSY-6136 | Jasic AUX TX NRE 6136 10001030 | 1 | 1 |

MACHINE SPARE PARTS

Finger Tip Control

Fingertip control with 8.2 m (27') & 15.8 m (52') cord and 6 pin plug compatible with Precision Tig, Squareware Tig & Invertec only.



| Part No. | Description | Pur. | Pk |
|-----------|---|------|----|
| LFTC6 | Fingertip control with 8.2 m (27') cord & 6 pin plug | 1 | 1 |
| LFTC-6-52 | Fingertip control with 15.8 m (52') cord & 6 pin plug | 1 | 1 |

Foot Control

Operates contactor and controls output.

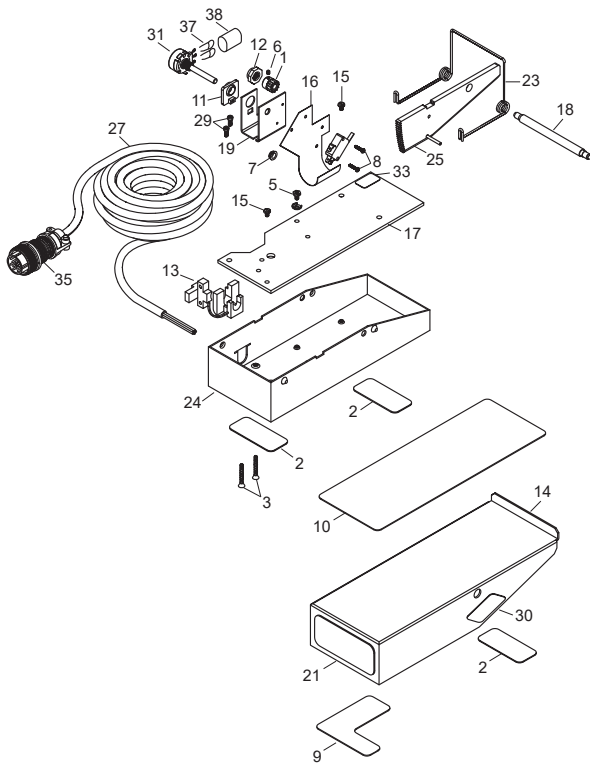

| Part No. | Description | Pur. | Pk |
|----------|--|------|----|
| LFC870 | Foot control 7.6 m (25') cord | 1 | 1 |
| 1 | PX9340 Pinion gear | 1 | 1 |
| 2 | 9341 Rubber base pad | 1 | 1 |
| 3 | 9342 Screw #8 -10 x 31.8 mm (1.250") | 10 | 10 |
| 4 | PX9343 Micro switch | 1 | 1 |
| 5 | 9344 Screw #8-32 x 7.1 mm (0.281") | 10 | 10 |
| 6 | 9345 Screw #6-32 x 4.8 mm (.1875") | 10 | 10 |
| 7 | 9346 Nylon bearing | 1 | 1 |
| 8 | 9347 Screw #4-40 x 12.7 mm (.500") | 10 | 10 |
| 9 | 9348 Rubber bumper pad | 1 | 1 |
| 10 | 9349 Rubber foot pad | 1 | 1 |
| 11 | 9350 Mount bracket | 1 | 1 |
| 12 | PX9351 Spacer nut | 1 | 1 |
| 13 | 9352 Cable clamp | 1 | 1 |
| 14 | 9353 Top cover | 1 | 1 |
| 15 | 9354 Screw #8-32 x 6.4 mm (.250") | 10 | 10 |
| 16 | 9355 Insulation | 1 | 1 |
| 17 | 9356 Inner plate | 1 | 1 |
| 18 | 9357 Pivot rod assembly | 1 | 1 |
| 19 | 9358 Potentiometer bracket | 1 | 1 |
| 21 | 9360 Name plate LFC-870 | 1 | 1 |
| 23 | PX9361 Foot control spring | 1 | 1 |
| 24 | 9362 Base | 1 | 1 |
| 25 | 9363 Spur gear lever | 1 | 1 |
| 27 | 9365 Cord with 6 pin plug 7.6 m (25') | 1 | 1 |
| 29 | 9366 Screw #8-32 x 9.5 mm (.375") | 10 | 10 |
| 30 | 9367 Warning label | 1 | 1 |
| 31 | PX9368 Potentiometer 10K for 1T, 2W, LFC-870/ EFC-14 | 1 | 1 |
| 33 | 9370 Warning label | 1 | 1 |
| 35 | 9219 Lincoln 6 pin plug only | 1 | 1 |
| 37 | 9371 Capacitor 4700VF, 3KV | 1 | 1 |
| 38 | 9372 Heat shrink tubing 44.4 mm (1-3/4") | 1 | 1 |

Extension Cord



An extension cord extends the distance between equipment, allowing the equipment to be used at a further distance from the power source. The connectors will mate to each other.

| Part No. | Description | Pur. | Pk |
|------------|--|------|----|
| PXK1797-25 | 7.6 m (25') 14 pin to 14 skt extends between the 14 socket receptacle on the power source & the wire feeder control cord | 1 | 1 |

Interconnecting Cord

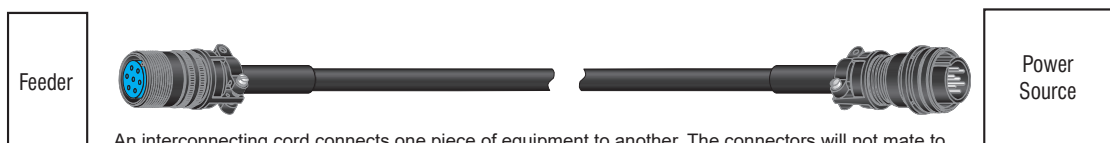

An interconnecting cord connects one piece of equipment to another. The connectors will not mate to each other.

| Part No. | Description | Pur. | Pk |
|------------|--|------|----|
| PXK1543-25 | 7.6 m (25') 5 pin to 5 socket, Control cable for Powerwave® to Power Feed® systems. Arclink® | 1 | 1 |

MACHINE SPARE PARTS

Meters



1



2

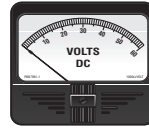

3



4

| Part No. | Description | Pur. | Pk |
|----------|---|------|----|
| 1 | PXM10486-3 Voltmeter 76.2 mm (3") DC 0-60 | 1 | 1 |
| 2 | PXM15539-2 Ammeter 88.9 mm (3½") DC 0-600 | 1 | 1 |

| Part No. | Description | Pur. | Pk |
|----------|--|------|----|
| 3 | PXM7980-2 Ammeter 114.3 mm (4½") DC 0-1500 | 1 | 1 |
| | PXM7981-1 Voltmeter 114.3 mm (4½") DC 0-60 | 1 | 1 |
| 4 | PXT15134 Voltmeter 63.5 mm (2½") DC 0-40 | 1 | 1 |

Diamond Brush Seater



| Part No. | Description | Pur. | Pk |
|----------|----------------------|------|----|
| DD114 | Diamond brush seater | 1 | 1 |

Plugs with Pins



1

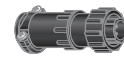

2

| Part No. | Description | Pur. | Pk |
|----------|--|------|----|
| 1 | PXS12020-3 4 Pin plug (NA3, 4, 5) | 1 | 1 |
| | PXS12020-6 5 Pin plug (LN7, 8, 9, 25, SP200) | 1 | 1 |
| | PXS12020-16 3 Pin plug (NA3, 4, 5) | 1 | 1 |
| | PXS12020-27 6 Pin plug (K857, TIG) | 1 | 1 |
| | PXS12020-32 14 Pin plug (CV power sources) | 1 | 1 |
| 2 | PXS18656 4 Pin trigger plug (wirematic) | 1 | 1 |

Pressure Arm

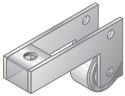

| Part No. | Description | Pur. | Pk |
|----------|---------------------------------|------|----|
| PXS12475 | Pressure arm for all wire types | 1 | 1 |

Plugs with Sockets



| Part No. | Description | Pur. | Pk |
|-------------|---------------------------------------|------|----|
| PXS12020-8 | 9 Pin socket plug (LN8, 9, NA3, 4, 5) | 1 | 1 |
| PXS12020-26 | 6 Pin socket plug (LN7) | 1 | 1 |

Receptacles with Sockets



1



2

| Part No. | Description | Pur. | Pk |
|----------|---|------|----|
| 1 | PXS12021-3 5 Pin socket panel (LN7, 8, 9, 25 SP200) | 1 | 1 |
| | PXS12021-16 5 Pin socket panel (NA3, 4) | 1 | 1 |
| | PXS12021-17 3 Pin socket panel (NA3, 4, 5) | 1 | 1 |
| | PXS12021-18 4 Pin socket panel (NA5) | 1 | 1 |
| | PXS12021-40 14 Pin socket panel (CV power sources) | 1 | 1 |
| 2 | PXS12023-8 3 Pin socket receptacle | 1 | 1 |
| | PXS12023-10 4 Pin socket receptacle | 1 | 1 |
| | PXS12023-15 14 Pin socket receptacle | 1 | 1 |

Receptacles with Pins



| Part No. | Description | Pur. | Pk |
|------------|------------------|------|----|
| PXS12023-2 | 9 Pin receptacle | 1 | 1 |

Rheostats

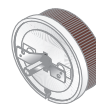

1



2

| Part No. | Description | Pur. | Pk |
|----------|-------------------------------------|------|----|
| 1 | M5090-C 64 OHM rheostat | 1 | 1 |
| 2 | PXT10812-40 Potentiometer 10K-1T-2W | 1 | 1 |

MACHINE SPARE PARTS

Remote Hand Control



1

Suits all Lincoln equipment that uses the M5090C (64 ohm) rheostat.
SA200 GAS, SA250 GAS & DIESEL, SAE300, SAE350 DIESEL, SAE400 GAS & DIESEL, SAE500, CLASSIC I, II & III, CLASSIC 300D, PIPE LINER 200D.



2

Suits all Lincoln equipment that uses the 75 - 76 - 77 terminal strip remote control connections.
AC1200, DC400, DC600, DC1000, DC1500, R3R-300, 400 & 500.



3

Suits all Lincoln equipment that uses 6 pin remote control receptacle.
CV305, CV400, FLEXTEC450, FLEXTEC650, INVERTEC, V205T, V275S, V310T, V350PRO, V450PRO, IDEALARC R3R-400, 500, DC400, DC600, DC1000, DC1500, AC1200, POWERMIG350MP, PRECISION TIG 225, 275, 375, MULTIWELD 350, RANGER 250, 250GXT, 305, 305G & D, VANTAGE 300, 400, 500, POWERWAVE 355

| Part No. | Description | Pur. | Pk |
|--------------|--|------|----|
| 1 PXLHC | Remote hand control without cord | 1 | 1 |
| LHC-1 | Remote hand control 0.3 m (1') cord | 1 | 1 |
| LHC25 | Remote hand control 7.6 m (25') cord | 1 | 1 |
| LHC50 | Remote hand control 15.2 m (50') cord | 1 | 1 |
| LHC-100 | Remote hand control 30.4 m (100') cord | 1 | 1 |
| 2 PXLHC775 | Remote hand control without cord | 1 | 1 |
| LHC-775-25 | Remote hand control 7.6 m (25') cord | 1 | 1 |
| LHC-775-50 | Remote hand control 15.2 m (50') cord | 1 | 1 |
| PXLHC775-100 | Remote hand control 30.4 m (100') cord | 1 | 1 |

| Part No. | Description | Pur. | Pk |
|-------------|--|------|----|
| 3 LHC-857 | Remote hand control without cord | 1 | 1 |
| LHC-857-1 | Remote hand control 0.3 m (1') cord | 1 | 1 |
| LHC-857-25 | Remote hand control 7.6 m (25') cord | 1 | 1 |
| LHC-857-50 | Remote hand control 15.2 m (50') cord | 1 | 1 |
| LHC-857-100 | Remote hand control 30.4 m (100') cord | 1 | 1 |

Remote Start Switch



| Part No. | Description | Pur. | Pk |
|-----------|---------------------------------|------|----|
| PXRSLN-15 | Remote start switch 4.5 m (15') | 1 | 1 |
| PXRSLN-25 | Remote start switch 7.6 m (25') | 1 | 1 |

Switch Assemblies Tig Arc Start



1

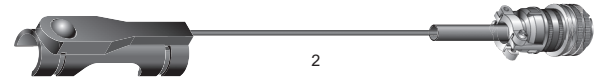

2

| Part No. | Description | Pur. | Pk |
|----------|--|------|----|
| 1 PX9666 | 8.2 m (27') momentary switch, 6 pin plug suits TM9, 17, 20 torches with small clip on holder | 1 | 1 |
| 2 PX9676 | 8.2 m (27') momentary switch, 6 pin plug suits TM18 & 26 torches with large clip on holder | 1 | 1 |

Sensor Lead



| Part No. | Description | Pur. | Pk |
|------------|-------------------------|------|----|
| PXS17211-1 | Sensor lead 5.1 m (17') | 1 | 1 |

Switch OFF/ON

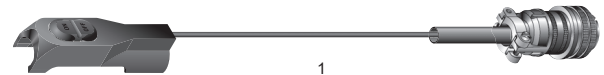

1

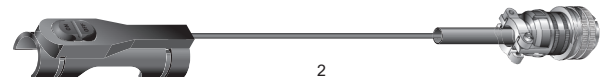

2

| Part No. | Description | Pur. | Pk |
|----------|---|------|----|
| 1 PX9703 | 8.2 m (27') off/on switch, 6 pin plug suits TM9, 17, 20 torches with small clip on holder | 1 | 1 |
| 2 PX9705 | 8.2 m (27') off/on switch, 6 pin plug suits TM18 & 26 torches with large clip on holder | 1 | 1 |

Spindle Adaptor



| Part No. | Description | Pur. | Pk |
|----------|-----------------|------|----|
| PXK435 | Spindle adaptor | 1 | 1 |

Stud Assembly

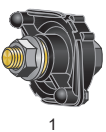

1

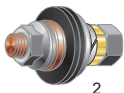

2

| Part No. | Description | Pur. | Pk |
|--------------|---------------------------------------|------|----|
| 1 PXT14166-9 | Stud assembly | 1 | 1 |
| 2 S11125-1 | Stud assembly length 41.2 mm (2-3/8') | 1 | 1 |

Trigger Adaptor Cord



| Part No. | Description | Pur. | Pk |
|----------|--|------|----|
| PX202692 | Trigger adaptor Miller 4 pin and Lincoln 2 pin | 1 | 1 |

MACHINE SPARE PARTS

Two Roll Kits

For Power MIG 140C, 140T, 180C, 180T, 200, 215, 255, 255C, 300 & 350MP, LN-15, LN-25 Pro, Power Feed 15M & LF-72



Kit consists of two drive rolls and one guide.

| Part No. | Wire Size | Wire Type |
|---------------|------------------------------|---------------|
| PXKP1696-030S | 0.6 - 0.8 mm (.023" - .030") | Solid |
| PXKP1696-035S | 0.9 mm (.035") | Solid |
| PXKP1696-045S | 1.0 - 1.2 mm (.040" - .045") | Solid |
| PXKP1696-052S | 1.3 mm (.052") | Solid |
| PXKP1696-116S | 1.6 mm (1/16") | Solid |
| PXKP1697-035C | 0.9 mm (.035") | Cored |
| PXKP1697-045C | 1.2 mm (.045") | Cored |
| PXKP1697-052C | 1.3 mm (.052") | Cored |
| PXKP1697-116C | 1.6 mm (1/16") | Cored |
| PXKP1697-068 | 1.7 - 1.8 mm (.068" - .072") | Cored & Solid |
| PXKP1697-564 | 2.0 mm (5/64") | Cored & Solid |
| PXKP1697-332 | 2.4 mm (3/32") | Cored & Solid |

2 Roll Solid Drive Roll Kit



Contains 2 Drive Rolls and 1 Guide

| Part No. | Description | Pur. | Pk |
|---------------|---|------|----|
| PXKP1696-035S | 0.9 mm (.035") Solid drive roll | 1 | 1 |
| PXKP1696-045S | 1.0 - 1.2 mm (.040" - .045") Solid drive roll | 1 | 1 |
| PXKP1696-052S | 1.3 mm (.052") Solid drive roll | 1 | 1 |
| PXKP1696-116S | 1.6 mm (1/16") Solid drive roll | 1 | 1 |

2 Roll Cored & Solid Drive Roll Kit



Contains 2 Drive Rolls and 1 Guide

| Part No. | Description | Pur. | Pk |
|--------------|---|------|----|
| PXKP1697-068 | 1.7 - 1.8 mm (.068") Cored & solid drive roll | 1 | 1 |
| PXKP1697-332 | 2.4 mm (3/32") Cored & solid drive roll | 1 | 1 |
| PXKP1697-564 | 2.0 mm (5/64") Cored & solid drive roll | 1 | 1 |

2 Roll Cored Drive Roll Kit



Contains 2 Drive Rolls and 1 Guide

| Part No. | Description | Pur. | Pk |
|---------------|---------------------------------|------|----|
| PXKP1697-035C | 0.9 mm (.035") Cored drive roll | 1 | 1 |
| PXKP1697-045C | 1.2 mm (.045") Cored drive roll | 1 | 1 |
| PXKP1697-052C | 1.3 mm (.052") Cored drive roll | 1 | 1 |
| PXKP1697-116C | 1.6 mm (1/16") Cored drive roll | 1 | 1 |

Aluminium Drive Roll Kit



| Part No. | Description | Pur. | Pk |
|---------------|-----------------------------------|------|----|
| LKP1695-1/16A | 1.6 mm (1/16") Aluminium LN25 PRO | 1 | 1 |
| LKP654-1/16A | 1.6 mm (1/16") Aluminium LN25 PRO | 1 | 1 |

MACHINE SPARE PARTS

Four Roll Kits

For LN-10, DH-10, STT-10, Power Feed 10, 10M, 10R, Power Feed 10 Dual, Power Feed 11 & LF-74



Kit consists of four drive rolls and one guide.

| Part No. | Wire Size | Wire Type |
|---------------|------------------------------|---------------|
| PXKP1505-030S | 0.6 - 0.8 mm (.023" - .030") | Solid |
| PXKP1505-035S | 0.9 mm (.035") | Solid |
| PXKP1505-045S | 1.0 - 1.2 mm (.040" - .045") | Solid |
| PXKP1505-052S | 1.3 mm (.052") | Solid |
| PXKP1505-116S | 1.6 mm (1/16") | Solid |
| PXKP1505-035C | 0.8 - 0.9 mm (.030" - .035") | Cored |
| PXKP1505-045C | 1.0 - 1.3 mm (.040" - .045") | Cored |
| PXKP1505-052C | 1.3 mm (.052") | Cored |
| PXKP1505-116C | 1.6 mm (1/16") | Cored |
| PXKP1505-068 | 1.7 - 1.8 mm (.068" - .072") | Cored & Solid |
| PXKP1505-564 | 2.0 mm (5/64") | Cored & Solid |
| PXKP1505-332 | 2.4 mm (3/32") | Cored & Solid |
| PXKP1505-764 | 2.8 mm (7/64") | Cored & Solid |
| PXKP1505-120 | 3.0 mm (.120") | Cored & Solid |

4 Roll Solid Drive Roll Kit



Contains 4 Drive Rolls and 1 Guide

| Part No. | Description | Pur. | Pk |
|---------------|---|------|----|
| PXKP1505-030S | 0.6 - 0.8 mm (.023" - .030") Solid drive roll | 1 | 1 |
| PXKP1505-035S | 0.9 mm (.035") Solid drive roll | 1 | 1 |
| PXKP1505-045S | 1.0 - 1.2 mm (.040" - .045") Solid drive roll | 1 | 1 |
| PXKP1505-052S | 1.3 mm (.052") Solid drive roll | 1 | 1 |
| PXKP1505-116S | 1.6 mm (1/16") Solid drive roll | 1 | 1 |

4 Roll Cored & Solid Drive Roll Kit



Contains 4 Drive Rolls and 1 Guide

| Part No. | Description | Pur. | Pk |
|--------------|--|------|----|
| PXKP1505-068 | 1.7 - 1.8 mm (.068" - .072") Cored & solid | 1 | 1 |
| PXKP1505-332 | 2.4 mm (3/32") Cored & solid drive roll | 1 | 1 |
| PXKP1505-564 | 2.0 mm (5/64") Cored & solid drive roll | 1 | 1 |
| PXKP1505-764 | 2.8 mm (7/64") Cored & solid drive roll | 1 | 1 |

4 Roll Cored Drive Roll Kit

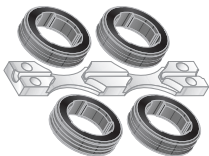

Contains 4 Drive Rolls and 1 Guide

| Part No. | Description | Pur. | Pk |
|---------------|---|------|----|
| PXKP1505-045C | 1.0 - 1.2 mm (.040" - .045") Cored drive roll | 1 | 1 |
| PXKP1505-116C | 1.6 mm (1/16") Cored drive roll | 1 | 1 |

MACHINE SPARE PARTS

Two Roll Kits

For LN-7 (K521), LN-7GMA (K440-2), LN-742 (K617-1), LN-742H (K617-2), *LN-9GMA (K424-1), *LN-9F GMA (K436), LN-22, LN-23P, (K316L-1) & LN-25 (K428 & K449)

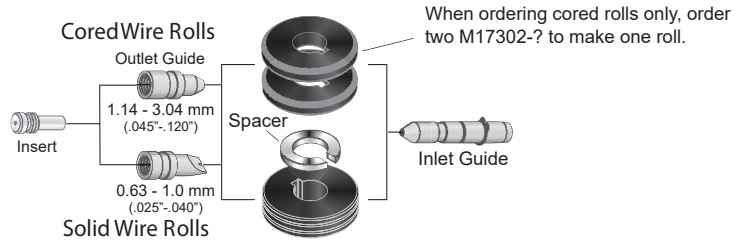

| Part No. | Wire Size | Wire Type | Drive Roll | Spacer | Inlet Guide | Outlet Guide | Outlet Guide Insert |
|--------------|------------------------------|---------------|--------------|----------|-------------|--------------|---------------------|
| PXKP653-025S | 0.6 mm (.023" - .025") | Solid | PXM17301-025 | PXT14984 | PXKP2139-1 | PXKP2125-1 | PXKP2124-1 |
| PXKP653-030S | 0.8 mm (.030") | Solid | PXM17301-030 | PXT14984 | PXKP2139-1 | PXKP2125-1 | PXKP2124-1 |
| PXKP653-035S | 0.9 - 1.0 mm (.035" - .040") | Solid | PXM17301-035 | PXT14984 | PXKP2139-3 | PXKP2125-1 | PXKP2124-1 |
| PXKP653-035C | 0.9 mm (.035") | Cored | PXM17302-035 | - | PXKP2139-3 | PXKP2125-1 | PXKP2124-1 |
| PXKP653-052S | 1.2 - 1.3 mm (.045" - .052") | Solid | PXM17301-052 | PXT14984 | PXKP2139-3 | PXKP1999-1 | PXKP2124-3 |
| PXKP653-052C | 1.2 - 1.3 mm (.045" - .052") | Cored | PXM17302-052 | - | PXKP2139-3 | PXKP1999-1 | PXKP2124-3 |
| PXKP653-116 | 1.3 - 1.6 mm (.052" - 1/16") | Cored & Solid | PXM17302-116 | - | PXKP2139-5 | PXKP2125-3 | PXKP2124-5 |
| PXKP653-332 | 1.7 - 2.4 mm (.068" - 3/32") | Cored & Solid | PXM17302-332 | - | PXKP2139-8 | PXKP2125-5 | PXKP2124-8 |
| PXKP653-120C | 2.8 - 3.0 mm (7/64" - .120") | Cored | PXM17302-120 | - | PXKP2139-7 | PXKP2125-4 | PXKP2124-7 |

Solid Drive Roll Kit

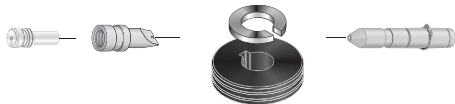

| Part No. | Description | Pur. | Pk |
|--------------|---|------|----|
| PXKP653-025S | 0.6 mm (.023" - .025") Solid drive roll | 1 | 1 |
| PXKP653-030S | 0.8 mm (.030") Solid drive roll | 1 | 1 |
| PXKP653-035S | 0.9 - 1.0 mm (.035" - .040") Solid drive roll | 1 | 1 |
| PXKP653-052S | 1.2 - 1.3 mm (.045" - .052") Solid drive roll | 1 | 1 |

Cored Drive Roll Kit

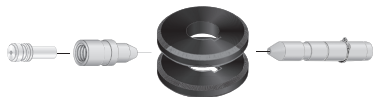

| Part No. | Description | Pur. | Pk |
|--------------|---|------|----|
| PXKP653-035C | 0.9 mm (.035") Cored drive roll | 1 | 1 |
| PXKP653-052C | 1.2 - 1.3 mm (.045" - .052") Cored drive roll | 1 | 1 |
| PXKP653-120C | 2.8 - 3.0 mm (7/64" - .120") Cored drive roll | 1 | 1 |

Solid & Cored Drive Roll Kit

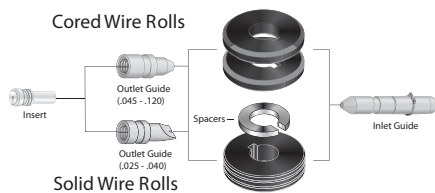

| Part No. | Description | Pur. | Pk |
|-------------|--|------|----|
| PXKP653-116 | 1.3 - 1.6 mm (.052" - 1/16") Cored & solid | 1 | 1 |
| PXKP653-332 | 1.7 - 2.4 mm (.068" - 3/32") Cored & solid | 1 | 1 |

Two Roll Kit Guides

| Part No. | Description | Pur. | Pk |
|------------|---------------------------|------|----|
| PXKP2139-1 | Inlet guide solid | 1 | 1 |
| PXKP2139-3 | Inlet guide cored & solid | 1 | 1 |
| PXKP2139-5 | Inlet guide cored & solid | 1 | 1 |
| PXKP2139-7 | Inlet guide cored | 1 | 1 |
| PXKP2139-8 | Inlet guide cored & solid | 1 | 1 |



| Part No. | Description | Pur. | Pk |
|--------------|----------------------------|------|----|
| 1 PXKP1999-1 | Outlet guide cored & solid | 1 | 1 |
| PXKP2125-3 | Outlet guide cored & solid | 1 | 1 |
| PXKP2125-4 | Outlet guide cored | 1 | 1 |
| PXKP2125-5 | Outlet guide cored & solid | 1 | 1 |
| 2 PXKP2125-1 | Outlet guide solid | 1 | 1 |

| Part No. | Description | Pur. | Pk |
|------------|-----------------------------------|------|----|
| PXKP2124-1 | Outlet guide insert solid | 1 | 1 |
| PXKP2124-3 | Outlet guide insert cored & solid | 1 | 1 |
| PXKP2124-5 | Outlet guide insert cored & solid | 1 | 1 |
| PXKP2124-7 | Outlet guide insert cored | 1 | 1 |
| PXKP2124-8 | Outlet guide insert cored & solid | 1 | 1 |

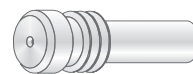

MACHINE SPARE PARTS

Four Roll Kits

For LN-7GMA (K567-2), LN-742 (K618-1), LN-742H (K618-2), *LN-9GMA (K568-2) & *LN-9F GMA (K583-2)

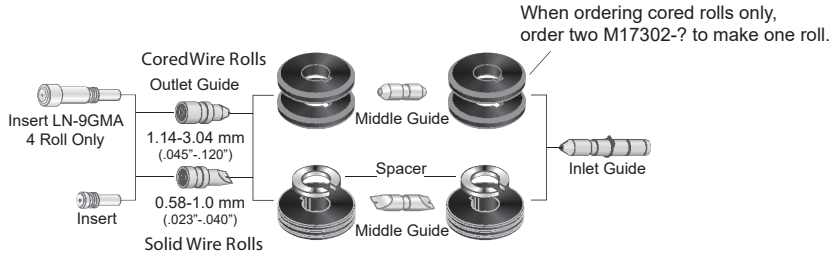

| Part No. | Wire Size | Wire Type | Drive Roll | Spacer | Inlet Guide | Middle Guide | Outlet Guide | Outlet Guide Insert | Outlet Guide Insert LN-9GMA |
|--------------|----------------------------|---------------|--------------|----------|---------------|--------------|--------------|---------------------|-----------------------------|
| PXKP655-025S | 0.6 mm (.023\"-.025\") | Solid | PXM17301-025 | PXT14984 | PXKP2139-1 | PXKP2114-1 | PXKP2125-1 | PXKP2124-1 | PXKP2124-2 |
| PXKP655-030S | 0.8 mm (.030\") | Solid | PXM17301-030 | PXT14984 | PXKP2139-1 | PXKP2114-1 | PXKP2125-1 | PXKP2124-1 | PXKP2124-2 |
| PXKP655-035S | 0.9-1.0 mm (.035\"-.040\") | Solid | PXM17301-035 | PXT14984 | PXKP2139-3 | PXKP2114-1 | PXKP2125-1 | PXKP2124-1 | PXKP2124-2 |
| PXKP655-035C | 0.9 mm (.035\") | Cored | PXM17302-035 | - | PXKP2139-3 | PXKP2114-1 | PXKP2125-1 | PXKP2124-1 | PXKP2124-2 |
| PXKP655-052S | 1.2-1.3 mm (.045\"-.052\") | Solid | PXM17301-052 | PXT14984 | PXKP2139-3 | PXKP2114-2 | PXKP1999-1 | PXKP2124-3 | PXKP2124-4 |
| PXKP655-052C | 1.2-1.3 mm (.045\"-.052\") | Cored | PXM17302-052 | - | PXKP2139-3 | PXKP2114-2 | PXKP1999-1 | PXKP2124-3 | PXKP2124-4 |
| PXKP655-116 | 1.3-1.6 mm (.052\"-1/16\") | Cored & solid | PXM17302-116 | - | PXKP2139-5 | PXKP2114-3 | PXKP2125-3 | PXKP2124-5 | PXKP2124-6 |
| PXKP655-332 | 1.7-2.4 mm (.068\"-3/32\") | Cored & solid | PXM17302-332 | - | PXKP2139-9 | PXKP2114-5 | PXKP2125-5 | PXKP2124-8 | PXKP2124-9 |
| PXKP655-120C | 2.8-3.0 mm (7/64\"-.120\") | Cored | PXM17302-120 | - | PXT13467-120F | PXKP2114-4 | PXKP2125-4 | PXKP2124-7 | PXKP2124-7 |

Solid Drive Roll Kit

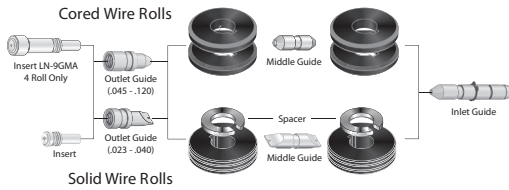

| Part No. | Description | Pur. | Pk |
|--------------|---|------|----|
| PXKP655-025S | 0.6 mm (.023\" - .025\") Solid drive roll kit | 1 | 1 |
| PXKP655-030S | 0.8 mm (.030\") Solid drive roll kit | 1 | 1 |
| PXKP655-035S | 0.9 - 1.0 mm (.035\" - .040\") Solid drive roll kit | 1 | 1 |
| PXKP655-052S | 1.2 - 1.3 mm (.045\" - .052\") Solid drive roll | 1 | 1 |

Cored Drive Roll Kit

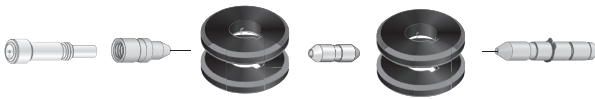

| Part No. | Description | Pur. | Pk |
|--------------|---|------|----|
| PXKP655-035C | 0.9 mm (.035\") Cored drive roll kit | 1 | 1 |
| PXKP655-052C | 1.2 - 1.3 mm (.045\" - .052\") Cored drive roll | 1 | 1 |

Solid & Cored Drive Roll Kit

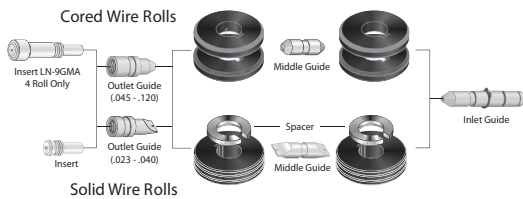

| Part No. | Description | Pur. | Pk |
|-------------|--|------|----|
| PXKP655-116 | 1.3 - 1.6 mm (.052\" - 1/16\") Cored & solid | 1 | 1 |
| PXKP655-332 | 1.7 - 2.4 mm (.068\" - 3/32\") Cored & solid | 1 | 1 |

Four Roll Kit Guides

| Part No. | Description | Pur. | Pk |
|---------------|---------------------------|------|----|
| PXT13467-120F | Inlet guide cored | 1 | 1 |
| PXKP2139-4 | Inlet guide cored & solid | 1 | 1 |
| PXKP2139-9 | Inlet guide cored & solid | 1 | 1 |

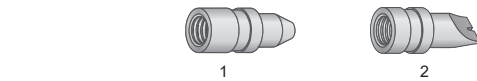

| Part No. | Description | Pur. | Pk |
|--------------|----------------------------|------|----|
| 1 PXKP1999-1 | Outlet guide cored & solid | 1 | 1 |
| PXKP2125-3 | Outlet guide cored & solid | 1 | 1 |
| PXKP2125-4 | Outlet guide cored | 1 | 1 |
| PXKP2125-5 | Outlet guide cored & solid | 1 | 1 |
| 2 PXKP2125-1 | Outlet guide cored & solid | 1 | 1 |



| Part No. | Description | Pur. | Pk |
|--------------|-----------------------------------|------|----|
| 1 PXKP2124-1 | Outlet guide insert cored & solid | 1 | 1 |
| PXKP2124-3 | Outlet guide insert cored & solid | 1 | 1 |
| PXKP2124-5 | Outlet guide insert cored & solid | 1 | 1 |
| PXKP2124-7 | Outlet guide insert cored | 1 | 1 |
| PXKP2124-8 | Outlet guide insert cored & solid | 1 | 1 |
| 2 PXKP2124-6 | Outlet guide insert LN-9GMA | 1 | 1 |



| Part No. | Description | Pur. | Pk |
|------------|----------------------------|------|----|
| PXKP2114-5 | Middle guide cored & solid | 1 | 1 |

MACHINE SPARE PARTS

Drive Roll Kits suits NA-3, NA-4 & NA-5 Sub-Arc Heads



| Part No. | Description | Pur. | Pk |
|------------|---|------|----|
| PXKP1899-1 | 2.4 - 5.5 mm (3/32" - 7/32") Cored & solid drive roll | 1 | 1 |



| Part No. | Description | Pur. | Pk |
|------------|---|------|----|
| PXKP1899-2 | 1.6, 2.0, 2.4 mm (1/16", 5/64", 3/32") Cored & solid drive roll | 1 | 1 |

Individual Drive Rolls and Guides suits NA-3, NA-4 & NA-5 Sub Arc Heads

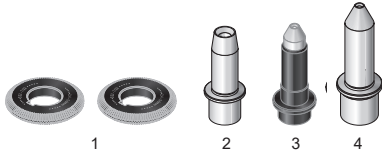

| Part No. | Description | Pur. | Pk |
|--------------|--|------|----|
| 1 PXKP1885-1 | 2.4 - 5.5 mm (3/32" - 7/32") Drive roll cored & solid | 1 | 1 |
| PXKP1886-1 | 1.6, 2.0, 2.4 mm (1/16", 5/64", 3/32") Drive roll cored & solid | 1 | 1 |
| 2 PXKP1963-1 | 2.4 - 5.5 mm (3/32" - 7/32") Outlet guide cored & solid | 1 | 1 |
| 3 PXKP2097-2 | 1.6, 2.0 & 2.4 mm (1/16", 5/64", 3/32") Outlet guide cored & solid | 1 | 1 |
| 4 PXKP2116-1 | 1.6, 2.0, 2.4 mm (1/16", 5/64", 3/32") Inlet guide cored & solid | 1 | 1 |

Drive Roll LT-7 Tractor Wire Drive Components

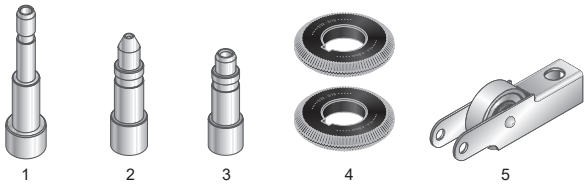

| Part No. | Description | Pur. | Pk |
|--------------|--|------|----|
| 1 PXKP1984-1 | 1.7 - 4.8 mm (.068"-3/16") Inlet guide cored & solid | 1 | 1 |
| 2 PXKP1985-1 | 2.4 - 4.8 mm (3/32"-3/16") Outlet guide cored & solid | 1 | 1 |
| 3 PXKP1985-2 | 1.7 - 2.4 mm (.068"-3/32") Outlet guide cored & solid | 1 | 1 |
| 4 PXKP2268-2 | 1.7 - 2.4 mm (.068"-3/32") Drive roll (2 required) cored & solid | 1 | 1 |
| PXKP2268-3 | 2.4 - 4.8 mm (3/32"-3/16") Drive roll (2 required) cored & solid | 1 | 1 |
| 5 PXS16666-1 | Pressure arm suits all wire sizes & types | 1 | 1 |

Brushes



| Part No. | Thick | Width | Length | Pur. | Pk |
|----------|----------------|----------------|----------------|------|----|
| 1 T12564 | 16 mm (5/8") | 38 mm (1 1/2") | 44 mm (1-3/4") | 8 | 8 |
| T2687 | 12.5 mm (1/2") | 38 mm (1 1/2") | 38 mm (1-1/2") | 8 | 8 |
| T344 | 16 mm (5/8") | 38 mm (1 1/2") | 44 mm (1-3/4") | 8 | 8 |
| T6085 | 16 mm (5/8") | 38 mm (1 1/2") | 44 mm (1-3/4") | 8 | 8 |
| 2 T6968 | 9.5 mm (3/8") | 16 mm (5/8") | 32 mm (1-1/4") | 12 | 12 |
| T7554 | 12.5 mm (1/2") | 16 mm (5/8") | 32 mm (1-1/4") | 12 | 12 |

Contactor

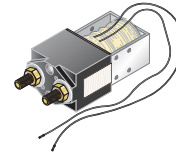

| Part No. | Description | Pur. | Pk |
|----------|---|------|----|
| PX6429 | 12 volt 250 amp Contactor for LN25 wire feeders | 1 | 1 |

MACHINE SPARE PARTS

Wire Straightener Spare Parts

For Part number WS-LN7, WS-LN89, WS-LSA, WS-LSAQ, WS-M.

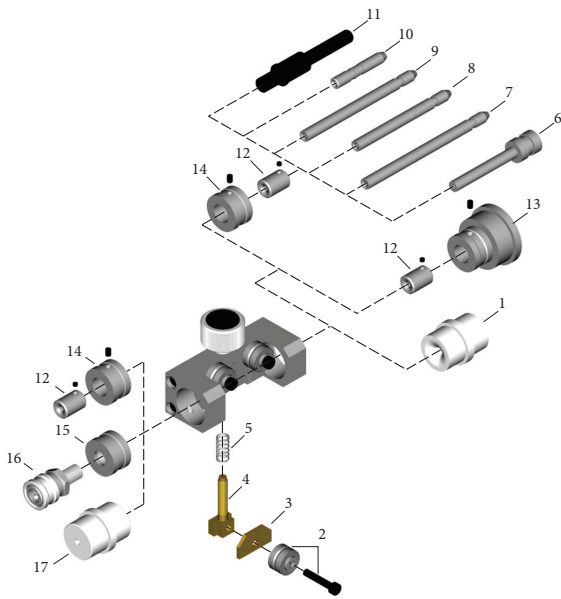

| Part No. | Description | Pur. | Pk |
|----------|--|------|----|
| 1 | A-1946 Guide, Lincoln DH-10, LN-10 & STT-10 (Also can be used to couple two straighteners) | 1 | 1 |
| 2 | A-1986 Kit roll (3 required) | 1 | 1 |
| 3 | A-1951 Plate, slide | 1 | 1 |
| 4 | A-1950 Slide | 1 | 1 |
| 5 | A-1952 Spring | 1 | 1 |
| 6 | 7290 Guide Lincoln LN-8 & LN-9 | 1 | 1 |
| 7 | 7291 Guide Lincoln LN-9-GMA | 1 | 1 |
| 8 | 7292 Guide Lincoln LN-7 / Miller 60 and 70 series feeders | 1 | 1 |
| 9 | 7293 Guide Lincoln LN-7-GMA | 1 | 1 |
| 10 | 150996 Guide Miller for all 10, 30 and 50 series feeders | 10 | 10 |
| 11 | 7296 Guide Miller RAD 400 & RAD 780 | 1 | 1 |
| 12 | PX045233 Insert antiwear | 1 | 1 |
| 13 | 7279 Bushing, Lincoln subarc | 1 | 1 |
| 14 | 7083 Bushing, standard | 1 | 1 |
| 15 | 7289 Bushing, 12.5 - 508 mm (1/2" - 20") | 1 | 1 |
| 16 | QCM Fitting, conduit quick connect, used w/ 7289 bushing | 1 | 1 |
| 17 | 7297 Guide outlet wire straightener WS-R | 1 | 1 |

Trigger Adaptor Cord



| Part No. | Description | Pur. | Pk |
|----------|--|------|----|
| PX202692 | Trigger adaptor Miller 4 pin and Lincoln 2 pin | 1 | 1 |

MACHINE SPARE PARTS

Finger Tip Control

Fingertip control with 8.2 m cord and 14 & 5 pin plug compatible with Tig machines effective with JK674521.



| Part No. | Description | Pur. | Pk |
|----------|--|------|----|
| MFTC14 | Finger tip control 8.2 m (27') cord and 14 pin plug | 1 | 1 |
| MFTC5 | Finger tip control 8.2 m (27') cord and 5 pin plug | 1 | 1 |
| TC-2B | Remote Fingertip control 8.2 m (27') and 14 pin plug | 1 | 1 |

Foot Control

All Metal Construction Operates contactor and controls output.

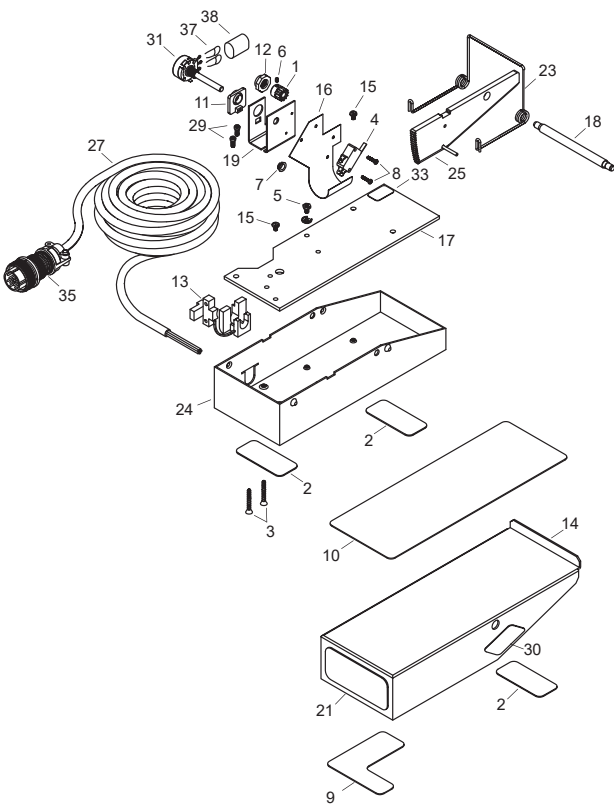

| Part No. | Description | Pur. | Pk |
|----------|--|------|----|
| MFC14 | Foot control with 7.6 m (25') cord & 14 pin plug | 1 | 1 |
| 1 | PX9340 Pinion gear | 1 | 1 |
| 2 | 9341 Rubber base pad | 1 | 1 |
| 3 | 9342 Screw #8-10 x 32 mm (1.250") | 10 | 10 |
| 4 | PX9343 Micro switch | 1 | 1 |
| 5 | 9344 Screw #8-32 x 7 mm (0.281") | 10 | 10 |
| 6 | 9345 Screw #6-32 x 5 mm (0.1875") | 10 | 10 |
| 7 | 9346 Nylon bearing | 1 | 1 |
| 8 | 9347 Screw #4-40 x 13 mm (0.500") | 10 | 10 |
| 9 | 9348 Rubber bumper pad | 1 | 1 |
| 10 | 9349 Rubber foot pad | 1 | 1 |
| 11 | 9350 Mount bracket | 1 | 1 |
| 12 | PX9351 Spacer nut | 1 | 1 |
| 13 | 9352 Cable clamp | 1 | 1 |
| 14 | 9353 Top cover | 1 | 1 |
| 15 | 9354 Screw #8-32 x 6.5 mm (0.250") | 10 | 10 |
| 16 | 9355 Insulation | 1 | 1 |
| 17 | 9356 Inner plate | 1 | 1 |
| 18 | 9357 Pivot rod assembly | 1 | 1 |
| 19 | 9358 Potentiometer bracket | 1 | 1 |
| 21 | 9359 Name plate MFC-14 | 1 | 1 |
| 23 | PX9361 Spring | 11 | 11 |
| 24 | 9362 Base | 1 | 1 |
| 25 | 9363 Spur gear leaver | 1 | 1 |
| 27 | 9364 7.6 m (25') Cored with 14 pin plug | 1 | 1 |
| 29 | 9366 Screw #8-32 x 9.5 mm (0.375") | 10 | 10 |
| 30 | 9367 Warning label | 1 | 1 |
| 31 | PX9369 Potentiometer 1K, 1T, 2W | 1 | 1 |
| 33 | 9370 Warning label | 1 | 1 |
| 35 | 136961 Miller® 14 pin plug only | 1 | 1 |
| 37 | 9371 Capacitor 4700VF, 3KV | 1 | 1 |
| 38 | 9372 Heat shrink tubing 6.35 mm (1 3/4") | 1 | 1 |

Extension Cord

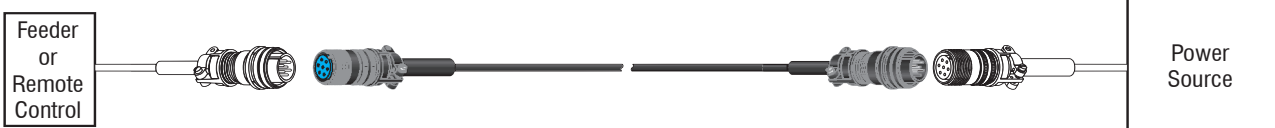

An extension cord extends the distance between equipment, allowing the equipment to be used at a further distance from the power source. The connectors will mate to each other.

| Part No. | Description | Pur. | Pk |
|----------|--|------|----|
| PX122973 | Extension cord 7.6 m (25') 14 pin to 14 socket 24 volt | 1 | 1 |
| PX122974 | Extension cord 15 m (50') 14 pin to 14 socket 24 volt | 1 | 1 |

MACHINE SPARE PARTS

Bridge Rectifier



| Part No. | Description | Pur. | Pk |
|----------|----------------------------------|------|----|
| PX035704 | Bridge rectifier 40 amp 800 volt | 1 | 1 |

Contactors

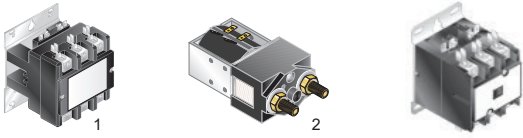

| Part No. | Description | Pur. | Pk |
|------------|---|------|----|
| 1 PX633U20 | Contactors 60 amp 110 volt - 120 volt | 1 | 1 |
| 730U20 | Contactors 75 amp 3 pole 110 - 120 volt | 1 | 1 |
| 2 PX6427 | Contactors 250 amp 12 volt | 1 | 1 |
| 3 PX438U10 | Contactors 40 amp 24 volt | 1 | 1 |

Diodes



| Part No. | Description | Pur. | Pk |
|----------|--|------|----|
| PX037956 | 275 amp 300 volt straight 19 mm (3/4") stud size | 1 | 1 |
| PX037957 | 275 amp 300 volt reverse 19 mm (3/4") stud size | 1 | 1 |
| SP200 | Diode straight polarity | 1 | 1 |

Meters

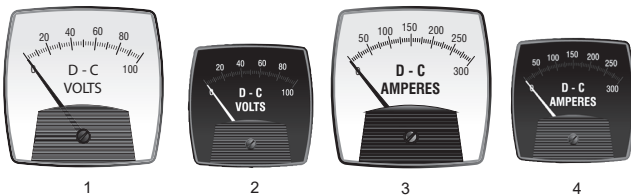

| Part No. | Description | Pur. | Pk |
|------------|-------------------------|------|----|
| 1 PX025604 | Voltmeter DC 0-100 volt | 1 | 1 |
| PX025632 | Voltmeter DC 0-50 volt | 1 | 1 |
| 2 PX118902 | Voltmeter DC 0-50 volt | 1 | 1 |
| PX119006 | Voltmeter DC 0-100 volt | 1 | 1 |
| 3 PX025603 | Ammeter DC 0-300 amps | 1 | 1 |
| PX025608 | Ammeter DC 0-500 amps | 1 | 1 |
| PX025610 | Ammeter DC 0-800 amps | 1 | 1 |
| 4 PX118899 | Ammeter DC 0-800 amps | 1 | 1 |
| PX118900 | Ammeter DC 0-600 amps | 1 | 1 |
| PX118901 | Ammeter DC 0-500 amps | 1 | 1 |
| PX119005 | Ammeter DC 0-400 amps | 1 | 1 |
| PX121207 | Ammeter DC 0-300 amps | 1 | 1 |

Plugs with Pins



| Part No. | Description | Pur. | Pk |
|------------|---------------------|------|----|
| 1 PX039273 | 5 Pin plug amphenol | 1 | 1 |
| 136961 | 14 Pin plug | 1 | 1 |
| PX217796 | 6 Pin plug | 1 | 1 |
| 2 PX079878 | 4 Pin trigger plug | 1 | 1 |

Plug Twistlock

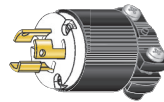

| Part No. | Description | Pur. | Pk |
|----------|-----------------------------|------|----|
| PX032898 | 3 Prong plug for MHC3GD-34A | 1 | 1 |
| PX039618 | 2 Prong twist lock plug | 1 | 1 |

Receptacle Twistlock

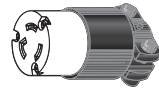

| Part No. | Description | Pur. | Pk |
|----------|-------------------------------|------|----|
| PX039635 | 2 Prong twist lock receptacle | 1 | 1 |

Receptacle with Sockets

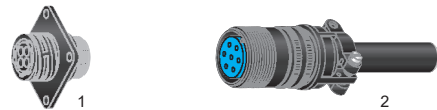

| Part No. | Description | Pur. | Pk |
|------------|-----------------------------------|------|----|
| 1 PX048282 | 4 Socket panel suits 079878 | 1 | 1 |
| 2 PX136960 | 14 Socket receptacle suits 136961 | 1 | 1 |

Receptacles with Pins



| Part No. | Description | Pur. | Pk |
|------------|-----------------------|------|----|
| 1 PX094480 | 14 Pin panel amphenol | 1 | 1 |
| 2 PX112296 | 14 Pin receptacle | 1 | 1 |

MACHINE SPARE PARTS

Rheostats



| Part No. | Description | Pur. | Pk |
|----------|------------------------------------|------|----|
| 1 | PX030-653 Rheostat 15 OHM 150 watt | 1 | 1 |
| 2 | PX205839 Rheostat 10 OHM 100 watt | 1 | 1 |
| 3 | PX207177 Rheostat 14 OHM 150 watt | 1 | 1 |
| 4 | PX605960 Rheostat 34 OHM 300 watt | 1 | 1 |

Remote Start Switch



| Part No. | Description | Pur. | Pk |
|-----------|--|------|----|
| PXRSCM-15 | Remote start switch 4.5 m (15') Miller | 1 | 1 |
| PXRSCM-25 | Remote start switch 7.6 m (25') Miller | 1 | 1 |

Remote Hand Control



Suits machines that have the 030653 or 222966 rheostat.
330, 340 & 360 ABP, DIALARC HF, MK VIII - 2, SRH222, 333, 444, 555 & 666.



Suits all machines that have 14 pin receptacle.
DIMENSION 302, NT450, 452, 652 & MK VI, SYNCROWAVE 200, 250DX, 350DX, 350LX, XMT 304, 350, 456, BIG 40C, BIG BLUE 400, 500, CST 280, DYNASTY 200, 350, 700, MAXSTAR 200, 350, 700, PIPE PRO 304, PIPEWORX, PRO 300, SHOPMATE 300, 300DX, TRAILBLAZER 275DC, 302.



Suits all engine drives NOT having the 14 pin receptacle.
BIG BLUE 250D, BIG BLUE 251D, BIG 40, BIG 40D, BIG BLUE 400D, BIG BLUE 400D AIR PAK, BIG BLUE 400CC, BIG BLUE 500CC.

| Part No. | Description | Pur. | Pk |
|----------|--|------|----|
| 1 | PXMHC3 Remote hand control without cord | 1 | 1 |
| | MHC-3-1 Remote hand control 0.3 m (1') cord | 1 | 1 |
| | MHC-3-25 Remote hand control 7.6 m (25') cord | 1 | 1 |
| | MHC-3-50 Remote hand control 15.2 m (50') cord | 1 | 1 |
| | MHC-3-100 Remote hand control 30.4 m (100') cord | 1 | 1 |
| 2 | PXMHC14 Remote hand control without cord | 1 | 1 |
| | MHC-14-1 Remote hand control 0.3 m (1') cord | 1 | 1 |
| | PXMHC14-25 Remote hand control 7.6 m (25') cord | 1 | 1 |

Terminals

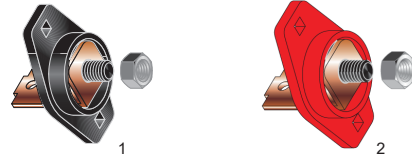

| Part No. | Description | Pur. | Pk |
|----------|--|------|----|
| 1 | PX039046 Power output with hex nut black | 1 | 1 |
| 2 | PX039047 Power output with hex nut red | 1 | 1 |

Trigger Adaptor Cord



| Part No. | Description | Pur. | Pk |
|----------|--|------|----|
| PX202692 | Trigger adaptor Miller 4 pin and Lincoln 2 pin | 1 | 1 |

MACHINE SPARE PARTS

Two Roll Kits Miller Wire Feeders

For the following miller wire feeders: 8VS, 12VS, Extreme 12VS, S22A, S22P, S32S S32P, S42GL, S52, D52, Millermatic 200, 250, 252, 250MP, 250X, 300 and Vintage, Portamig, Automatic Drives A1-2, A2-2 & A1D-2, SwingArc Single, Dual, SwingArc Digital 1 & 2. (D52, SwingArc Dual & SwingArc Digital 2 requires two kits).

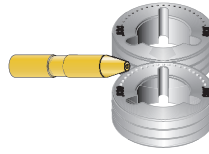

Optional anti-wear guide
part number PX045233

"V" Groove kits

| Wire Size | Kit Part No. | Kit Includes: Drive Roll | Kit Includes: Inlet Guide | Pur. | Pk |
|------------------------|--------------|-----------------------------|------------------------------|------|----|
| 0.6 mm (.023" - .025") | PX087131 | PX087130 | PX056192 | 1 | 1 |
| 0.8 mm (.030") | PX079594 | PX053695 | PX056192 | 1 | 1 |
| 0.9 mm (.035") | PX079595 | PX053700 | PX056192 | 1 | 1 |
| 1.0 mm (.040") | - | PX053696 | PX056193 | 1 | 1 |
| 1.2 mm (.045") | PX079596 | PX053697 | PX056193 | 1 | 1 |
| 1.3 mm (.052") | PX079597 | PX053698 | PX056193 | 1 | 1 |
| 1.6 mm (1/16") | PX079598 | PX053699 | PX056195 | 1 | 1 |

"U" Groove kits

| Wire Size | Kit Part No. | Kit Includes: Drive Roll | Kit Includes: Inlet Guide | Pur. | Pk |
|----------------|--------------|-----------------------------|------------------------------|------|----|
| 0.9 mm (.035") | PX044749 | PX072000 | PX056192 | 1 | 1 |
| 1.2 mm (.045") | PX079599 | PX053701 | PX056193 | 1 | 1 |
| 1.3 mm (.052") | PX079600 | PX053702 | PX056193 | 1 | 1 |
| 1.6 mm (1/16") | PX079601 | PX053706 | PX056195 | 1 | 1 |
| 2.0 mm (5/64") | PX079602 | PX053704 | PX056195 | 1 | 1 |
| 2.4 mm (3/32") | PX079603 | PX053703 | PX056196 | 1 | 1 |
| 2.8 mm (7/64") | PX079604 | PX053705 | PX056196 | 1 | 1 |

"V" Knurled groove kits

| Wire Size | Kit Part No. | Kit Includes: Drive Roll | Kit Includes: Inlet Guide | Pur. | Pk |
|------------------------------|--------------|-----------------------------|------------------------------|------|----|
| 0.9 mm (.035") | PX079606 | PX132958 | PX056192 | 1 | 1 |
| 1.2 mm (.045") | PX079607 | PX132957 | PX056193 | 1 | 1 |
| 1.3 mm (.052") | PX079608 | PX132956 | PX056193 | 1 | 1 |
| 1.6 mm (1/16") | PX079609 | PX132955 | PX056195 | 1 | 1 |
| 1.7 - 1.8 mm (.068" - .072") | PX089984 | PX132959 | PX056195 | 1 | 1 |
| 2.0 mm (5/64") | PX079610 | PX132960 | PX056195 | 1 | 1 |
| 2.4 mm (3/32") | PX079611 | PX132961 | PX056196 | 1 | 1 |
| 2.8 mm (7/64") | PX079612 | PX132962 | PX056196 | 1 | 1 |
| 3.2 mm (1/8") | PX079613 | PX132963 | PX056197 | 1 | 1 |

Guides



| Part No. | Description | Pur. | Pk |
|----------|--|------|----|
| PX056192 | Inlet guide 0.6 - .09 mm (.023" - .035") | 1 | 1 |
| PX056193 | Inlet guide 1.0 - 1.3 mm (.040" - .052") | 1 | 1 |
| PX056195 | Inlet guide 1.6 mm (1/16") | 1 | 1 |
| PX056196 | Inlet guide 2.4 - 2.8 mm (3/32" - 7/64") | 1 | 1 |

Guides



| Part No. | Description | Pur. | Pk |
|----------|-----------------|------|----|
| PX045233 | Anti-wear guide | 1 | 1 |

MACHINE SPARE PARTS

Four Roll Kits Miller Wire Feeders

For the following miller wire feeders: R115V, S44GL, S54A, S54D, S54E, S54M, D54A, D54D, D54M & Automatic Drives A1-4, A2-4 & A1D-4. (D54A D54D & D54M requires two kits).

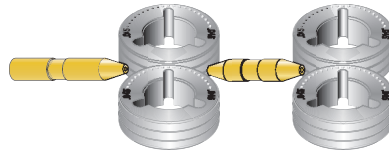

Optional anti-wear guide part number PX045233

"V" Groove kits

| Wire Size | Kit Part No. | Kit Includes: Drive Roll | Kit Includes: Inlet Guide | Kit Includes: Intermediate Guide | Pur. | Pk |
|------------------------|--------------|--------------------------|---------------------------|----------------------------------|------|----|
| 0.6 mm (.023" - .025") | PX087132 | PX087130 | PX056192 | PX056206 | 1 | 1 |
| 0.8 mm (.030") | PX046780 | PX053695 | PX056192 | PX056206 | 1 | 1 |
| 0.9 mm (.035") | PX046781 | PX053700 | PX056192 | PX056206 | 1 | 1 |
| 1.0 mm (.040") | - | PX053696 | PX056193 | PX056207 | 1 | 1 |
| 1.2 mm (.045") | PX046782 | PX053697 | PX056193 | PX056207 | 1 | 1 |
| 1.3 mm (.052") | PX046783 | PX053698 | PX056193 | PX056207 | 1 | 1 |
| 1.6 mm (1/16") | PX046784 | PX053699 | PX056195 | PX056209 | 1 | 1 |

"U" Groove kits

| Wire Size | Kit Part No. | Kit Includes: Drive Roll | Kit Includes: Inlet Guide | Kit Includes: Intermediate Guide | Pur. | Pk |
|----------------|--------------|--------------------------|---------------------------|----------------------------------|------|----|
| 0.9 mm (.035") | PX044750 | PX072000 | PX056192 | PX056206 | 1 | 1 |
| 1.3 mm (.052") | PX046786 | PX053702 | PX056193 | PX056207 | 1 | 1 |
| 1.6 mm (1/16") | PX046787 | PX053706 | PX056195 | PX056209 | 1 | 1 |
| 2.0 mm (5/64") | PX046788 | PX053704 | PX056195 | PX056209 | 1 | 1 |
| 2.4 mm (3/32") | PX046789 | PX053703 | PX056196 | PX056210 | 1 | 1 |
| 2.8 mm (7/64") | PX046790 | PX053705 | PX056196 | PX056210 | 1 | 1 |

"V" Knurled groove kits

| Wire Size | Kit Part No. | Kit Includes: Drive Roll | Kit Includes: Inlet Guide | Kit Includes: Intermediate Guide | Pur. | Pk |
|------------------------------|--------------|--------------------------|---------------------------|----------------------------------|------|----|
| 0.9 mm (.035") | PX046792 | PX132958 | PX056192 | PX056206 | 1 | 1 |
| 1.2 mm (.045") | PX046793 | PX132957 | PX056193 | PX056207 | 1 | 1 |
| 1.3 mm (.052") | PX046794 | PX132956 | PX056193 | PX056207 | 1 | 1 |
| 1.6 mm (1/16") | PX046795 | PX132955 | PX056195 | PX056209 | 1 | 1 |
| 1.7 - 1.8 mm (.068" - .072") | - | PX132959 | PX056195 | PX056209 | 1 | 1 |
| 2.0 mm (5/64") | PX046796 | PX132960 | PX056195 | PX056209 | 1 | 1 |
| 2.4 mm (3/32") | PX046797 | PX132961 | PX056196 | PX056210 | 1 | 1 |
| 2.8 mm (7/64") | PX046798 | PX132962 | PX056196 | PX056210 | 1 | 1 |
| 3.2 mm (1/8") | PX046799 | PX132963 | PX056197 | PX056211 | 1 | 1 |

Inlet Guides



| Part No. | Description | Pur. | Pk |
|----------|--|------|----|
| PX056192 | Inlet guide 0.6 - 0.9 mm (.023" - .035") | 1 | 1 |
| PX056193 | Inlet guide 1.0 - 1.3 mm (.040" - .052") | 1 | 1 |
| PX056195 | Inlet guide 1.6 mm (1/16") | 1 | 1 |
| PX056196 | Inlet guide 2.4 - 2.8 mm (3/32" - 7/64") | 1 | 1 |

Guides



1

2

| Part No. | Description | Pur. | Pk |
|------------|---|------|----|
| 1 PX056207 | Intermediate guide 1.0 - 1.3 mm (.040" - .052") | 1 | 1 |
| PX056210 | Intermediate guide 2.4 - 2.8 mm (3/32" - 7/64") | 1 | 1 |
| 2 PX045233 | Anti-wear guide | 1 | 1 |

MACHINE SPARE PARTS

Two Roll Kits Miller 62 Series Wire Feeders

For the following miller wire feeders: S62, S62D, and D62D requires one kit. D62 and D62D are dual feeders and requires two kits.

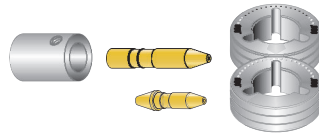

Optional anti-wear guide
part number PX221030

"V" Groove kits

| Wire Size | Kit Part No. | Kit Includes: Drive Roll | Kit Includes: Inlet Guide | Kit Includes: Intermediate Guide | Kit Includes: Anti-Wear Guide | Pur. | Pk |
|----------------------|--------------|-----------------------------|------------------------------|-------------------------------------|----------------------------------|------|----|
| 0.6 mm (.023"-.025") | PX151030 | PX087130 | PX150993 | PX149518 | PX045233 | 1 | 1 |
| 0.8 mm (.030") | PX151031 | PX053695 | PX150993 | PX149518 | PX045233 | 1 | 1 |
| 1.9 mm (.035") | PX151032 | PX053700 | PX150993 | PX149518 | PX045233 | 1 | 1 |
| 1.0 mm (.040") | PX161189 | PX053696 | PX150994 | PX149519 | PX045233 | 1 | 1 |
| 1.2 mm (.045") | PX151033 | PX053697 | PX150994 | PX149519 | PX045233 | 1 | 1 |
| 1.3 mm (.052") | PX151034 | PX053698 | PX150994 | PX149519 | PX045233 | 1 | 1 |
| 1.6 mm (1/16") | PX151035 | PX053699 | PX150995 | PX149520 | PX045233 | 1 | 1 |

"U" Groove kits

| Wire Size | Kit Part No. | Kit Includes: Drive Roll | Kit Includes: Inlet Guide | Kit Includes: Intermediate Guide | Kit Includes: Anti-Wear Guide | Pur. | Pk |
|----------------|--------------|-----------------------------|------------------------------|-------------------------------------|----------------------------------|------|----|
| 0.9 mm (.035") | PX151044 | PX072000 | PX150993 | PX149518 | PX045233 | 1 | 1 |
| 1.2 mm (.045") | PX151045 | PX053701 | PX150994 | PX149519 | PX045233 | 1 | 1 |
| 1.3 mm (.052") | PX151046 | PX053702 | PX150994 | PX149519 | PX045233 | 1 | 1 |
| 1.6 mm (1/16") | PX151047 | PX053706 | PX150995 | PX149520 | PX045233 | 1 | 1 |
| 2.0 mm (5/64") | PX151048 | PX053704 | PX150995 | PX149520 | PX045233 | 1 | 1 |
| 2.4 mm (3/32") | PX151049 | PX053703 | PX150996 | PX149521 | PX045233 | 1 | 1 |
| 2.8 mm (7/64") | PX151050 | PX053705 | PX150996 | PX149521 | PX045233 | 1 | 1 |

"V" Knurled groove kits

| Wire Size | Kit Part No. | Kit Includes: Drive Roll | Kit Includes: Inlet Guide | Kit Includes: Intermediate Guide | Kit Includes: Anti-Wear Guide | Pur. | Pk |
|------------------------------|--------------|-----------------------------|------------------------------|-------------------------------------|----------------------------------|------|----|
| 0.9 mm (.035") | PX151061 | PX132958 | PX150993 | PX149518 | PX045233 | 1 | 1 |
| 1.2 mm (.045") | PX151062 | PX132957 | PX150994 | PX149519 | PX045233 | 1 | 1 |
| 1.3 mm (.052") | PX151063 | PX132956 | PX150994 | PX149519 | PX045233 | 1 | 1 |
| 1.6 mm (1/16") | PX151064 | PX132955 | PX150995 | PX149520 | PX045233 | 1 | 1 |
| 1.7 - 1.8 mm (.068" - .072") | PX151065 | PX132959 | PX150995 | PX149520 | PX045233 | 1 | 1 |
| 2.0 mm (5/64") | PX151066 | PX132960 | PX150995 | PX149520 | PX045233 | 1 | 1 |
| 2.4 mm (3/32") | PX151067 | PX132961 | PX150996 | PX149521 | PX045233 | 1 | 1 |
| 2.8 mm (7/64") | PX151068 | PX132962 | PX150996 | PX149521 | PX045233 | 1 | 1 |
| 3.2 mm (1/8") | PX151069 | PX132963 | PX150997 | PX149522 | PX045233 | 1 | 1 |
| 4.0 mm (5/32") | - | PX193700 | - | - | - | 1 | 1 |

Guides

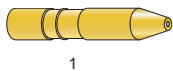

1



2

| Part No. | Description | Pur. | Pk |
|----------|---|------|----|
| 1 | PX150993 Inlet guide 0.6 - 1.0 mm (.023" - .040") | 1 | 1 |
| | PX150994 Inlet guide 1.2 - 1.3 mm (.045" - .052") | 1 | 1 |
| 2 | PX149518 Intermediate guides 0.6 - 0.9 mm (.023" - .035") | 1 | 1 |
| | PX149520 Intermediate guides 1.6 mm (1/16") | 1 | 1 |
| | PX149521 Intermediate guides 2.4 - 2.8 mm (3/32" - 7/64") | 1 | 1 |

Guides

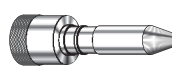

1



2

| Part No. | Description | Pur. | Pk |
|----------|--------------------------|------|----|
| 1 | PX221030 Anti-wear guide | 1 | 1 |
| 2 | PX045233 Anti-wear guide | 1 | 1 |

MACHINE SPARE PARTS

Four Roll Kits Miller 64 & 74 Series Wire Feeders

For the following miller wire feeders: S64, S64D, S64M, SS64M, SS12, SS16, SS12D, SS16D, S74S, S74D, S74DX, SS74D12, SS74D16 requires one kit. D60M, DS60M, D64, D64D, Swing Arc DS12, DS16, DS16D, D74S, D74D, D74DX, DS74D-12, DS74D-16 are dual feeders and requires two kit.

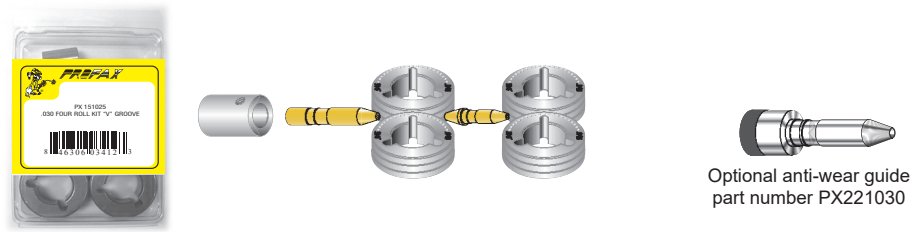

"V" Groove kits

| Wire Size | Kit Part No. | Kit Includes: Drive Roll | Kit Includes: Inlet Guide | Kit Includes: Intermediate Guide | Kit Includes: Anti-Wear Guide | Pur. | Pk |
|------------------------|--------------|-----------------------------|------------------------------|-------------------------------------|----------------------------------|------|----|
| 0.6 mm (.023" - .025") | PX151024 | PX087130 | PX150993 | PX149518 | PX045233 | 1 | 1 |
| 0.8 mm (.030") | PX151025 | PX053695 | PX150993 | PX149518 | PX045233 | 1 | 1 |
| 0.9 mm (.035") | PX151026 | PX053700 | PX150993 | PX149518 | PX045233 | 1 | 1 |
| 1.0 mm (.040") | PX161190 | PX053696 | PX150994 | PX149519 | PX045233 | 1 | 1 |
| 1.2 mm (.045") | PX151027 | PX053697 | PX150994 | PX149519 | PX045233 | 1 | 1 |
| 1.3 mm (.052") | PX151028 | PX053698 | PX150994 | PX149519 | PX045233 | 1 | 1 |
| 1.6 mm (1/16") | PX151029 | PX053699 | PX150995 | PX149520 | PX045233 | 1 | 1 |

"U" Groove kits

| Wire Size | Kit Part No. | Kit Includes: Drive Roll | Kit Includes: Inlet Guide | Kit Includes: Intermediate Guide | Kit Includes: Anti-Wear Guide | Pur. | Pk |
|----------------|--------------|-----------------------------|------------------------------|-------------------------------------|----------------------------------|------|----|
| 0.9 mm (.035") | PX151036 | PX072000 | PX150993 | PX149518 | PX045233 | 1 | 1 |
| 1.2 mm (.045") | PX151037 | PX053701 | PX150994 | PX149519 | PX045233 | 1 | 1 |
| 1.3 mm (.052") | PX151038 | PX053702 | PX150994 | PX149519 | PX045233 | 1 | 1 |
| 1.6 mm (1/16") | PX151039 | PX053706 | PX150995 | PX149520 | PX045233 | 1 | 1 |
| 2.0 mm (5/64") | PX151040 | PX053704 | PX150995 | PX149520 | PX045233 | 1 | 1 |
| 2.4 mm (3/32") | PX151041 | PX053703 | PX150996 | PX149521 | PX045233 | 1 | 1 |
| 2.8 mm (7/64") | PX151042 | PX053705 | PX150996 | PX149521 | PX045233 | 1 | 1 |

"V" Knurled groove kits

| Wire Size | Kit Part No. | Kit Includes: Drive Roll | Kit Includes: Inlet Guide | Kit Includes: Intermediate Guide | Kit Includes: Anti-Wear Guide | Pur. | Pk |
|------------------------------|--------------|-----------------------------|------------------------------|-------------------------------------|----------------------------------|------|----|
| 0.9 mm (.035") | PX151052 | PX132958 | PX150993 | PX149518 | PX045233 | 1 | 1 |
| 1.2 mm (.045") | PX151053 | PX132957 | PX150994 | PX149519 | PX045233 | 1 | 1 |
| 1.3 mm (.052") | PX151054 | PX132956 | PX150994 | PX149519 | PX045233 | 1 | 1 |
| 1.6 mm (1/16") | PX151055 | PX132955 | PX150995 | PX149520 | PX045233 | 1 | 1 |
| 1.7 - 1.8 mm (.068" - .072") | PX151056 | PX132959 | PX150995 | PX149520 | PX045233 | 1 | 1 |
| 2.0 mm (5/64") | PX151057 | PX132960 | PX150995 | PX149520 | PX045233 | 1 | 1 |
| 2.4 mm (3/32") | PX151058 | PX132961 | PX150996 | PX149521 | PX045233 | 1 | 1 |
| 2.8 mm (7/64") | PX151059 | PX132962 | PX150996 | PX149521 | PX045233 | 1 | 1 |
| 3.2 mm (1/8") | PX151060 | PX132963 | PX150997 | PX149522 | PX045233 | 1 | 1 |
| 4.0 mm (5/32") | - | PX193700 | - | - | - | 1 | 1 |

Guides



| Part No. | Description | Pur. | Pk |
|------------|--|------|----|
| 1 PX150993 | Inlet guide 0.6 - 1.0 mm (.023" - .040") | 1 | 1 |
| PX150994 | Inlet guide 1.2 - 1.3 mm (.045" - .052") | 1 | 1 |
| 2 PX149518 | Intermediate guides 0.6 - 0.9 mm (.023" - .035") | 1 | 1 |
| PX149520 | Intermediate guides 1.6 mm (1/16") | 1 | 1 |
| PX149521 | Intermediate guides 2.4 - 2.8 mm (3/32" - 7/64") | 1 | 1 |

Guides



| Part No. | Description | Pur. | Pk |
|------------|-----------------|------|----|
| 1 PX221030 | Anti-wear guide | 1 | 1 |
| 2 PX045233 | Anti-wear guide | 1 | 1 |

MACHINE SPARE PARTS

TR1500-2 Turning Roll

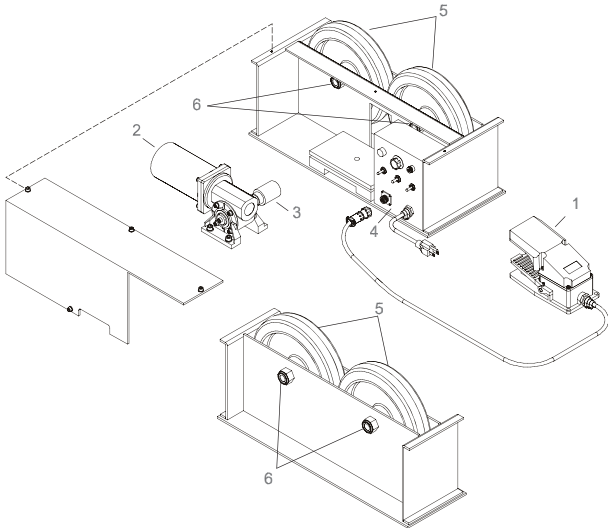

| Part No. | Description | Pur. | Pk | |
|----------|-------------|------------------|----|---|
| 1 | CFS-302 | Foot control | 1 | 1 |
| 2 | PX9920 | Motor & gear box | 1 | 1 |
| 3 | PX9921 | Friction roll | 1 | 1 |
| 4 | PX9912 | Control unit | 1 | 1 |
| 5 | PX9922 | Roller wheel | 1 | 1 |
| 6 | PX9923 | Axle | 1 | 1 |

MACHINE SPARE PARTS

Drive 2 Roll Assembly Breakdown Figure A

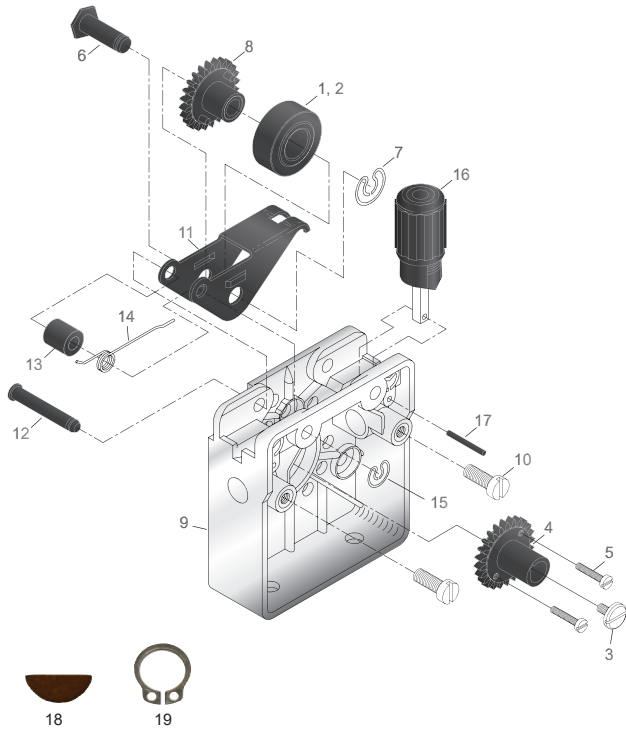

| Part No. | Description | Pur. | Pk |
|----------|---|------|----|
| PX9004 | PRO II wire drive 2 roll assembly | 1 | 1 |
| 1 | PX9052 Pressure roll, flat smooth | 1 | 1 |
| 2 | PX9053 Pressure roll, knurled (optional) | 1 | 1 |
| 3 | PX9126 Screw, drive gear retention | 1 | 1 |
| 4 | PX9129 Gear, drive | 1 | 1 |
| 5 | PX9130 Screw, drive roll retention | 1 | 1 |
| 6 | PX9134 Axle, pressure roll | 1 | 1 |
| 7 | PX9135 Circle clip, pressure roll axle | 1 | 1 |
| 8 | PX9136 Gear, pressure roll | 1 | 1 |
| 9 | PX9143 Wire drive housing | 1 | 1 |
| 10 | PX9144 Screw, guide retention, and motor mounting | 1 | 1 |
| 11 | PX9145 Pressure arm | 1 | 1 |
| 12 | PX9146 Pivot pin, pressure arm | 1 | 1 |
| 13 | PX9147 Spacer | 1 | 1 |
| 14 | PX9148 Spring, lift | 1 | 1 |
| 15 | PX9149 Circle clip, pressure arm pivot pin | 1 | 1 |
| 16 | PX9150 Tension adjuster | 1 | 1 |
| 17 | PX9151 Retaining pin, tension adjuster | 1 | 1 |
| 18 | PX9128 Key, motor shaft | 1 | 1 |
| 19 | PX9152 Snap ring, motor shaft | 1 | 1 |

Drive 4 Roll Assembly Breakdown Figure B

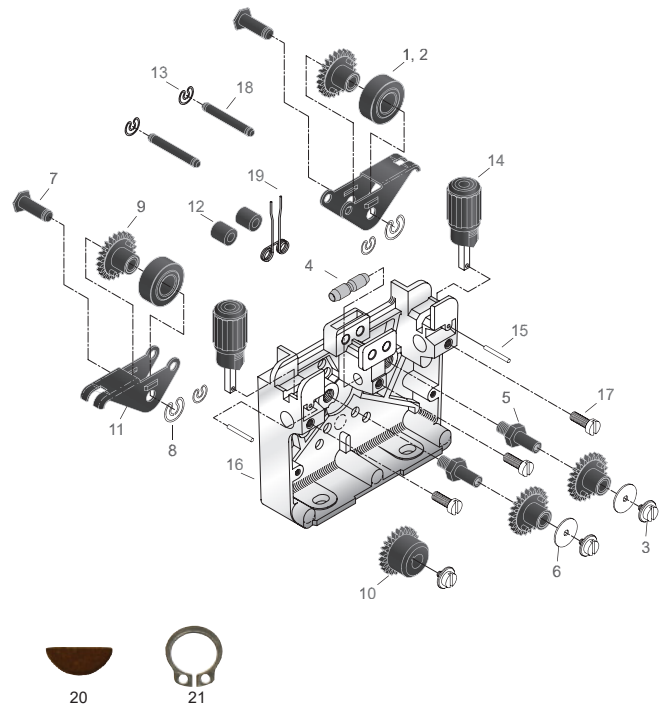

| Part No. | Description | Pur. | Pk |
|----------|--|------|-----|
| PX9005 | PRO IV wire drive 4 roll assembly | 1 | 1 |
| 1 | PX9052 Pressure roll, flat smooth | 1 | 1 |
| 2 | PX9053 Pressure roll, knurled (optional) | 1 | 1 |
| 3 | PX9127 Screw, gear retention | 1 | 1 |
| 4 | PX9131 Intermediate guide | 1 | 1 |
| 5 | PX9132 Axle, drive roll | 1 | 1 |
| 6 | PX9133 Washer, drive roll retention | 1 | 1 |
| 7 | PX9134 Axle, pressure roll | 1 | 1 |
| 8 | PX9135 Circle clip, pressure roll axle | 1 | 1 |
| 9 | PX9136 Gear, feed and pressure roll | 1 | 1 |
| 10 | PX9137 Gear main drive | 1 | 1 |
| 11 | PX9145 Pressure arm | 1 | 1 |
| 12 | PX9147 Spacer | 1 | 1 |
| 13 | PX9149 Circle clip, pressure arm pivot pin | 1 | 1 |
| 14 | PX9150 Tension adjuster | 1 | 1 |
| 15 | PX9151 Retaining pin, tension adjuster | 1 | 1 |
| 16 | PX9153 Wire drive housing | TBC | TBC |
| 17 | PX9154 Screw, guide retention | 1 | 1 |
| 18 | PX9155 Pivot pin, pressure arms | 1 | 1 |
| 19 | PX9156 Spring, lift | 1 | 1 |
| 20 | PX9128 Key motor shaft | 1 | 1 |
| 21 | PX9152 Snap ring, motor shaft | 1 | 1 |

MACHINE SPARE PARTS

PRO II & PRO IV Wire Feeder Breakdown

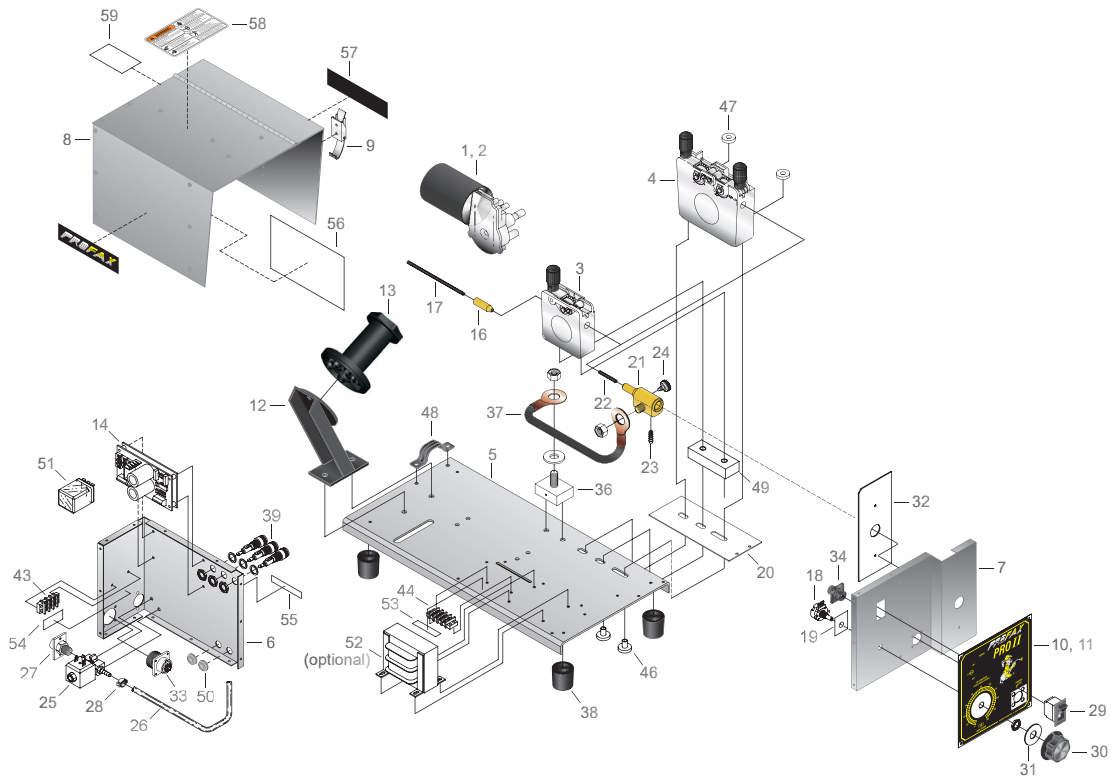

| Part No. | Description | PRO II | PRO IV | Pur. | Pk |
|----------|---|--------|--------|------|-----|
| 1 | PX9002 Motor 24VDC 160 RPM | ✓ | | 1 | 1 |
| 2 | PX9003 Motor 24VDC 160 RPM | | ✓ | 1 | 1 |
| 3 | PX9004 Wire drive assy 2 roll | ✓ | | 1 | 1 |
| 4 | PX9005 Wire drive assy. 4 roll | | ✓ | 1 | 1 |
| 5 | PX9012 Base | ✓ | ✓ | 1 | 1 |
| 6 | PX9014 Divider panel | ✓ | ✓ | 1 | 1 |
| 7 | PX9016 Front panel | ✓ | ✓ | 1 | 1 |
| 8 | PX9013 Hinged cover | ✓ | ✓ | 1 | 1 |
| 9 | PX9015 Cover hasp | ✓ | ✓ | 1 | 1 |
| 10 | PX9019 Faceplate | ✓ | | 1 | 1 |
| 11 | PX9139 Faceplate | | ✓ | 1 | 1 |
| 12 | PX9018 Spool support | ✓ | ✓ | 1 | 1 |
| 13 | PX9017 Spindle assy | ✓ | ✓ | 1 | 1 |
| 14 | PX9001 PC Board | ✓ | ✓ | 1 | 1 |
| n/s | PX8999 Terminal tool PC board | ✓ | ✓ | 1 | 1 |
| 16 | PX9007 Inlet guide holder | ✓ | ✓ | 1 | 1 |
| 17 | Inlet guide liner (see PRO II & PRO IV drive roll kits & parts page) | ✓ | ✓ | TBC | TBC |
| 18 | PX9028 Potentiometer 10K, 1T, 2W | ✓ | ✓ | 1 | 1 |
| 19 | PX9029 Insulator, potentiometer | ✓ | ✓ | 1 | 1 |
| 20 | PX9008 Drive mount insulator | ✓ | ✓ | 1 | 1 |
| 21 | PX9006 Adaptor block | ✓ | ✓ | 1 | 1 |
| 22 | Liner, adaptor block (see PRO II & PRO IV drive roll kits & parts page) | ✓ | ✓ | TBC | TBC |
| 23 | PX9170 Nipple, adaptor block | ✓ | ✓ | 1 | 1 |
| 24 | PX9171 Thumb screw, adaptor block | ✓ | ✓ | 5 | 5 |
| 25 | PX9020 Gas solenoid 24VAC | ✓ | ✓ | 5 | 5 |
| 26 | PX9172 Hose, gas solenoid | ✓ | ✓ | 1 | 1 |
| 27 | PX9069 Fitting, gas solenoid inlet | ✓ | ✓ | 1 | 1 |
| 28 | PX9273 Clamp, gas solenoid hose | ✓ | ✓ | 10 | 10 |

| Part No. | Description | PRO II | PRO IV | Pur. | Pk |
|----------|-------------------------------------|--------|--------|------|-----|
| 29 | PX9022 Power switch | ✓ | ✓ | 1 | 1 |
| 30 | PX9030 Knob potentiometer | ✓ | ✓ | 1 | 1 |
| 31 | PX9031 Brake felt | ✓ | ✓ | 1 | 1 |
| 32 | PX9032 Outlet insulator | ✓ | ✓ | 1 | 1 |
| 33 | PX9033 Power receptacle amphenol | ✓ | ✓ | 1 | 1 |
| 34 | PX048282 Trigger receptacle amp | ✓ | ✓ | 1 | 1 |
| n/s | PX9035 Terminal trigger receptacle | ✓ | ✓ | TBC | TBC |
| 36 | PX9010 Power block | ✓ | ✓ | 1 | 1 |
| 37 | PX9011 Power cable | ✓ | ✓ | 1 | 1 |
| 38 | PX9024 Foot, rubber | ✓ | ✓ | 1 | 1 |
| 39 | PX6100 Fuse holder | ✓ | ✓ | 1 | 1 |
| n/s | PX9038 Fuse 7 amp 250 volt | ✓ | ✓ | 1 | 1 |
| n/s | PX9039 Fuse 7 amp 250 volt SLO-BO | ✓ | ✓ | 1 | 1 |
| n/s | PX9040 Fuse 3 amp 250 volt SLO-BO | ✓ | ✓ | 1 | 1 |
| 43 | PX9041 Terminal strip 3 pole | ✓ | ✓ | 1 | 1 |
| 44 | PX9042 Terminal strip 4 pole | ✓ | ✓ | 1 | 1 |
| n/s | PX9043 Jumper terminal strip | ✓ | ✓ | 1 | 1 |
| 46 | PX9025 Screw insulator wire drive | ✓ | ✓ | 1 | 1 |
| 47 | PX9026 Insulating washer wire drive | | ✓ | 1 | 1 |
| 48 | PX9009 Clamp, cable | ✓ | ✓ | 1 | 1 |
| 49 | PX9023 Spacer, block | ✓ | | 1 | 1 |
| 50 | PX9027 Grommet, rubber | ✓ | ✓ | 1 | 1 |
| 51 | PX9044 Relay 24VAC 3PDT | ✓ | ✓ | 1 | 1 |
| 52 | PX9045 Transformer (optional) | ✓ | ✓ | 1 | 1 |
| 53 | PX9047 Label TS2 | ✓ | ✓ | 1 | 1 |
| 54 | PX9048 Label TS1 | ✓ | ✓ | 1 | 1 |
| 55 | PX9049 Label fuses | ✓ | ✓ | 1 | 1 |
| 56 | PX9051 Label schematic | ✓ | ✓ | 1 | 1 |
| 57 | PX9142 Label Profax | ✓ | ✓ | 1 | 1 |
| 58 | PX9036 Label safety | ✓ | ✓ | 1 | 1 |
| 59 | PX9177 Top cover insulator | | ✓ | 1 | 1 |

MACHINE SPARE PARTS

Drive Roll Kits



Standard Series PRO II



PRO IV

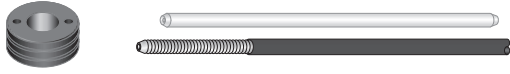

Euro-Quick Series PRO IIX



Euro-Quick Series PRO IVX

V-Groove for hard wires

| Wire Size | Pro II Kit No. | Pro IV Kit No. | Type | Drive Roll | Inlet Guide | Std. Outlet Guide | Euro Outlet Guide | Inter. Guide |
|------------------------|----------------|----------------|------|------------|-------------|-------------------|-------------------|--------------|
| 0.6 mm (.023" - .025") | PX9095 | PX9110 | V | PX9054 | PX9070 | PX9080 | PX9085X | PX9131 |
| 0.8 mm (.030") | PX9095 | PX9110 | V | PX9054 | PX9070 | PX9080 | PX9085X | PX9131 |
| 0.9 mm (.035") | PX9096 | PX9111 | V | PX9055 | PX9071 | PX9081 | PX9086X | PX9131 |
| 1.2 mm (.045") | PX9097 | PX9112 | V | PX9056 | PX9071 | PX9081 | PX9086X | PX9131 |

V-Knurled for cored wires

| Wire Size | Pro II Kit No. | Pro IV Kit No. | Type | Drive Roll | Inlet Guide | Std. Outlet Guide | Euro Outlet Guide | Inter. Guide |
|----------------|----------------|----------------|------|------------|-------------|-------------------|-------------------|--------------|
| 0.8 mm (.030") | PX9098 | PX9113 | VK | PX9057 | PX9070 | PX9080 | PX9085X | PX9131 |
| 1.2 mm (.045") | PX9100 | PX9115 | VK | PX9058 | PX9071 | PX9081 | PX9086X | PX9131 |
| 1.4 mm (.052") | PX9101 | PX9116 | VK | PX9059 | PX9072 | PX9082 | PX9087X | PX9131 |
| 1.6 mm (1/16") | PX9101 | PX9116 | VK | PX9059 | PX9072 | PX9082 | PX9087X | PX9131 |

V Groove Drive Roll Kits



| Part No. | Description | Pur. | Pk |
|----------|-------------------------------|------|----|
| PX9095 | 0.6 mm (.023"/.025") V Groove | 1 | 1 |
| PX9096 | 0.9 mm (.035") V Groove | 1 | 1 |
| PX9097 | 1.2 mm (.045") V Groove | 1 | 1 |

V Knurled Drive Roll Kits



| Part No. | Description | Pur. | Pk |
|----------|--|------|----|
| PX9113 | 0.8 mm (.030") V Knurled | 1 | 1 |
| PX9115 | 1.2 mm (.045") V Knurled | 1 | 1 |
| PX9116 | 1.4 - 1.6 mm (.052" - 1/16") V Knurled | 1 | 1 |

V Groove Drive Roll Kits



| Part No. | Description | Pur. | Pk |
|----------|-------------------------------|------|----|
| PX9110 | 0.6 mm (.023"/.025") V Groove | 1 | 1 |
| PX9111 | 0.9 mm (.035") V Groove | 1 | 1 |
| PX9112 | 1.2 mm (.045") V Groove | 1 | 1 |

U Groove Drive Roll Kits



| Part No. | Description | Pur. | Pk |
|----------|---------------------------------------|------|----|
| PX9103 | 0.9 - 1.2 mm (.035" - .045") U Groove | 1 | 1 |
| PX9104 | 1.0 - 1.2 mm (.040" - .045") U Groove | 1 | 1 |

V Knurled Drive Roll Kits



| Part No. | Description | Pur. | Pk |
|----------|--|------|----|
| PX9098 | 0.8 mm (.030") V Knurled | 1 | 1 |
| PX9100 | 1.2 mm (.045") V Knurled | 1 | 1 |
| PX9101 | 1.4 - 1.6 mm (.052" - 1/16") V Knurled | 1 | 1 |

MACHINE SPARE PARTS

PROTIG II & IV



| Part No. | Description | Pur. | Pk |
|----------|---|------|----|
| 1 | PX407839-3 0.8 mm (.030") Tapered | 25 | 25 |
| | PX407839-6 0.9 mm (.035") Tapered | 25 | 25 |
| | PX407839-9 1.2 mm (.045") Tapered | 25 | 25 |
| | PX407839-12 1.6 mm (1/16") Tapered | 25 | 25 |
| 2 | PXFP-8 Feed pen assembly 2.4 m (8') long | 1 | 1 |
| 3 | PX9072 For PX9101 & PX9106 Drive roll kit | 1 | 1 |
| 4 | PX9081 0.9 - 1.2 mm (.035" - .045"), 1.0 - 1.2 mm (.035" - .045") U Groove for PX9103, PX9104, PX9114, PX9100, PX9115, PX9097, PX9112 | 1 | 1 |
| 5 | PX9491 Liner (for all wire sizes) | 1 | 1 |
| 6 | PX9002 Motor suits PRO 2 feeder | 1 | 1 |
| | PX9003 Motor suits PRO 4 feeder | 1 | 1 |
| 8 | PX9001 PC board for PRO 2 & 4 feeder | 1 | 1 |
| 9 | PX9052 Smooth | 1 | 1 |
| | PX9053 Flat knurled | 1 | 1 |
| 10 | PX9127 PRO IV retaining screw | 1 | 1 |
| 11 | PX9043 Jumper terminal strip | 1 | 1 |
| 12 | PX9045 115/24 VAC 100VA | 1 | 1 |

NERTAJET Machine



| Part No. | Description | Pur. | Pk |
|----------|-------------------------------------|------|----|
| 1 | W000147969 Board for Nertajet | 1 | 1 |
| 2 | W000352073 Guide block fixing | 1 | 1 |
| 3 | AFSAFU0.9-1.2 U Groove 0.9 - 1.2 mm | 1 | 1 |

DIGIPULS III



| Part No. | Description | Pur. | Pk |
|----------|---|------|----|
| 1 | W000260185 Drive roll aluminium 1.0 - 1.2 mm (.040" - .045") U Groove | 1 | 1 |
| 2 | W000279646 Gear roller aluminium 1 mm (.040") top pairs with W000260185 | 1 | 1 |
| 3 | W000279647 Gear roller aluminium 1.2 mm (.045") top pairs with W000260185 | 1 | 1 |

MACHINE SPARE PARTS

Water Recirculator TM115WC & TM240WC



| Part No. | Description | Pur. | Pk |
|----------|-------------|----------------------------------|-----|
| 1 | 16-25501 | Coolant fluid 3.7 litre | 1 1 |
| 2 | C0900 | Radiator coil unit | 1 1 |
| 3 | C1000 | Sheet metal screw | 1 1 |
| 4 | C1001 | Hex bolt | 1 1 |
| 5 | C1003 | Washer | 1 1 |
| 6 | C1004 | Nut | 1 1 |
| 7 | C1005 | Adaptor water 5/8 inch LH female | 1 1 |
| 8 | C11969 | Gear pump repair kit | 1 1 |
| 9 | C102RP-V | Repl vane pump kit | 1 1 |
| 10 | C1500 | Fill port assembly | 1 1 |
| 11 | C1501 | Cap filter port | 1 1 |
| 12 | C3000 | Electric motor no cord | 1 1 |
| 13 | C3075 | Cooler fan | 1 1 |

Double Sided Beveling SMDBM50



| Part No. | Description | Pur. | Pk |
|----------|-------------|-----------------------------|-------|
| 1 | SMDBM501945 | Coated inserts (Pack of 10) | 10 10 |
| 2 | SMDBM501946 | Milling head | 1 1 |
| 3 | SMDBM501947 | Milling head insert screw | 1 1 |
| 4 | SMDBM501948 | In-feed wheel | 1 1 |
| 5 | SMDBM505007 | Toothed belt | 1 1 |

Weld Gas Analysers



| Part No. | Description | Pur. | Pk |
|----------|-------------|---|-----|
| 1 | TMSWGA | Replacement sensor argon suits TMGA0001 | 1 1 |
| 2 | TMRH001 | Rubber hose 2 m | 1 1 |

* Picture is for reference only